

- LEGEND**
- NTS NOT TO SCALE
  - EP EXISTING IRON PIPE
  - PP POWER POLE
  - WM WATER METER
  - TB TELEPHONE BOX
  - IPS IRON PIPE SET
  - CP&L CABLE TV BOX
  - L POLE LIGHT POLE
  - DHPL OVERHEAD POWER LINE
  - F.I.S. FLAGGED END SECTION (PP/CP)
  - RCP REINFORCED CONC. PIPE
  - B.O.C. BACK OF CURB
  - F.H. FIRE HYDRANT
  - C.V.O. SEWER CLEAN OUT
  - E.S. EXISTING IRON STAKE
  - M.H. MANHOLE
  - ECM EXISTING CONCRETE MONUMENT
  - P.K. PARKER KALON NAIL

**HARNETT COUNTY  
MINIMUM BUILDING  
SETBACK REQUIREMENTS**

- FRONT: 35' FROM R/W
- REAR: 25'
- SIDE: 10'
- CORNER LOT SIDE: 20'

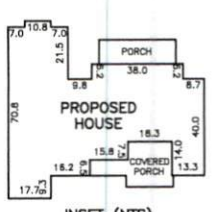

**NOTES:**

- (A) THE PROPERTY SHOWN HEREON IS SUBJECT TO ALL ENCUMBRANCES OF RECORD AFFECTING SAME.
- (B) NO TITLE SEARCH HAS BEEN PERFORMED BY THIS FIRM DURING THE COURSE OF THIS SURVEY.
- (C) THIS SURVEYOR DOES NOT CERTIFY TO THE EXISTENCE OR NON-EXISTENCE OF ANY UNDERGROUND UTILITIES THAT MAY OR MAY NOT BE PRESENT ON THIS SITE.

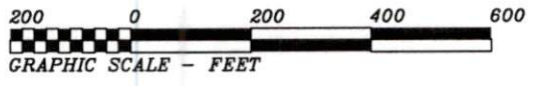

NOTE: SHOWN IS PARENT TRACT RECORDED IN M.B.2020, PG.390  
REF: PC# F, SLIDE 614B  
M.B.2020, PG.390

AREA = 21.60 ACRES  
473 FRED BURNS ROAD

THIS IS TO CERTIFY THAT THIS MAP WAS PREPARED FROM AN ACTUAL SURVEY OF THE PREMISES, MADE UNDER MY SUPERVISION, AND THAT THERE ARE NOT ANY ENCROACHMENTS, EXCEPT AS NOTED TO THE BEST OF MY KNOWLEDGE, THAT THE RATIO OF PRECISION AS CALCULATED BY LATITUDES AND DEPARTURES IS 1:10,000. THIS MAP WAS PREPARED FOR TITLE COMPANY USE AND IS NOT INTENDED FOR RECORDATION OR CONVEYANCES WITHOUT WRITTEN AUTHORIZATION OF THE SURVEYOR AND OTHER APPROPRIATE OFFICIALS.

PROFESSIONAL LAND SURVEYOR  
L-3247

**FRED BURNS ROAD  
(80' PUBLIC R/W - SR 1451)**



Course	Bearing	Distance
E1	N 75°57'27" E	150.75'
E2	N 03°56'32" W	286.66'
E3	N 19°41'37" W	171.10'
E4	N 26°32'21" E	167.80'
E5	S 80°57'21" E	50.17'
E6	S 04°11'45" W	5.65'
E7	S 26°32'21" W	156.32'
E8	S 19°41'37" E	156.68'
E9	S 03°56'32" E	335.46'
E10	S 75°57'27" W	221.52'
E11	N 15°58'50" E	57.75'

Course	Bearing	Distance
L1	S 80°49'01" E	106.38'
L2	N 04°15'01" E	28.30'
L3	S 79°58'50" E	49.87'
L4	S 04°11'45" W	30.00'
L5	S 66°45'54" E	110.85'
L6	S 83°08'56" E	139.38'
L7	N 88°53'54" W	101.16'

LEWIS H. WALKER  
MYRA F. WALKER  
D.B.847, PG.749  
PC#C, SLIDE 178D

ANDREW C. JONES  
BRITTANY T. JONES  
D.B.3916, PG.338  
M.B.2020, PG.390

MAE OMIE MOSELY  
PHILLIP MOSELY  
D.B.256, PG.413

HOBBY FARMS LLC  
D.B.1459, PG.510  
M.B.98, PG.444

JONATHAN M. JOHNSON  
YVONNE M. JOHNSON  
D.B.3035, PG.182



PRELIMINARY PLAT  
NOT FOR RECORDATION

PRELIMINARY PLOT PLAN FOR:  
**ALBERT ALMANZA  
ELIZABETH ALMANZA**

BUCKHORN TWP., HARNETT CO., N.C.  
SCALE 1" = 200' MARCH 13, 2023

MAULDIN - WATKINS SURVEYING, P.A.  
P.O. BOX 444 / 139 N. MAIN ST.  
FUQUAY VARINA, NORTH CAROLINA 27526  
(919) 552-9326 C-929 4697PPBIG