

GENERAL FOUNDATION NOTES:

1. THIS PLAN DESIGNED IN ACCORDANCE WITH THE NORTH CAROLINA RESIDENTIAL BUILDING CODE, 2018 EDITION.
2. EXTERIOR WALL FOOTING TO BE A MINIMUM OF 16" WIDE AND CONSTRUCTED WITH 3000 PSI CONCRETE. FOR FOUNDATION WALL HEIGHT, THICKNESS AND BACKFILL REQUIREMENTS REFER TO STATE AND LOCAL BUILDING CODES. THE ASSUMED SOIL BEARING CAPACITY FOR THIS PROJECT IS 2000 PSF. THE CONTRACTOR MUST VERIFY THE SITE CONDITIONS AND CONTACT A SOILS ENGINEER IF MARGINAL OR UNSTABLE SOILS ARE ENCOUNTERED.
3. ALL FOOTINGS SHALL BEAR ON UNDISTURBED SUB-GRADE A MINIMUM OF 12" BELOW ADJACENT FINISHED GRADE OR AS OTHERWISE DIRECTED BY THE LOCAL INSPECTOR.
4. FOUNDATION DRAINAGE SHALL BE IN ACCORDANCE WITH SECTION R405 "FOUNDATION DRAINAGE" AND SECTION R406 "FOUNDATION WATERPROOFING AND DAMPPROOFING".
5. ANCHOR BOLTS SHALL BE 1/2" DIAMETER AND INSTALLED 12" ON CENTER AND 12" FROM EACH CORNER OR SILL PLATE SPICE LOCATIONS.

STRUCTURAL EVALUATION BY:

WILKINS ENGINEERING, P.C.
Post Office Box 37446
Raleigh, North Carolina 27627

FILE: ALICE HOLLEMAN

*THE ENGINEER'S SEAL AND SIGNATURE APPLY ONLY TO THE STRUCTURAL ELEMENTS OF THIS DOCUMENT. ENGINEER'S APPROVAL DOES NOT INCLUDE CONSTRUCTION REVIEW MEANS, METHODS, TECHNIQUES OR SEQUENCES OF CONSTRUCTION OR SAFETY REQUIREMENTS. THE CONTRACTOR IS REQUIRED TO ENSURE PROPER SAFETY PRECAUTIONS.
*ANY DEVIATIONS OR DISCREPANCIES IN THESE DRAWINGS ARE TO BE BROUGHT TO THE IMMEDIATE ATTENTION OF THE ENGINEER AND FAILURE TO DO SO WILL VOID THE ENGINEER'S LIABILITY. CHANGES TO THE DESIGN ARE ONLY ALLOWED WITH THE WRITTEN APPROVAL OF THE ENGINEER.
*DO NOT SCALE THESE DRAWINGS. ENGINEERING APPROVAL EXPIRES ONE YEAR FROM DATE OF ENGINEER'S SIGNATURE.

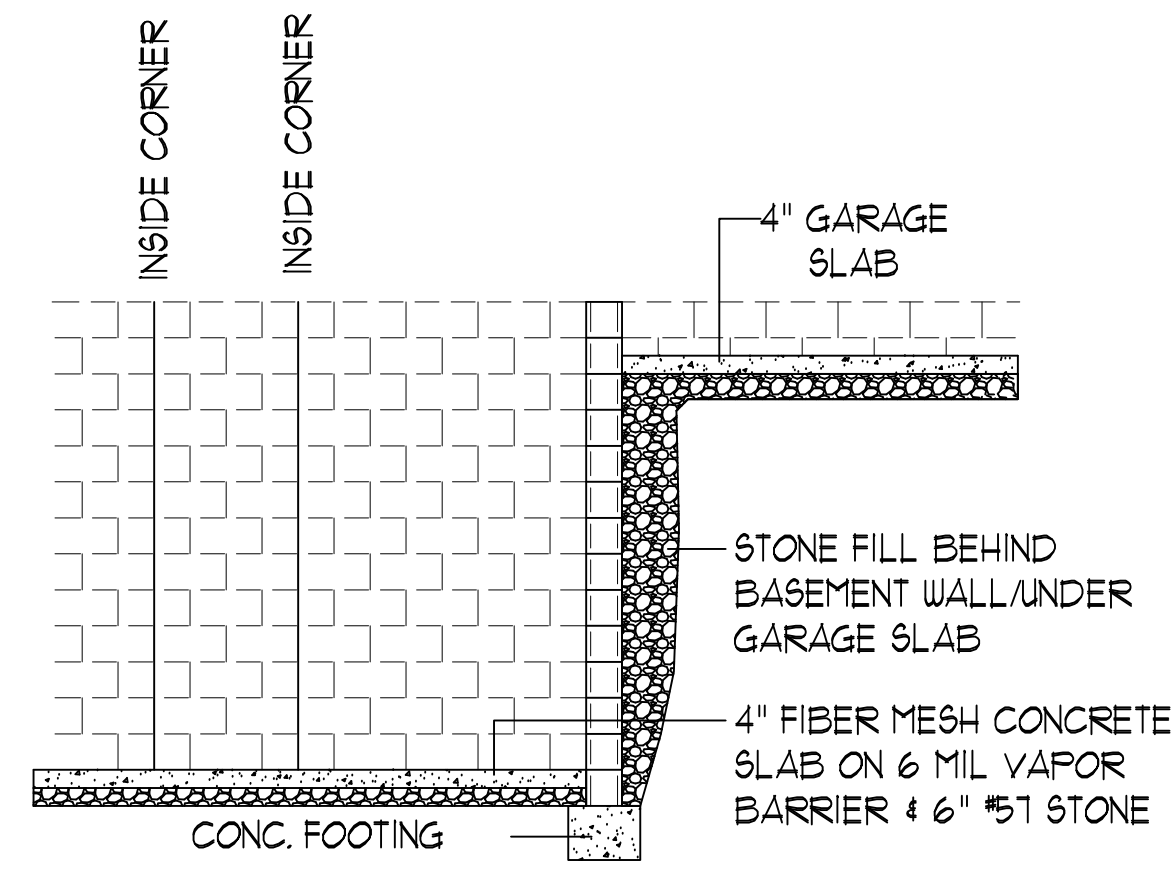

WALL SECTION B-B
Scale: N.T.S.

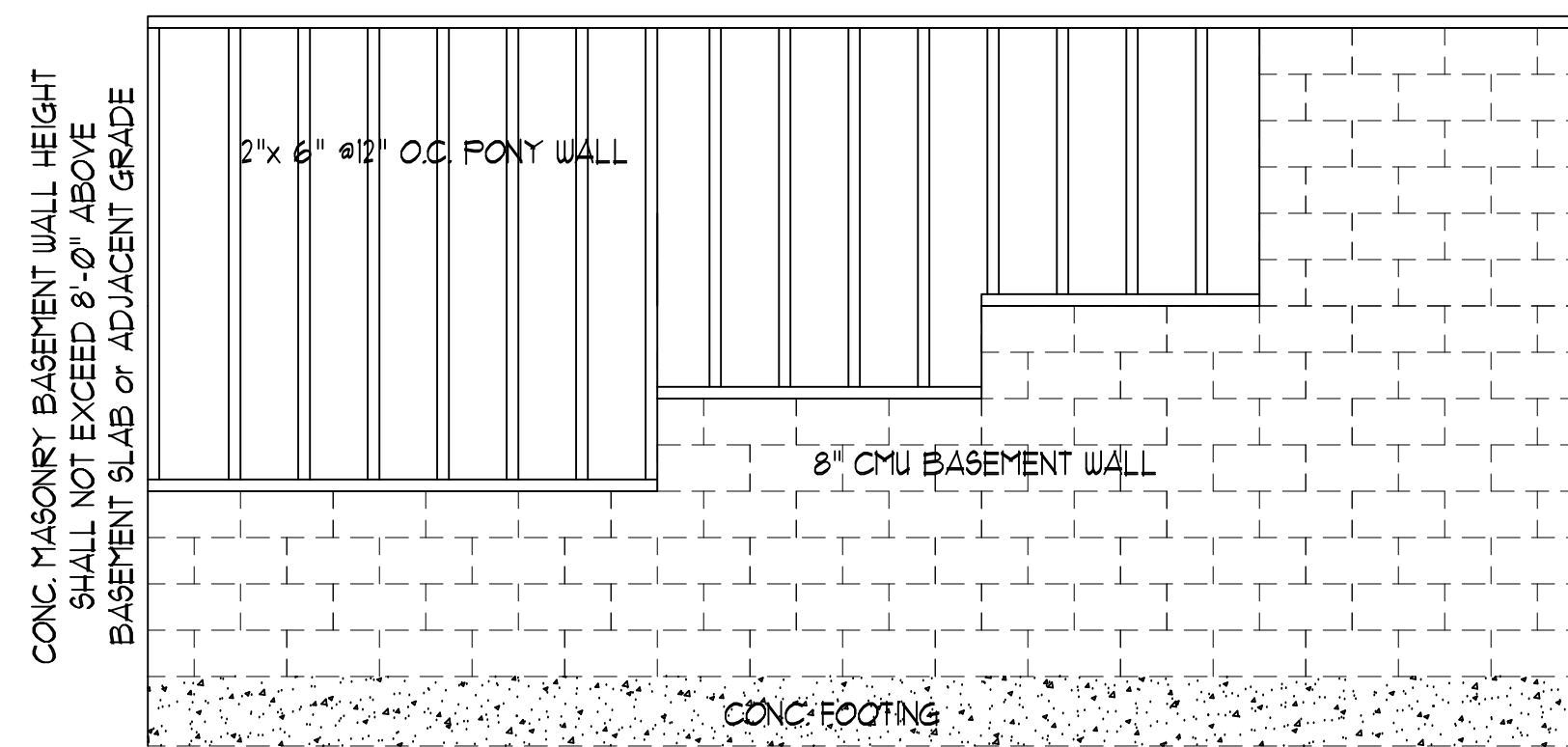

WALL SECTION A-A
Scale: N.T.S.

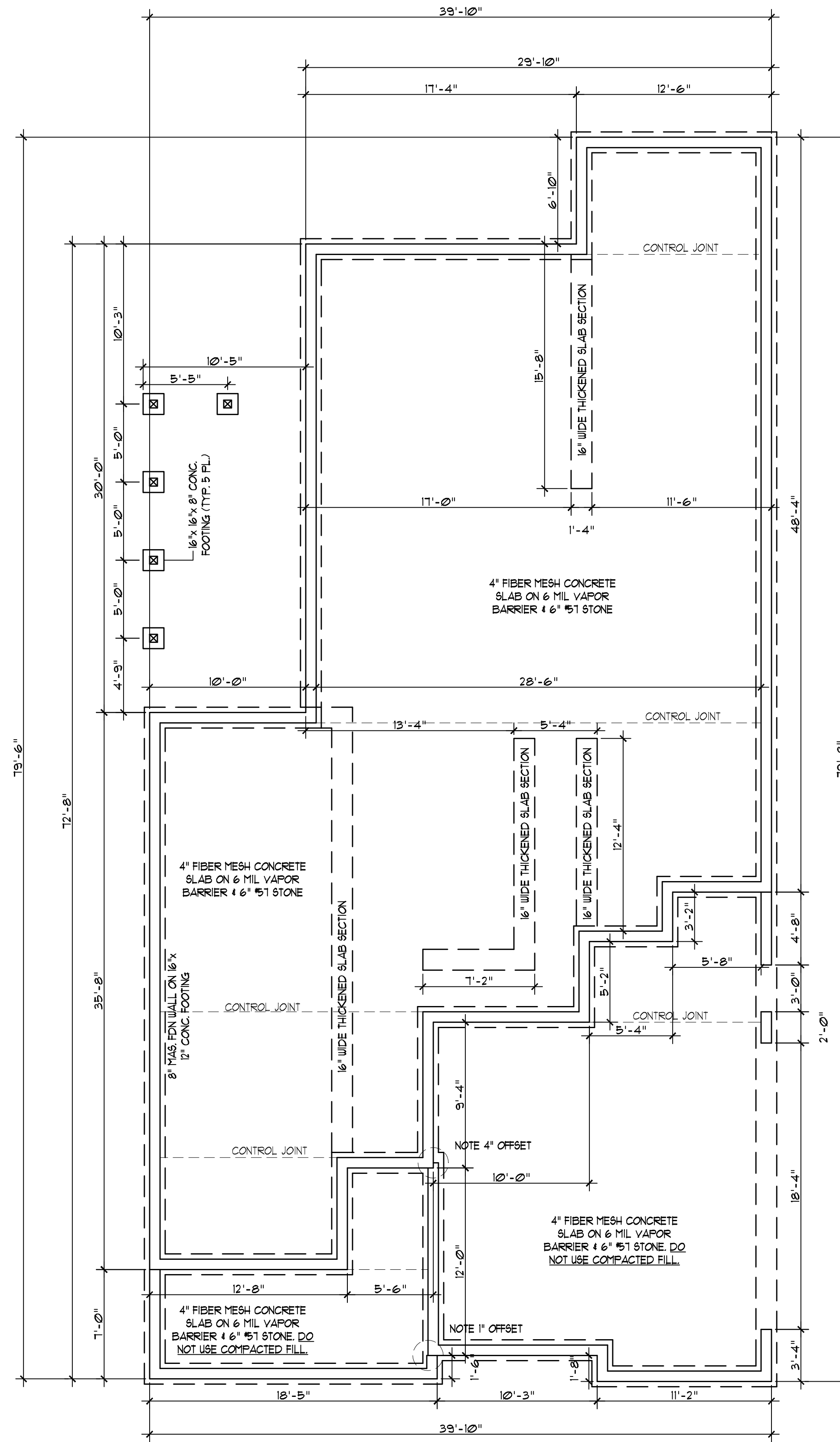

FOUNDATION PLAN-BASEMENT
Scale: 1/4" = 1'-0"

DO NOT SCALE THESE DRAWINGS
ALL DIMENSIONS AND SITE DIMENSIONS ARE TO BE VERIFIED BEFORE CONSTRUCTION BEGINS. SHOULD THE CONTRACTOR DISCOVER ANY DISCREPANCIES, THE CONTRACTOR SHALL NOTIFY THE ENGINEER IMMEDIATELY. THESE DRAWINGS APPLY TO STRUCTURAL ELEMENTS ONLY. THE ENGINEER ASSUMES NO RESPONSIBILITY FOR CODE COMPLIANCE OF NON-STRUCTURAL ITEMS.

COPYRIGHT 2020 WILKINS ENGINEERING, P.C.
THESE DRAWINGS ARE PROTECTED UNDER FEDERAL COPYRIGHT LAWS. THE ORIGINAL PURCHASER OR CONTRACTOR SHALL BE RESPONSIBLE FOR THE PROTECTION OF THESE DRAWINGS. NO REPRODUCTION, MODIFICATION, OR DISTRIBUTION OF THESE DRAWINGS IS PERMITTED WITHOUT THE WRITTEN CONSENT OF THE ENGINEER. ANY VIOLATION IS EXPRESSLY PROHIBITED.

WILKINS ENGINEERING
Post Office Box 37446
Raleigh, NC 27627
wilkinsengr@aol.com
919.772.3540

145 ALICE HOLLEMAN
FUGUAY VARINA, N.C.

Sheet No.

51