

4-Bedroom Septic Plan
 Lot #13 – Duncan’s Crossing
 Harnett County
 Smith Douglas Homes

13

31,274 SF
 (0.72 AC)

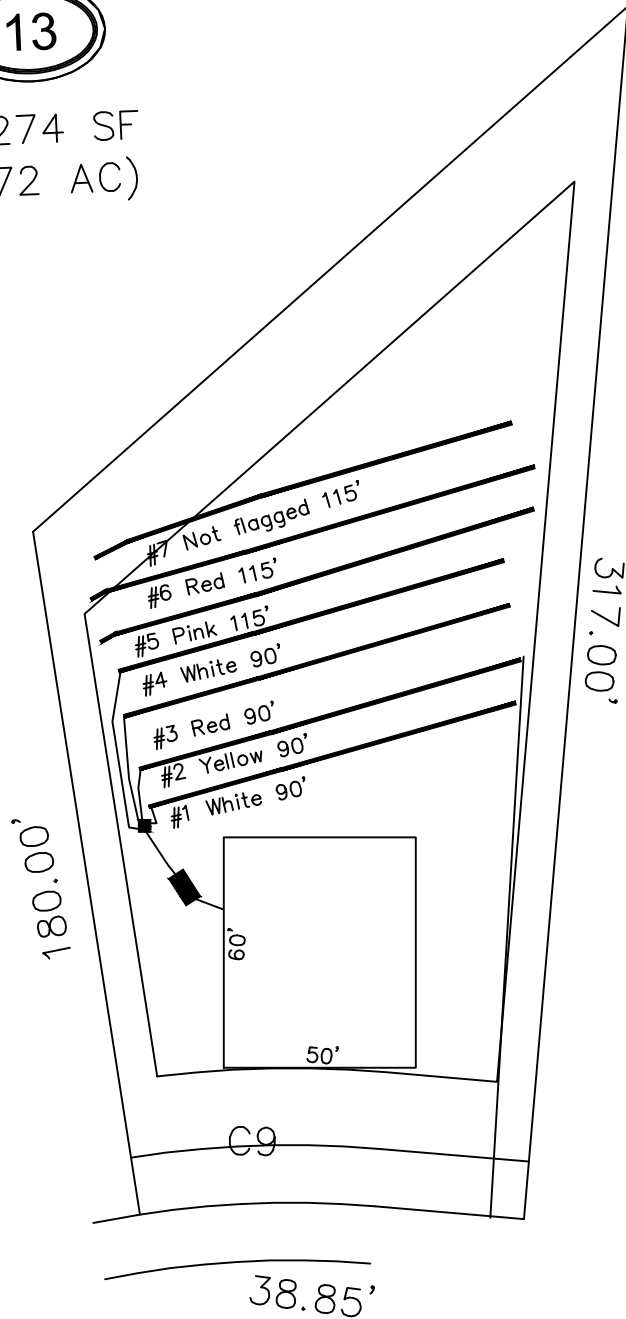

*House footprint to be field staked by surveyor and system verified prior to any construction

**Septic area must not be altered by construction activities.

***No cuts of 2' or greater within 15' of septic area

**** Recommend protective barrier around septic field during construction.

*If plumbing is not sufficient a pump tank will be required to septic field.

System: Gravity to D-Box
 Lines: Lines 1-4 (360')
 0.35 LTAR
 24" Max Trench Bottom
 Accepted Status System
 Repair: Gravity to D-Box
 Lines: Lines 5-7 (345')
 0.35 LTAR
 24" Trench Bottom
 Accepted Status System

CLYDE DOG COURT

50' R/W (PUBLIC & UTILITY ACCESS)

GRAPHIC SCALE
 1" = 50'



Adams
 Soil Consulting
 919-414-6761
 Job #1146