

# Harnett County Department of Public Health Improvement Permit

A building permit cannot be issued with only an Improvement Permit

PROPERTY LOCATION: 4071 Barbecue Church Rd

ISSUED TO: Weaver Homes

SUBDIVISION \_\_\_\_\_

LOT # 2

NEW  REPAIR  EXPANSION

Site Improvements required prior to Construction Authorization Issuance: \_\_\_\_\_

Type of Structure: SFD(34'x48')

Proposed Wastewater System Type: Pump to Chamber

Projected Daily Flow: 360 GPD

Number of bedrooms: 3 Number of Occupants: 6 max

Basement  Yes  No

Pump Required:  Yes  No  May be required based on final location and elevations of facilities

Type of Water Supply:  Community  Public  Well Distance from well \_\_\_\_\_ feet

Permit valid for:  Five years

Permit conditions: \_\_\_\_\_

No expiration

Authorized State Agent: [Signature]

Date: 9/21/23

SEE ATTACHED SITE SKETCH

The issuance of this permit by the Health Department in no way guarantees the issuance of other permits. The permit holder is responsible for checking with appropriate governing bodies in meeting their requirements. This site is subject to revocation if the site plan, plat, or the intended use changes. The Improvement Permit shall not be affected by a change in ownership of the site. This permit is subject to compliance with the provisions of the Laws and Rules for Sewage Treatment and Disposal and to conditions of this permit.

## Construction Authorization

(Required for Building Permit)

The construction and installation requirements of Rules .1950, .1952, .1954, .1955, .1956, .1957, .1958, and .1959 are incorporated by references into this permit and shall be met. Systems shall be installed in accordance with the attached system layout.

ISSUED TO: Weaver Homes

PROPERTY LOCATION: 4071 Barbecue Church Rd

SUBDIVISION \_\_\_\_\_

LOT # 2

Facility Type: SFD(34'x48')  New  Expansion  Repair

Basement?  Yes  No Basement Fixtures?  Yes  No

Type of Wastewater System\*\* Pump to Chamber (Initial) Wastewater Flow: 360 GPD

(See note below, if applicable )

Pump to Chamber (Repair)

Installation Requirements/Conditions

Septic Tank Size \_\_\_\_\_ gallons

Number of trenches \_\_\_\_\_

Exact length of each trench \_\_\_\_\_ feet

Trench Spacing: \_\_\_\_\_ Feet on Center

Pump Tank Size \_\_\_\_\_ gallons

Trenches shall be installed on contour at a

Soil Cover: \_\_\_\_\_ inches

Maximum Trench Depth of: \_\_\_\_\_ inches

(Maximum soil cover shall not exceed

(Trench bottoms shall be level to +/-1/4"

36" above the trench bottom)

in all directions)

Pump Requirements: \_\_\_\_\_ ft. TDH vs. \_\_\_\_\_ GPM

Aggregate Depth: \_\_\_\_\_ inches below pipe

Aggregate Depth: \_\_\_\_\_ inches above pipe

Conditions: See attached design for all system specifications

Aggregate Depth: \_\_\_\_\_ inches total

**WATER LINES (INCLUDING IRRIGATION) MUST BE 10FT. FROM ANY PART OF SEPTIC SYSTEM OR REPAIR AREA.**

**NO UTILITIES ALLOWED IN INITIAL OR REPAIR DRAIN FIELD AREA.**

\*\*If applicable: *I understand the system type specified is different from the type specified on the application. I accept the specifications of this permit.*

Owner/Legal Representative Signature: \_\_\_\_\_

Date: \_\_\_\_\_

This Construction Authorization is subject to revocation if the site plan, plat, or the intended use changes. The Construction Authorization shall not be transferred when there is a change in ownership of the site. This

Construction Authorization is subject to compliance with the provisions of the Laws and Rules for Sewage Treatment and Disposal and to the conditions of this permit.

SEE ATTACHED SITE SKETCH

Authorized State Agent: \_\_\_\_\_

[Signature]

Date: 9/21/23

Construction Authorization Expiration Date: 9/21/28

# SITE SKETCH

HAL OWEN & ASSOCIATES, INC.

Soil Investigation and Septic System Design  
 4071 Barbecue Church Road, PIN 9578-18-2948.000  
 Lot #2 Lyon Builders Inc Map#2022-545  
 14 July 2023

Figure 2. Septic System Layout

## SEPTIC SYSTEM DESIGN

### Repair System

System Type: Type IIIbg Design LTAR 0.45 gal/day/ft<sup>2</sup>  
 Trenches: Quick4 standard chamber (25% reduction)  
 Total Trench Length (ft): 200 Trench Spacing 9 ft on center  
 Trenches installed on contour at 15 inches  
 Maximum Trench Depth of 6 inches (measured on high side)  
 Soil Cover 6 inches (max cover shall not exceed 12 in.)

Design Wastewater Flow 360 gpd  
 Septic Tank Size (minimum) 1000 gallons  
 Pump Tank Size (minimum) 1000 gallons

### Initial System

\*See Detailed Design Parameters  
 System Type: Type IIIbg Design LTAR 0.30 gal/day/ft<sup>2</sup>  
 Trenches: Quick4 standard chamber (25% reduction)  
 Total Trench Length (ft): 300 Trench Spacing 12 inches  
 Trenches installed on contour at 9 ft on center  
 Maximum Trench Depth of 15 inches (measured on high side)  
 Soil Cover 6 inches \*Soil Cover Must Extend 5ft Beyond Drainline\*

Potential Drainlines flagged at site on 9-ft centers.

Line #	Color	Relative Elevation (ft)	Drainline Length(ft)	Field Length(ft)
6	W	98.12	60	74
7	R	97.58	60	62
8	Y	97.15	60	62
9	B	96.46	60	71
10	W	95.83	60	74
Septic Tank:		97.57		
Pump Tank:		97.40		
Reference Elev		100.00		

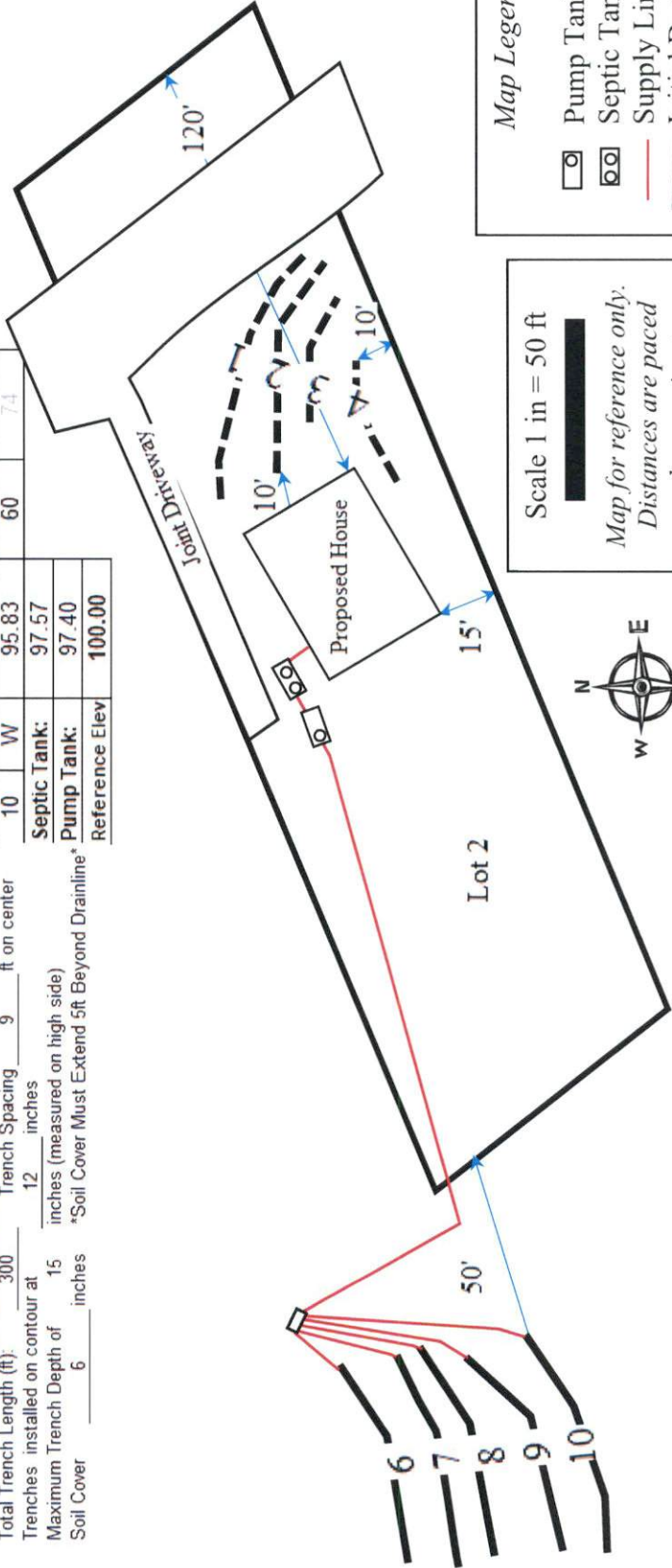

**Map Legend**

- Pump Tank
- Septic Tank
- Supply Lines
- Initial Drainline
- Repair Drainline

Scale 1 in = 50 ft

Map for reference only.  
 Distances are paced  
 and approximate.  
 Not a survey.

OLIVER TOLSON  
 9/21/23