

VICINITY MAP
Not To Scale

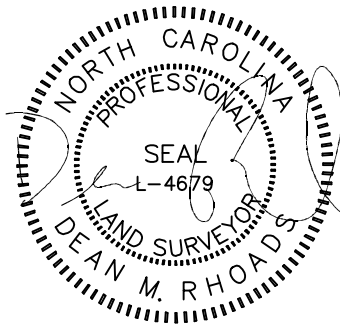

IMPERVIOUS SURFACE AREA	
DESCRIPTION	AREA
HOUSE w/ PORCH	2,797 S.F.
PATIO/HVAC/MISC.	168 S.F.
DRIVEWAY & WALKS	779 S.F.
TOTAL (PROPOSED)=	3,744 S.F.
*TOTAL (ALLOWED)=	5,300 S.F.

SETBACKS: (PB 2021 PG 569)

FRONT-35'
REAR -20'
SIDE-10'
CORNER -10'

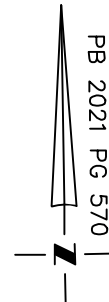

OAK CREEK S/D
PC #C SLIDE 83D

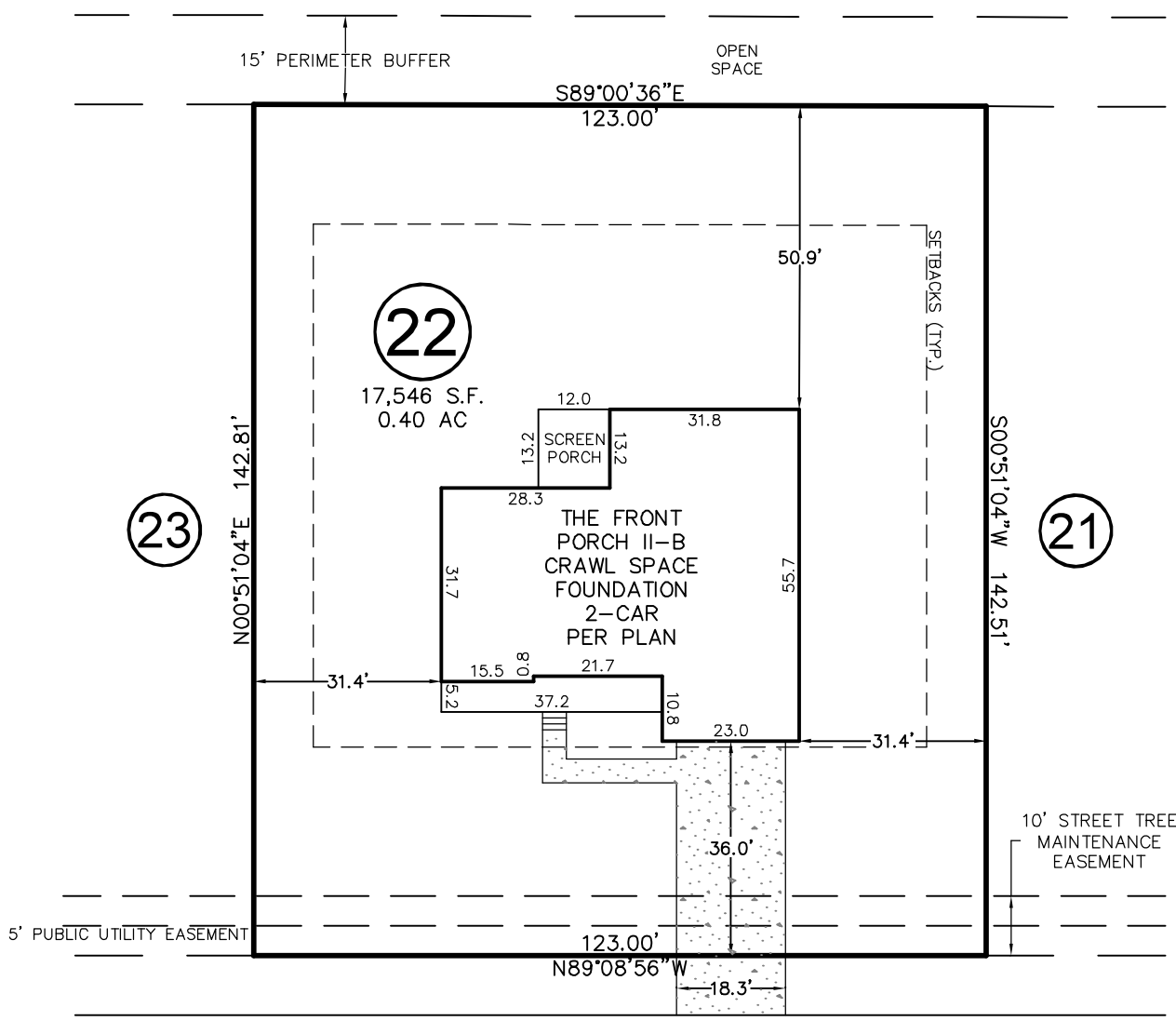

REVISIONS		COMMENT
REV. #	DATE	REVISOR
1	2/15/23	JWW
		CHANGED HOUSE PLAN FROM FRONT PORCH TO FRONT PORCH II

LAMBERT LANE

50' PUBLIC R/W
& UTILITY EASEMENT

THIS DRAWING DOES NOT
REFLECT AS-BUILT INFORMATION

PRELIMINARY PLAT
NOT FOR RECORDATION, CONVEYANCES, OR SALES.

THIS PROPERTY MAY BE SUBJECT TO ANY AND ALL APPLICABLE DEED
RESTRICTIONS, EASEMENTS, RIGHT-OF-WAY, UTILITIES AND
RESTRICTIVE COVENANTS WHICH MAY BE OF RECORD OR IMPLIED

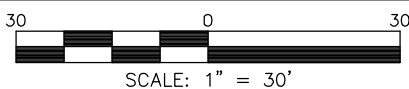

RESIDENTIAL LAND SERVICES, PLLC.

1917 Evans Road
Cary, North Carolina 27513
Phone (919) 378-9316
Firm License # P-0873

HOUSE LOCATION PLOT PLAN

FOR
#508 LAMBERT LANE
LOT 22, PURFOY PLACE SUBDIVISION

Hectors Creek Township, Harnett County, North Carolina

PROPERTY OF: GEMSTONE HOMES

MAP BOOK 2021 PAGE 567-571 DEED REFERENCE PAGE

DRAWN: ADP

SURVEYED: N/A

CHECKED: DMR

DATE: FEBRUARY 9, 2023