



ECS Southeast, LLP

6151 Raeford Road, Suite A
Fayetteville, NC 28304
9104013288
9103230539

LETTER OF TRANSMITTAL

March 9, 2023
Precision Custom Homes

Raeford, NC 28376
ATTN: Shaun Gardner

RE: **Liberty Meadows Lot 38**
ECS Job # **33:6122-W**

Permits:
Location: **56 Hancock Ct**
Cameron, NC 28326

Field Reports For your use As requested

CC: Precision Custom Homes - Allen Peterson Precision Custom Homes - Lauren Ceruti

ENCL: Field Report # 1 3/9/2023

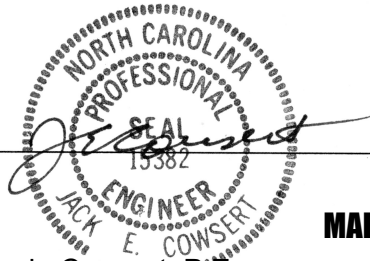

MAR 09 2023

Jack Cowsert, P.E.
Office Manager

Aaron Kyle Adair
Team Leader

Disclaimer

1. This report (and any attachments) shall not be reproduced except in full without prior written approval of ECS.
2. The information in this report relates only to the activities performed on the report date.
3. Where appropriate, this report includes statements as to compliance with applicable project drawings, and specifications for the activities, performed on this report date.
4. Incomplete or non-conforming work will be reported for future resolution.
5. The results of samples and/or specimens obtained or prepared for subsequent laboratory testing will be presented in separate reports/documents.



ECS Southeast, LLP
 6151 Raeford Road, Suite A
 Fayetteville, NC 28304
 (910) 401-3288 [Phone]
 (910) 323-0539 [Fax]

FIELD REPORT

Project **Liberty Meadows Lot 38**
 Location **Cameron, NC**
 Client **Precision Custom Homes**
 Contractor **Precision Custom Homes**

Project No. **33:6122-W**
 Report No. **1**
 Day & Date **Thursday 3/9/2023**
 Weather **60 °/ Sunny**
 On-Site Time **1.25**
 Lab Time **0.00**
 Travel Time* **0.00**
 Total **1.25**
 Re Obs Time **0.00**

Remarks

Trip Charges*	Tolls/Parking*	Mileage*	Time of Arrival	Departure
Chargeable Items			9:00A	10:15A

* Travel time and mileage will be billed in accordance with the contract.

Summary of Services Performed (field test data, locations, elevations & depths are estimates) & Individuals Contacted.

ECS arrived on site, as requested, to check the bearing capacity of soils via hand auger/DCP method for monolithic slab foundation. Footings have not been excavated. Please see the attached sketch and data sheet for details.

A hand auger was used to advance the boreholes to different depths noted on the boring logs. Dynamic Cone Penetrometer (DCP) test were performed in the hand auger boreholes by a 1.5 inch diameter cone driven into the soil by a 15 pound ring weight with a free fall of 20 inches. The number of blows required to drive the cone into the soil a distance of 1.75 inches is termed the DCP Value and is indicated for each test on the hand auger.

A total of 4 hand auger/DCP evaluations were performed to a depth of approximately 3 feet below the current footing sub grade elevation. Test results indicated that the materials in place (at the locations and elevations tested) did appear to be suitable to support the design bearing capacity 2,000 psf.

ECS will return upon request to provide additional services.

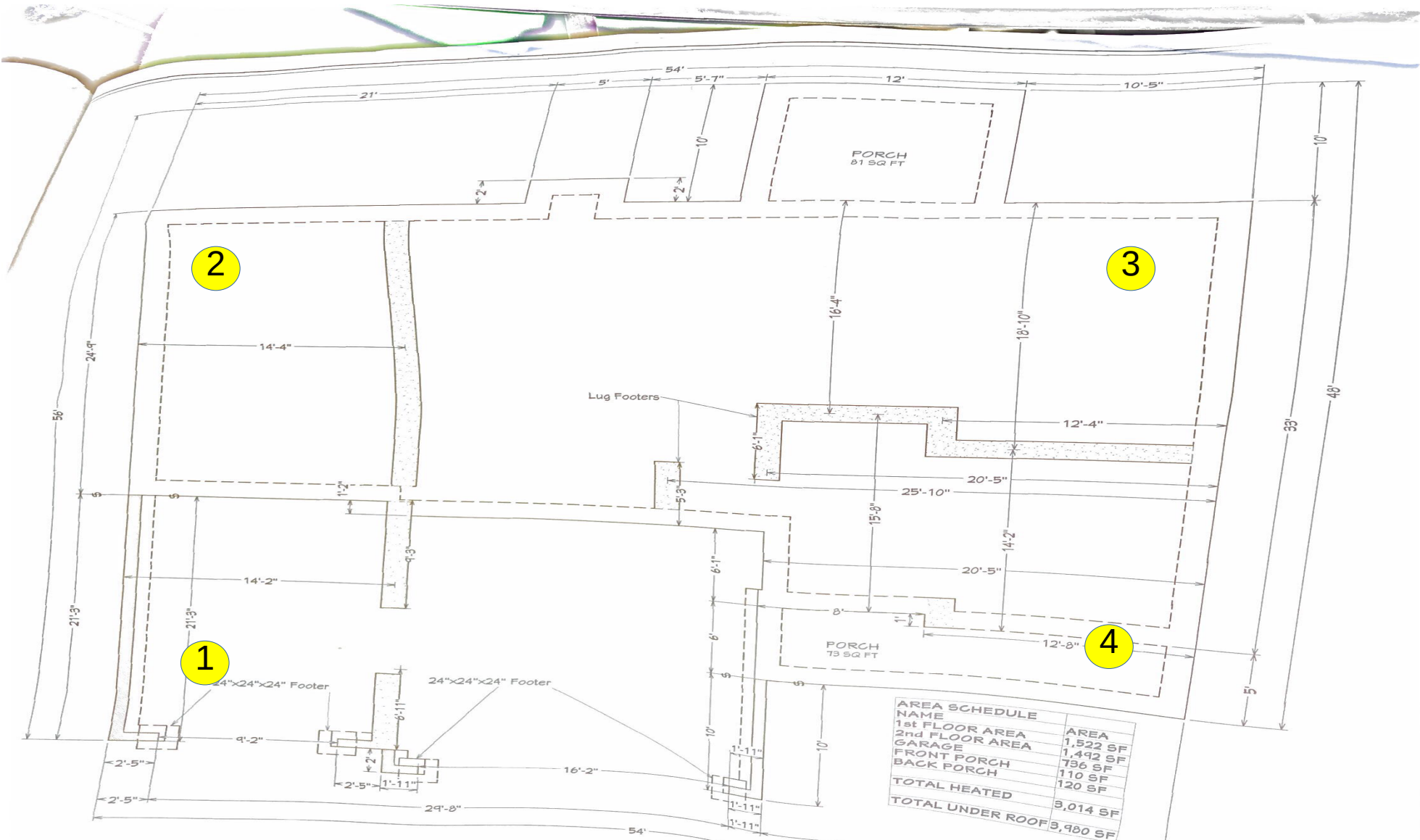

Created with ScanWritr. To remove this watermark please use the upgrade options.

Sulaiman Sharieff
 03/9/2023
 Liberty Meadows Lot 38
 Proj #: 6122-W
 W/O # 71148

Key (NTS)

DCP Location



NORTH



Attachments



IMG_0153[1]

Figure 1



Report of Spread Footing - Foundation Observations

Project: Liberty Meadows Lot 38
 Location: 56 Hancock Ct
Cameron - Harnett - NC - 28326
 Contractor: Precision Custom Homes

Project No.: 33:6122-W
 Day/Date: 3/9/2023

Footing Number	Location	Size (W x H x L)		Footing Bottom Elevation		Description of Steel Placed	Description of Subgrade Material	Required Blow Counts # of Blows / Increment	Design Bearing Pressure
		Design	Actual	Design **	Depth of Undercut (in)				
1	South West	x x	x x	N/A	0,-1,-2,-3		(0) red sand (-1) brown sand (-2, -3) tan clayey sand	6 (0)6-5-5 (-1)8-7-7 (-2)10-9-7 (-3)18-15-15	2000
2	North West	x x	x x	N/A	0,-1,-2,-3		(0) red sand (-1) brown sand (-2, -3) tan clayey sand	6 (0)5-6-5 (-1)8-9-7 (-2)11-18-21 (-3)25+	2000
3	North East	x x	x x	N/A	0,-1,-2,-3		(0) red sand (-1, -2,-3) tan clayey sand	6 (0)6-6-7 (-1)8-8-8 (-2)12-10-12 (-3)25+	2000
4	South East	x x	x x	N/A	0,-1,-2,-3		(0) red sand (-1) tan sand (-2,-3) tan clayey sand	6 (0)6-6-7 (-1)10-11-9 (-2)11-10-13 (-3)16-16-13	2000

** SGE: Subgrade Elevation to be determined by surveyor.

By: Sulaiman Sharieff



Report of Spread Footing - Foundation Observations

Project: Liberty Meadows Lot 38
Location: 56 Hancock Ct
Cameron - Harnett - NC - 28326
Contractor: Precision Custom Homes

Project No.: 33:6122-W
Day/Date: 3/9/2023

ECS Southeast, LLP

WO: 71148