

HARNETT DEPARTMENT OF PUBLIC HEALTH PERMIT TO CONSTRUCT A DRINKING WATER SUPPLY WELL

SFD 2302-0033

1600-17-5354.000 0716000260 PIN #: Parcel #: Application #: SFD 2302 Subdivision: Lot #: 0033

licant Name: Robert Pope Builders Address: 130 Kent Ln Coats

Type of Facility Served by Well: SFD

Sewage System: 25% REDUCTION

Permit Conditions:

General Permit Conditions:

- Drinking water supply well construction must meet 15A NCAC 02C.100 rules
• The permitted drinking water supply well shall be located in accordance with the SITE PLAN
• ANY ALTERATION of the site of the site (including location of structures and appurtenance) or modification in use of the well, may subject this Permit to revocation

Authorized State Agent James E. Markant Date 3-2-23

Grouting Inspection Witnessed Date
Grouting self-certified by driller GW-1 provided? Yes No

See attachment for construction sketch

WELL CERTIFICATE OF COMPLETION

Date: Application #: Well Contractor:

licant Name: Address: Directions to Site:

Use of Well: Date Drilled: Total Depth: Replacement Well? Yes No
Static Water Level: Top of Casing is in. above surface. Yield: gpm at ft.
Disinfection: Type Amount

Table with 3 columns: Water Zone (depth), Casing, Grout. Rows for different depth intervals with fields for From, To, Diameter, Material, Thickness, and Method.

Inspector: On Hold Date: Release Date:

Remarks:

Well Head Information

Casing Height: 18 (above finished grade) Access Port: Vent Stack:
Well ID Tag: Pump ID Tag: Sampling Tap: Backflow Preventer:
Sample Taken? Yes No Well Head properly sealed:

arks:

Authorized State Agent James E. Markant Date 10-27-23

See Attachment for completion sketch

Application #: SFD 2302-0033

Applicant Name: Robert Pope Builders

Subdivision: \_\_\_\_\_

Lot #: \_\_\_\_\_

Well Construction Sketch

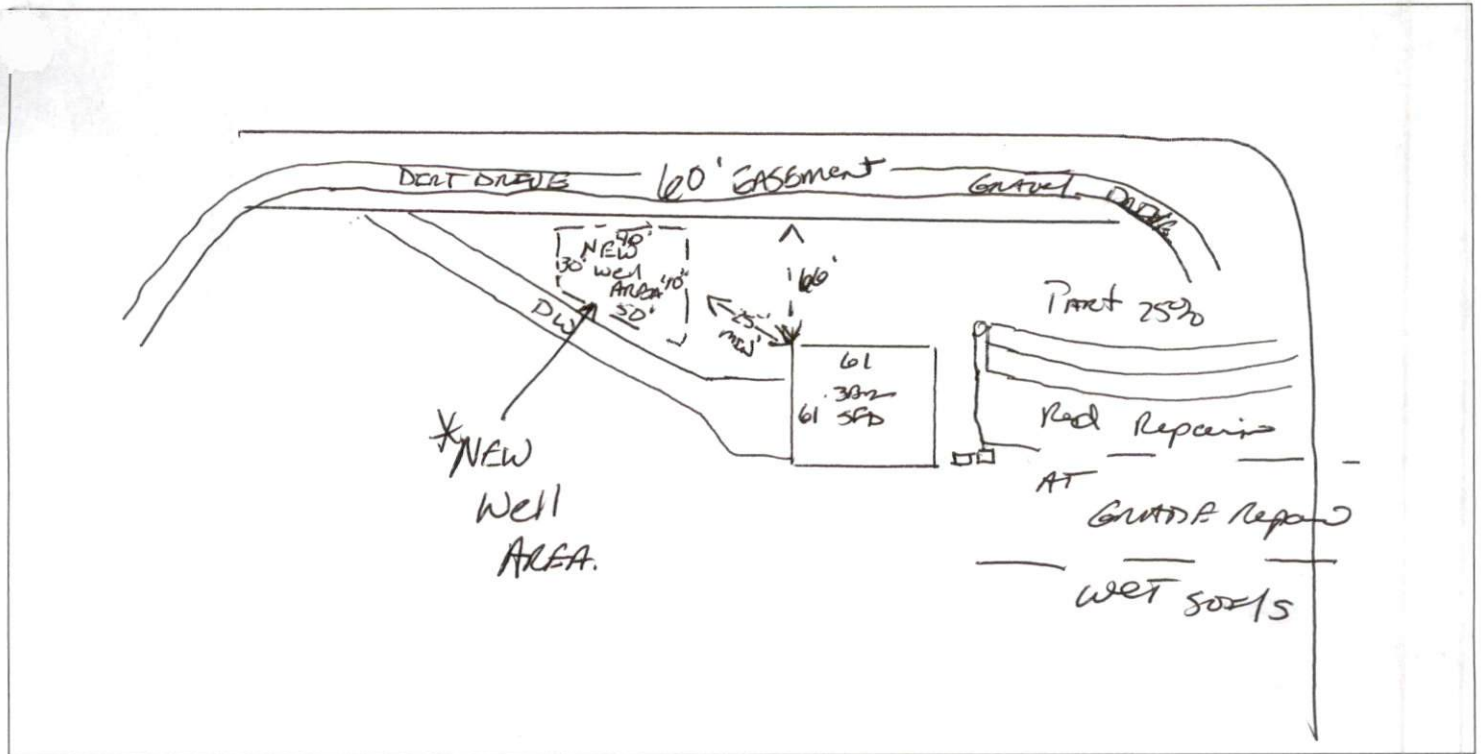

1 Completion Sketch

Kent LN

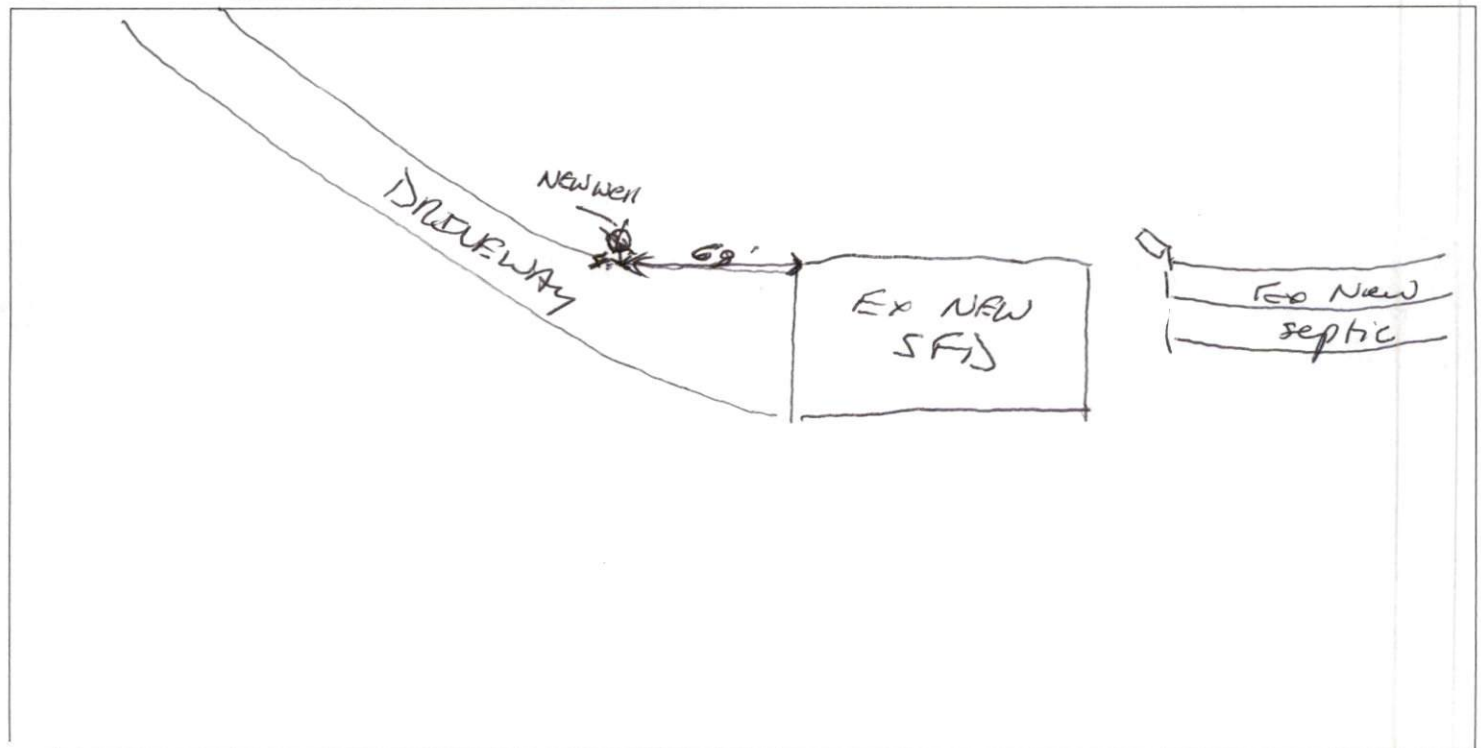

# WELL CONSTRUCTION RECORD (GW-1)

## I. Well Contractor Information:

John H. Boyette Jr.

Well Contractor Name:

2505

C. Well Contractor Certification Number

Boyette Well & Septic Inc.

Company Name:

Well Construction Permit #:

for all applicable well construction permits (i.e. UIC, County, State, Reservoir, etc.)

Well Use (check well use):

Water Supply Well:

- Agricultural  Municipal/Public
- Geothermal (Heating/Cooling Supply)  Residential Water Supply (single)
- Industrial/Commercial  Residential Water Supply (shared)
- Irrigation  Wells > 100,000 GPD
- In-Water Supply Well
- Monitoring  Recovery
- Injection Well:
- Aquifer Recharge  Environmental Remediation
- Aquifer Storage and Recovery  Solidity Barrier
- Aquifer Test  Stormwater Drainage
- Experimental Technology  Subsurface Control
- Geothermal (Closed Loop)  tracer
- Geothermal (Heating/Cooling Return)  Other (explain under #21 Remarks)

Date Well(s) Completed: 7-11-23 Well #s:

## II. Well Location:

Robert Pope Builders

City/Owner Name Facility No. (if applicable)

130 Kent Lane, Coats

Physical Address, City, and Zip

Harnet

County

Parcel Identification No. (PIN)

Latitude and longitude in degrees, minutes, seconds or decimal degrees; well field, use listing is sufficient

\_\_\_\_\_ N \_\_\_\_\_ W

Is (are) the well(s):  Permanent or  Temporary

Is this a repair to an existing well:  Yes or  No  
If it is a repair, fill out former well construction information and explain the nature of the work on the reverse side or on the back of this form.

For Completion of Closed Loop Geothermal Wells having the same location, only 1 GW-1 is needed. Indicate TOTAL NUMBER of wells: 1

Total well depth below land surface: 425 (ft.)  
multiple wells list all depths if different (example: 30/100 and 20/100)

Static water level below top of casing: 20 (ft.)  
water level in above casing, use "+"

Wellbore diameter: 6.25 (in.)

Well construction method: air rotary

(e.g., rotary, cable, direct push, etc.)

## III. WATER SUPPLY WELLS ONLY:

Yield (gpm): 3 Method of test: flow

Disinfection type: HTH Amount: 16 oz.

For Internal Use Only:

IV. WATER ZONES						
FROM	TO	DESCRIPTION				
400 ft.	403 ft.					
ft.	ft.					
V. OTHER CASING (for use in case of well OR OTHER (if applicable))						
FROM	TO	DIAMETER	THICKNESS	MATERIAL		
ft.	ft.	in.				
VI. OTHER CASING OR TUBING (if installed close to well)						
FROM	TO	DIAMETER	THICKNESS	MATERIAL		
+1.5 ft.	142 ft.	6.25 in.	SDR21	PVC		
142 ft.	147 ft.	6.25 in.	188	Galv. steel		
VII. SCREEN						
FROM	TO	DIAMETER	SLOT SIZE	THICKNESS	MATERIAL	
ft.	ft.	in.				
ft.	ft.	in.				
VIII. Casing						
FROM	TO	MATERIAL	INSTALLMENT METHOD & ADJUST			
0 ft.	25 ft.	benlomite	pumped			
ft.	ft.					
ft.	ft.					
IX. CASING/SHAFT PACK (if applicable)						
FROM	TO	MATERIAL	INSTALLMENT METHOD			
ft.	ft.					
ft.	ft.					
X. WELL LOG LOG (attach additional sheets if necessary)						
FROM	TO	DESCRIPTION (color, texture, etc., with depth, zone, permeability, etc.)				
0 ft.	30 ft.	clay				
30 ft.	60 ft.	sandstone				
60 ft.	425 ft.	granite				
ft.	ft.					
ft.	ft.					
ft.	ft.					
ft.	ft.					
XI. REMARKS						

## XII. Certification:

Signature of Certified Well Contractor: John Boyette Date: 8-1-23

I, the undersigned, hereby certify that this well was constructed in accordance with 15A NCAC 02C .0100 or 15A NCAC 02C .0200 Well Construction Standards and that a copy of this record has been provided to the well owner.

## XIII. Site Diagram or additional well details:

You may use the back of this page to provide additional well construction info (add See Over in Remarks Box). You may also attach additional pages if necessary.

## XIV. SUBMITTAL INSTRUCTIONS

Submit this GW-1 within 30 days of well completion per the following:

24a. For All Wells: Original form to Division of Water Resources (DWR), Information Processing Unit, 1617 MSC, Raleigh, NC 27609-1617

24b. For Injection Wells: Copy to DWR, Underground Injection Control (UIC) Program, 1636 MSC, Raleigh, NC 27609-1636

24c. For Water Supply and Open Loop Geothermal Return Wells: Copy to the county environmental health department of the county where installed

24d. For Water Wells producing over 100,000 GPD: Copy to DWR, CCPCUA Permit Program, 1617 MSC, Raleigh, NC 27609-1617