

4-Bedroom Septic Plan
 Lot #26 - Duncan's Crossing
 Harnett County
 Smith Douglas Homes

*House footprint to be field staked by surveyor and system verified prior to any construction

**Septic area must not be altered by construction activities.

***No cuts of 2' or greater within 15' of septic area

**** Recommend protective barrier around septic field during construction.

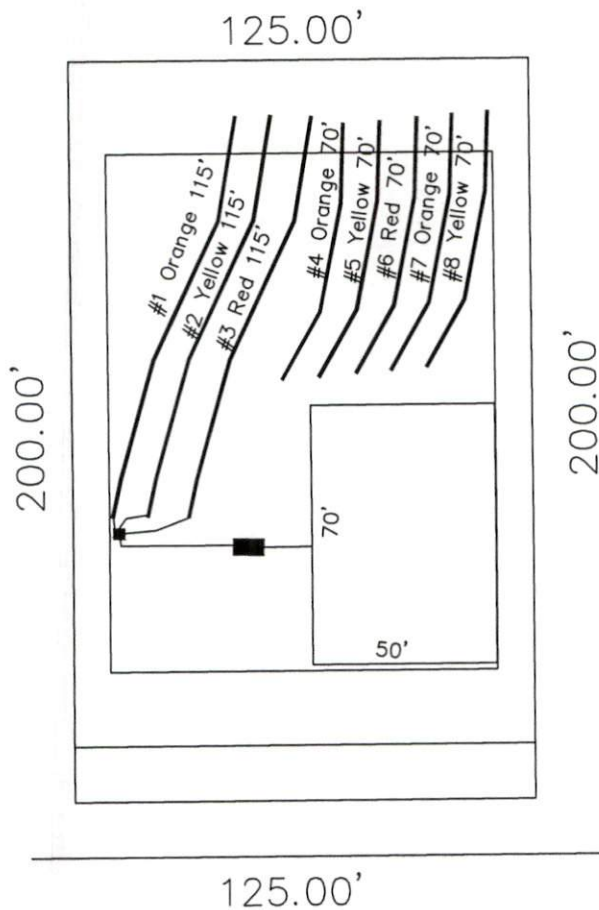

26

25,000 SF
 (0.57 AC)

*If plumbing is not sufficient a pump tank will be required to septic field.

System: Gravity to D-Box
 Lines: Lines 1-5 (350')
 0.35 LTAR
 24" Max Trench Bottom
 Accepted Status System
 Repair: Gravity to D-Box
 Lines: Lines 6-10 (350')
 0.35 LTAR
 24" Trench Bottom
 Accepted Status System

CLYDE DOG COURT
 50' R/W (PUBLIC & UTILITY ACCESS)

GRAPHIC SCALE
 1" = 50'



Adams
 Soil Consulting
 919-414-6761
 Job #1146