

AA TAKLA ENGINEERING, PLLC Consulting. Design. Efficiency.

Atef A. Takla, PE | 919-358-1758 | atefakla@taklaengr.com

NC Firm License No. P-1446
418 Vivaldi Dr. Durham, NC 27712

Project: 111 Sandollar
Location: Cary, NC
Date: 11/1/23
Company: _____
Care Of: Shown Spears
(919)669-9462

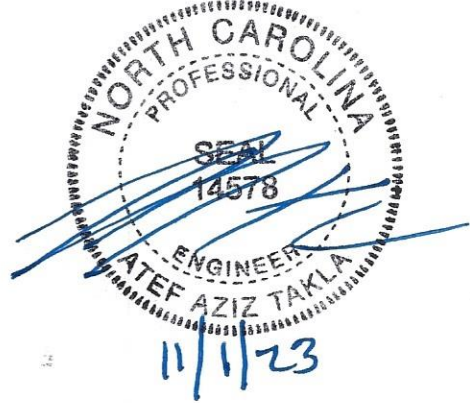

As requested, A. Takla visited the property and observed the existing rear covered porch slab/turn Down Grade Beam, and found it adequate to receive an overlay approx 4" inches thick (to make existing slab flush w/ the House's Floor)

Limitations of Inspection: Services provided are in accordance with the standard of practice for structural engineering and within the limits imposed by scope, schedule and budget. The determinations contained in this report are based on conditions observed at the time of the evaluation. No guarantees or warranties, expressed or implied, under this Agreement or otherwise, shall be construed in connection with services provided. Sequencing, shoring, means and methods of construction are considered beyond the scope of this report.



AA TAKLA ENGINEERING, PLLC

Consulting. Design. Efficiency.

Atef A. Takla, PE | 919-358-1758 | ateftakla@taklaengr.com

NC Firm License No. P-1446
418 Vivaldi Dr. Durham, NC 27712

Project: 116 Lthica lane
Location: Bunnlevel, NC
Date: 10/26/23
Company: _____
Care Of: Shawn Spears
(919) 669-9462



As requested, A. Takla (Engineer of record) prepared this report to address the following items: -

- (A) Add 2x10 stud to existing LVL beam column nailed w/ (3) -10d nails to B.O.C Flat against the existing 2x4 studs @ the Garage.
- (B) Hand written notes on the plan are done by A. Takla P.E.
- (C) missing 2x10 joist under the closets doors wall is not needed.

Limitations of Inspection: Services provided are in accordance with the standard of practice for structural engineering and within the limits imposed by scope, schedule and budget. The determinations contained in this report are based on conditions observed at the time of the evaluation. No guarantees or warranties, expressed or implied, under this Agreement or otherwise, shall be construed in connection with services provided. Sequencing, shoring, means and methods of construction are considered beyond the scope of this report.

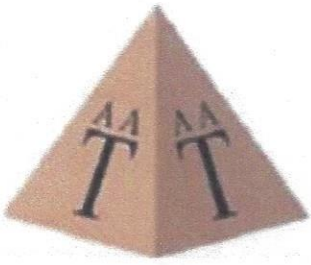

AA TAKLA ENGINEERING, PLLC Consulting. Design. Efficiency.

Atef A. Takla, PE | 919-358-1758 | ateftakla@taklaengr.com

NC Firm License No. P-1446
418 Vivaldi Dr. Durham, NC 27712

Project: 947 Jared Drive
Location: Linden, NC
Date: 11/3/23
Company: _____
Care Of: Shawn Spear
(919)669-9462



AS REQUESTED, A. TAKLA OBSERVED THE DRILLED "LVL" HEADER (over Bay Area) and we recommend that new beam (2) - 11 7/8" LVL be installed at wall above the header. Cut wall's studs larger the beam below.
- install (2) - 11 7/8" LVL (approx 12" inches larger the beam below).
- install "CS22" straps @ 12" o.c TO Hange the DRILLED BEAM TO THE NEW BEAM.

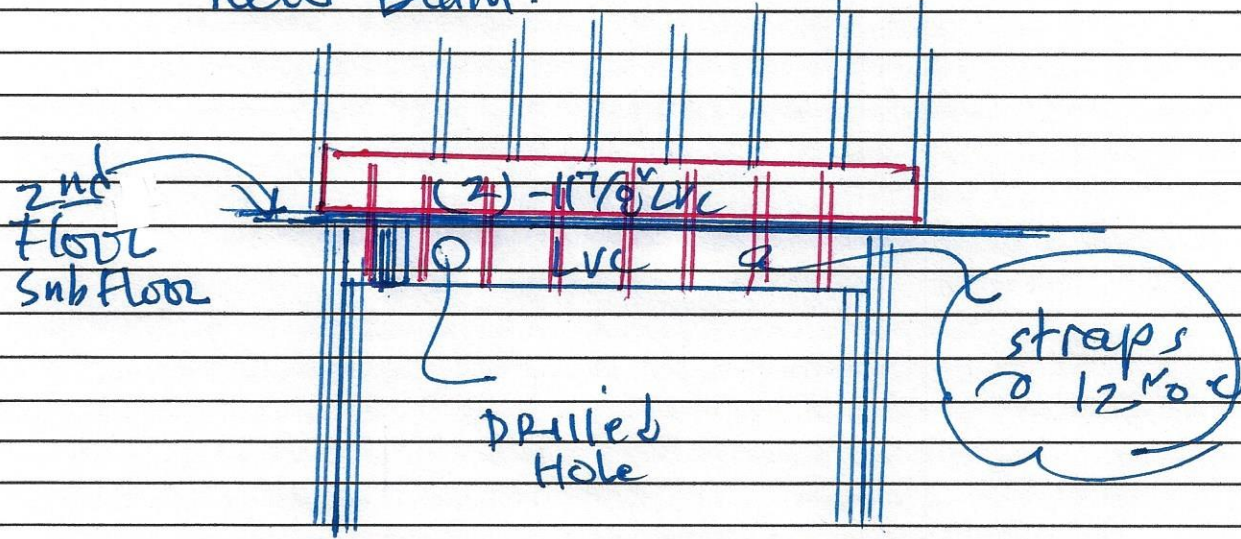

Limitations of Inspection: Services provided are in accordance with the standard of practice for structural engineering and within the limits imposed by scope, schedule and budget. The determinations contained in this report are based on conditions observed at the time of the evaluation. No guarantees or warranties, expressed or implied, under this Agreement or otherwise, shall be construed in connection with services provided. Sequencing, shoring, means and methods of construction are considered beyond the scope of this report.