

Harnett County Department of Public Health

Improvement Permit

A building permit cannot be issued with only an Improvement Permit

ISSUED TO: Dream Finders Homes PROPERTY LOCATION: 456 Countryside Dr
 SUBDIVISION Oakmont LOT # 84
 NEW REPAIR EXPANSION Site Improvements required prior to Construction Authorization Issuance:
 Type of Structure: SFD (54'x53')
 Proposed Wastewater System Type: Pump to 25% Red Sys
 Projected Daily Flow: 600 GPD
 Number of bedrooms: 5 Number of Occupants: 10 max
 Basement Yes No
 Pump Required: Yes No May be required based on final location and elevations of facilities
 Type of Water Supply: Community Public Well Distance from well _____ feet Permit valid for: Five years
 No expiration
 Permit conditions: _____

Authorized State Agent: [Signature] Date: 3/13/23 SEE ATTACHED SITE SKETCH
 The issuance of this permit by the Health Department in no way guarantees the issuance of other permits. The permit holder is responsible for checking with appropriate governing bodies in meeting their requirements. This site is subject to revocation if the site plan, plat, or the intended use changes. The Improvement Permit shall not be affected by a change in ownership of the site. This permit is subject to compliance with the provisions of the Laws and Rules for Sewage Treatment and Disposal and to conditions of this permit.

Construction Authorization

(Required for Building Permit)

The construction and installation requirements of Rules .1950, .1952, .1954, .1955, .1956, .1957, .1958, and .1959 are incorporated by references into this permit and shall be met. Systems shall be installed in accordance with the attached system layout.

ISSUED TO: Dream Finders Homes PROPERTY LOCATION: 456 Countryside Dr
 SUBDIVISION Oakmont LOT # 84
 Facility Type: SFD (54'x53') New Expansion Repair
 Basement? Yes No Basement Fixtures? Yes No
 Type of Wastewater System** Pump 25% Reduction System (Initial) Wastewater Flow: 600 GPD
 (See note below, if applicable
Pump to 25% Red Sys (Repair)

Installation Requirements/Conditions
 Septic Tank Size 1250 gallons
 Pump Tank Size 1000 gallons
 Number of trenches 1
 Exact length of each trench 200 feet
 Trench Spacing: 9 Feet on Center
 Trenches shall be installed on contour at a
 Maximum Trench Depth of: 18 inches
 (Trench bottoms shall be level to +/-1/4" in all directions)
 Soil Cover: 6 inches
 (Maximum soil cover shall not exceed 36" above the trench bottom)
 Pump Requirements: _____ ft. TDH vs. _____ GPM
 Aggregate Depth: _____ inches below pipe
 _____ inches above pipe
 _____ inches total
 Conditions: _____

**WATER LINES (INCLUDING IRRIGATION) MUST BE 10FT. FROM ANY PART OF SEPTIC SYSTEM OR REPAIR AREA.
 NO UTILITIES ALLOWED IN INITIAL OR REPAIR DRAIN FIELD AREA.**

**If applicable: I understand the system type specified is different from the type specified on the application. I accept the specifications of this permit.
 Owner/Legal Representative Signature: _____ Date: _____

This Construction Authorization is subject to revocation if the site plan, plat, or the intended use changes. The Construction Authorization shall not be transferred when there is a change in ownership of the site. This Construction Authorization is subject to compliance with the provisions of the Laws and Rules for Sewage Treatment and Disposal and to the conditions of this permit. SEE ATTACHED SITE SKETCH

Authorized State Agent: [Signature] Date: 3/13/23
 Construction Authorization Expiration Date: 3/13/28

Application # SFD2301-0077

Harnett County Department of Public Health Site Sketch

Property Location: 456 Countryside Dr

Issued To: Dream Finders Homes

Subdivision Oakmont

Lot # 84

Authorized State Agent: [Signature]

REHS (OLIVER TOLKSDORF)

Date: 3/13/23

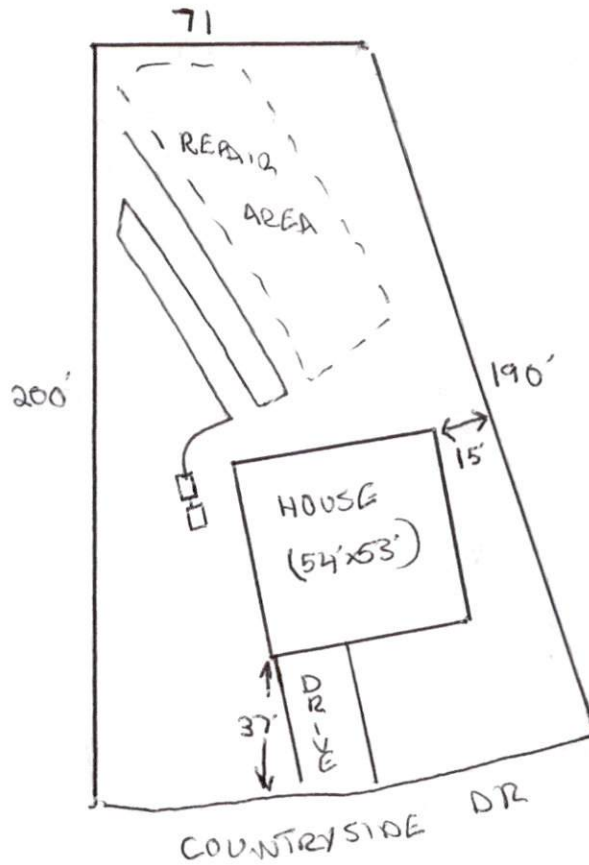

This drawing is for illustrative purposes only. System installation must meet all pertinent laws, rules, and regulations.