

ECS Southeast, LLP

6151 Raeford Road, Suite A
Fayetteville, NC 28304
9104013288
9103230539

LETTER OF TRANSMITTAL

October 18, 2023
W.S. Wellons Realty
PO Box 766
Spring Lake, NC 28390
ATTN: Chandler Jones

RE: **Lot 134 HLN**
ECS Job # **33:6230-I**

Permits:
Location: **46 Sugarberry Place**
Spring Lake, NC 28390

Field Reports For your use As requested

CC:

ENCL: Field Report # 1 10/17/2023



OCT 18 2023

Jack Cowser, P.E.
Office Manager

Aaron Kyle Adair
Team Leader

Disclaimer

1. This report (and any attachments) shall not be reproduced except in full without prior written approval of ECS.
2. The information in this report relates only to the activities performed on the report date.
3. Where appropriate, this report includes statements as to compliance with applicable project drawings, and specifications for the activities, performed on this report date.
4. Incomplete or non-conforming work will be reported for future resolution.
5. The results of samples and/or specimens obtained or prepared for subsequent laboratory testing will be presented in separate reports/documents.

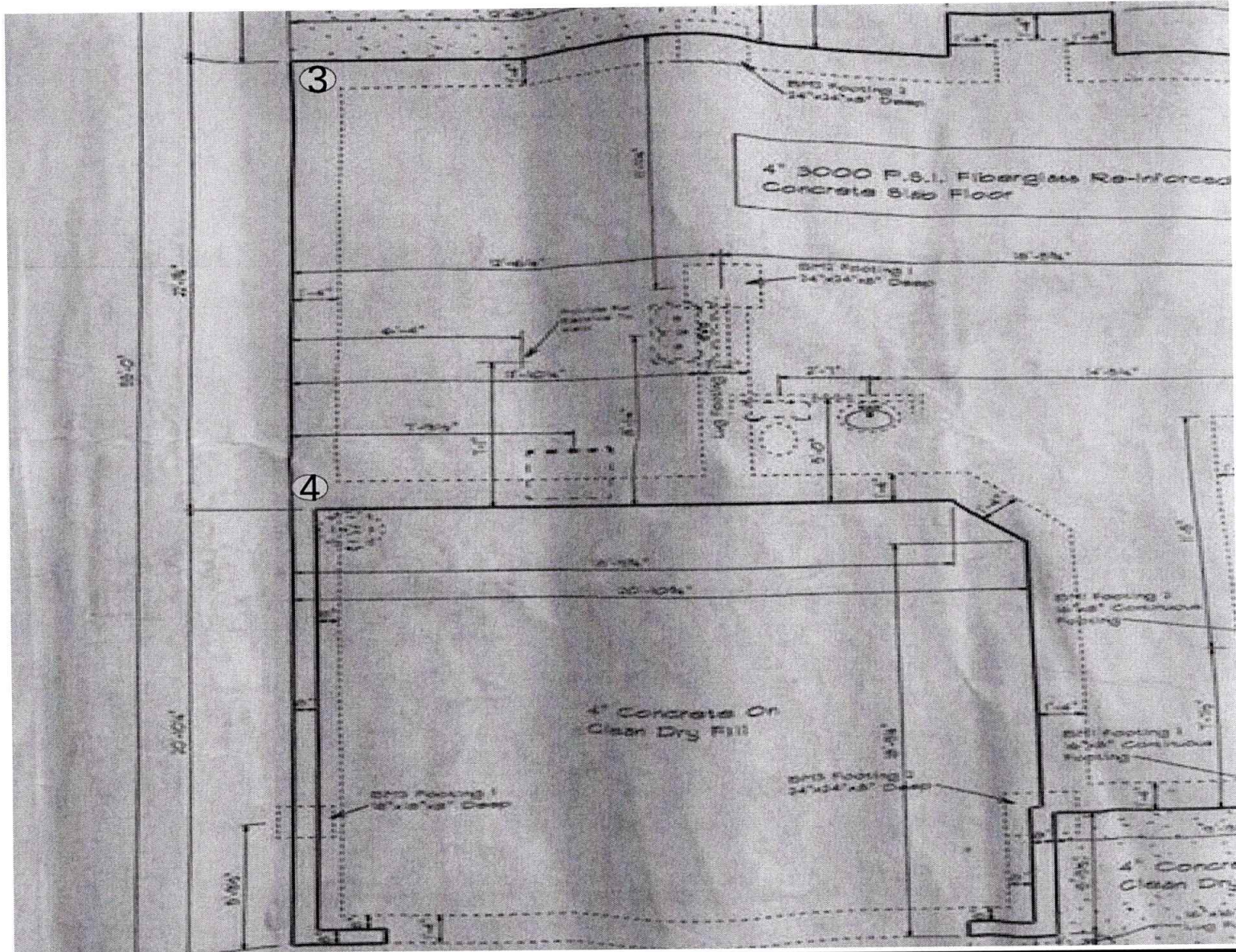

Todd T. Davis
 10/17/2023
 Lot 134 – 46 Sugarberry
 Proj #: 6230-I
 W/O # 74787

Key (NTS)
 Hand Auger / DCP
 Test Location --- ⊕

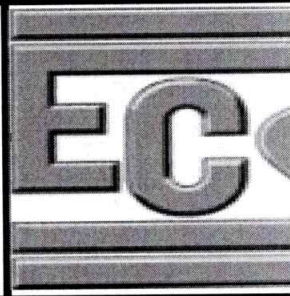

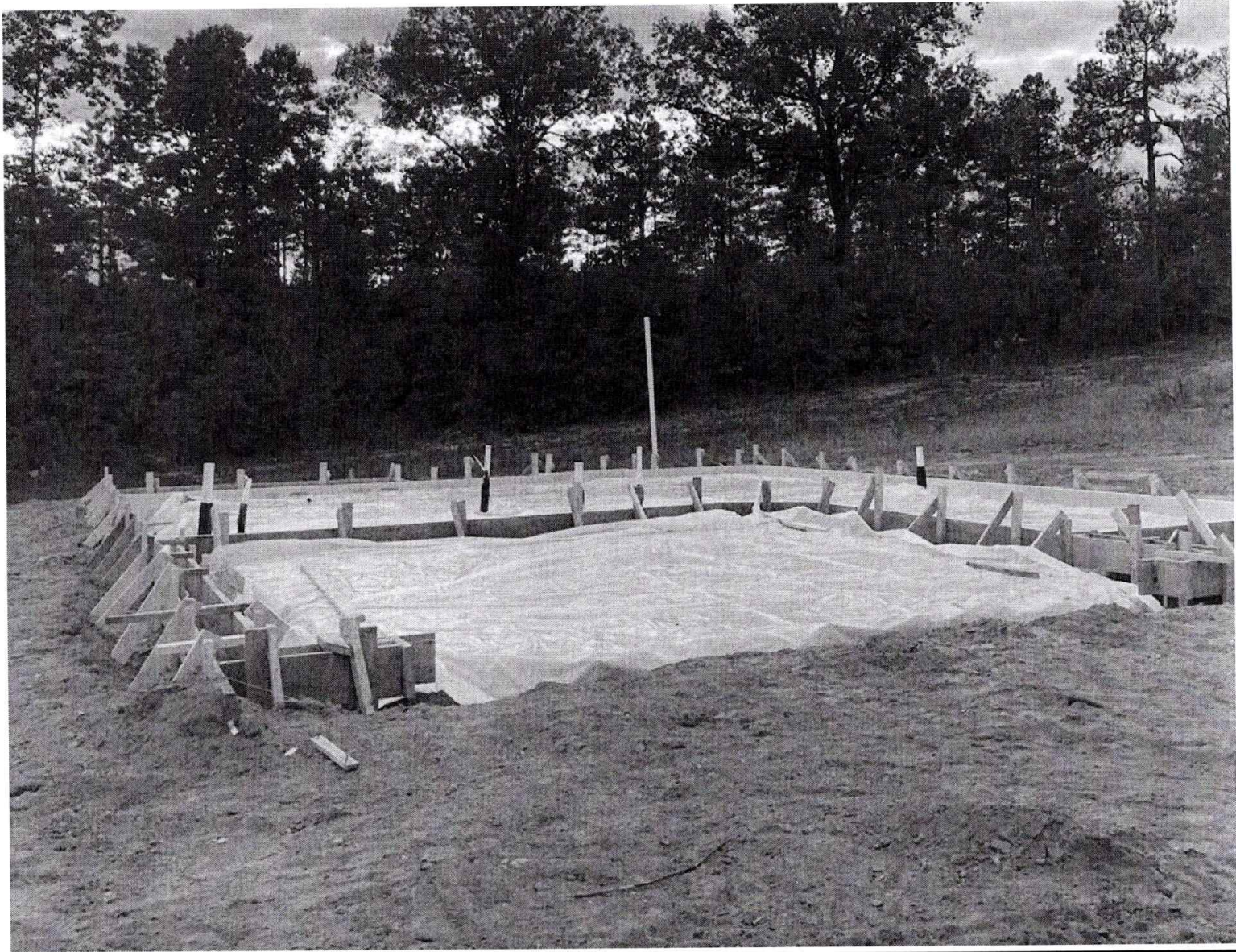

Todd T. Davis
10/17/2023
Lot 134 – 46 Sugarberry
Proj #: 6230-I
W/O # 74787

Key (NTS)

View of Lot 134 – 46 Sugarberry
Place



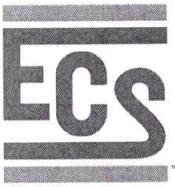

Report of Spread Footing - Foundation Observations

Project: Lot 134 HLN
 Location: 46 Sugarberry Place
Spring Lake - Cumberland - NC - 28390
 Contractor: W.S. Wellons Realty

Project No.: 33:6230-I
 Day/Date: 10/17/2023

Footing Number	Location	Size (W x H x L)		Footing Bottom Elevation		Description of Steel Placed	Description of Subgrade Material	Re #
		Design	Actual	Design **	Depth of Undercut (in)			
1		x x	x x	N/A	N/A		(0-3) Tan-Red Silty Sand	6 (0 8.1
2		x x	x x	N/A	N/A		(0-3) Tan Silty Sand	6 (0 6.1
3		x x	x x	N/A	N/A		(0-3) Tan-Brown Silty Sand	6 (0 7.1
4		x x	x x	N/A	N/A		(0-3) Tan-Brown Silty Sand	6 (0 5.1

** SGE: Subgrade Elevation to be determined by surveyor.

By: Todd Davis

ECS Southeast, LLC