

SOUTHEASTERN SOIL & ENVIRONMENTAL ASSOC., INC.

PROPOSED SUBSURFACE WASTE DISPOSAL SYSTEM DETAIL SHEET

SUBDIVISION: ROCKING SPRINGS

LOT 125

INITIAL SYSTEM: APPROVED 25% REDUCTION

REPAIR APPROVED 25% REDUCTION

DISTRIBUTION: D-Box

DISTRIBUTION D-Box

BENCHMARK: 100.0

LOCATION TOP WATER METER

NO. BEDROOMS: 4

LTAR 0.5 GPD/FT<sup>2</sup>

SEPTIC TANK SIZE 1000

PUMP TANK SIZE

<u>LINE</u>	<u>FLAG COLOR</u>	<u>ELEVATION</u>	<u>LENGTH</u>
1	Pu	105.84	80'
2	Y	104.92	80'
3	Pu	104.00	80'
			<u>240'</u>
4	Y	103.08	80'
5	Pu	102.50	80'
6	Y	101.50	80'
			<u>240'</u>

Initial system

BY M EAKER

DATE 11/2022

TYPICAL PROFILE

0-20 LI  
20-36 LT SEC/SC  
CR 2 > 36"  
INSTALL AT 18"

THERE SHALL BE NO GRADING, CUTTING, LOGGING OR OTHER SOIL DISTURBANCE IN SEPTIC AREA

HEALTH DEPARTMENT USE ONLY.  
 DESIGNS DO NOT GUARANTEE FUNCTIONALITY

# Southeastern Soil & Environmental Associates, Inc.

P.O. Box 9321  
 Fayetteville, NC 28311  
 Phone/Fax (910) 822-4540  
 Email mike@southeasternsoil.com

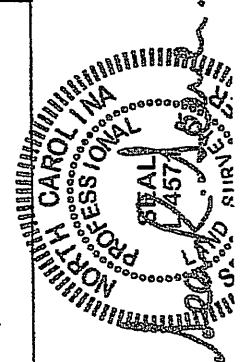
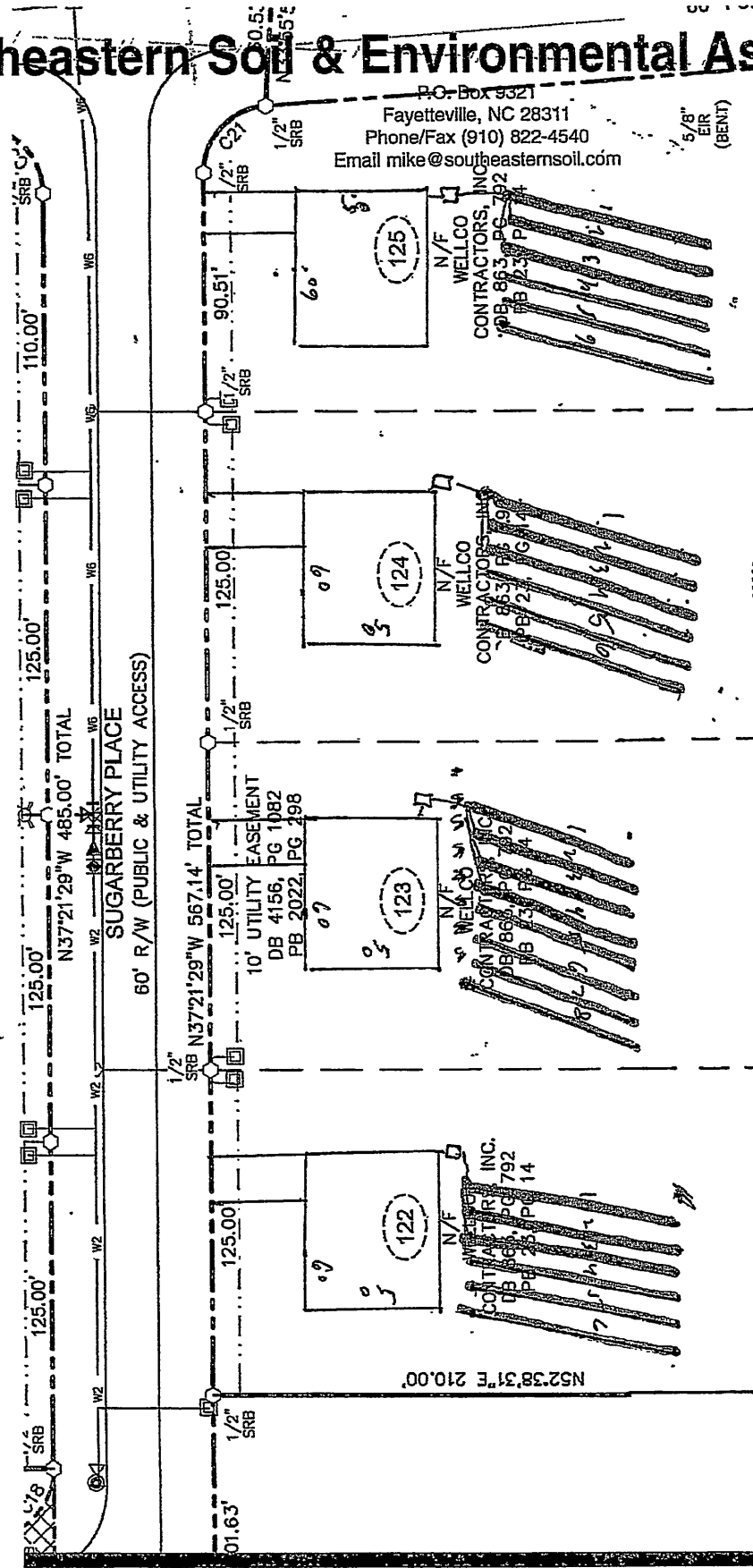

I, SEAN R. SEEVER, CERTIFY THAT THIS SURVEY CREATES A SUBDIVISION OF LAND WITHIN THE AREA OF A COUNTY OR MUNICIPALITY THAT HAS AN ORDINANCE THAT REGULATES PARCELS OF LAND.

*Sean R. Seever*

PROFESSIONAL LAND SURVEYOR. - L-4571

1" = 60'