



**ECS Southeast, LLP**

6151 Raeford Road, Suite A  
Fayetteville, NC 28304  
9104013288  
9103230539

**LETTER OF TRANSMITTAL**

July 12, 2023  
W.S. Wellons Realty  
PO Box 766  
Spring Lake, NC 28390  
ATTN: Chandler Jones

RE: **Lot 124 HLN**  
ECS Job # **33:6230-D**  
  
Permits:  
Location: **41 Sugarberry PI**  
**Spring Lake, NC 28390**

Field Reports       For your use       As requested

CC:

ENCL: Field Report # 2      7/12/2023



**JUL 12 2023**

Jack Cowsert, P.E.  
Office Manager

Aaron Kyle Adair  
Team Leader

*Disclaimer*

1. This report (and any attachments) shall not be reproduced except in full without prior written approval of ECS.
2. The information in this report relates only to the activities performed on the report date.
3. Where appropriate, this report includes statements as to compliance with applicable project drawings, and specifications for the activities, performed on this report date.
4. Incomplete or non-conforming work will be reported for future resolution.
5. The results of samples and/or specimens obtained or prepared for subsequent laboratory testing will be presented in separate reports/documents.



ECS Southeast, LLP  
6151 Raeford Road, Suite A  
Fayetteville, NC 28304  
(910) 401-3288 [Phone]  
(910) 323-0539 [Fax]

## FIELD REPORT

Project **Lot 124 HLN**  
Location **Spring Lake, NC**  
Client **W.S. Wellons Realty**  
Contractor **W.S. Wellons Realty**

Project No. **33:6230-D**  
Report No. **2**  
Day & Date **Wednesday 7/12/2023**  
Weather **90 °/ Sunny**  
On-Site Time **1.75**  
Lab Time **0.00**  
Travel Time\* **0.00**  
Total **1.75**  
Re Obs Time **0.00**

Remarks					
Trip Charges*	Tolls/Parking*	Mileage*	Time of	Arrival	Departure
Chargeable Items				<b>1:30P</b>	<b>3:15P</b>

\* Travel time and mileage will be billed in accordance with the contract.

**Summary of Services Performed (field test data, locations, elevations & depths are estimates) & Individuals Contacted.**

ECS Representative arrived on site, as requested, to check the bearing capacity of soils via hand auger/DCP method (ASTMSTP-399) for foundation footings. Please see the attached sketch and data sheet for details.

A total of 4 hand auger/DCP evaluations were performed to a depth of approximately 3 feet below the current footing sub grade elevation. Test results indicated that the materials in place (at the locations and elevations tested) did appear to be suitable to support the design bearing capacity 2,000 psf.

ECS will return upon request.

Created with ScanWritr. To remove this watermark please use the upgrade options.

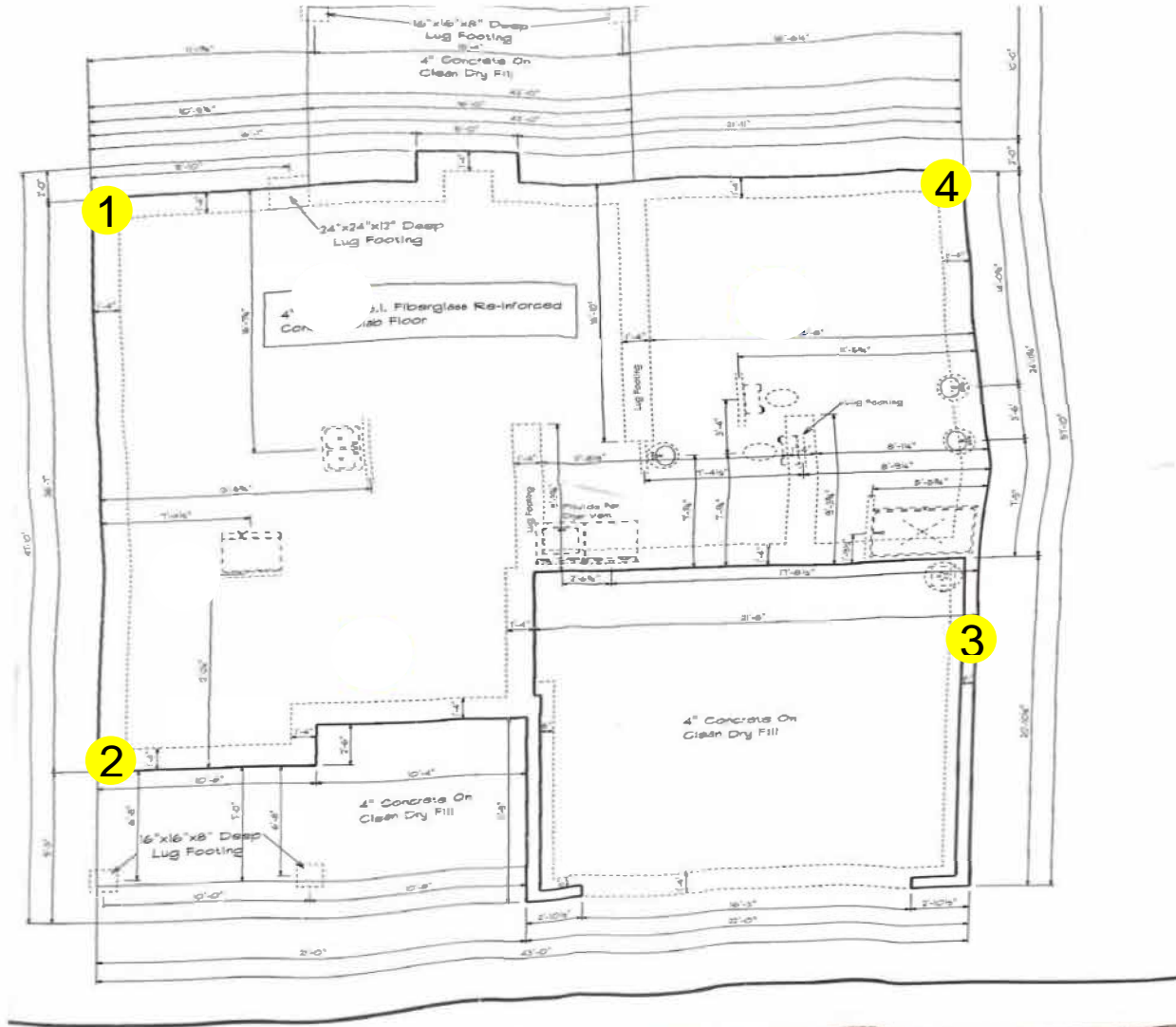

George Oxendine  
7/12/2023  
Lot 124 HLN  
Proj#:6230-D

**Key (NTS)**  
DCP Location

#



NORTH





## Report of Spread Footing - Foundation Observations

Project: Lot 124 HLN  
 Location: 41 Sugarberry Pl  
 Spring Lake - Cumberland - NC - 28390  
 Contractor: W.S. Wellons Realty

Project No.: 33:6230-D  
 Day/Date: 7/12/2023

Footing Number	Location	Size (W x H x L)		Footing Bottom Elevation		Description of Steel Placed	Description of Subgrade Material	Required Blow Counts # of Blows / Increment	Design Bearing Pressure
		Design	Actual	Design **	Depth of Undercut (in)				
1	N.W Corner	x x	x x	N/A			(0)/-3 Orange clay Sand 6 (0)3,4,5(-1)5,6,6(-2) 8,9,10(-3)10,11,10	2000	
2	S.W Corner	x x	x x	N/A			(0)/-3 Orange clay Sand 6 (0)5,4,5(-1)6,8,9(-2) 13,11,13(-3)11,11,8	2000	
3	S.E Corner	x x	x x	N/A			(0)/-3 Orange clay Sand 6 (0)2,4,5(-1)8,7,6(-2) 8,10,11(-3)8,5,7	2000	
3	N.E Corner	x x	x x	N/A			(0)/-3 Orange clay Sand 6 (0)3,5,5(-1)5,6,6(-2) 6,8,11(-3)5,7,7	2000	

\*\* SGE: Subgrade Elevation to be determined by surveyor.

By: George Pate Oxendine Jr.

ECS Southeast, LLP

WO: 73092