



ECS Southeast, LLP

6151 Raeford Road, Suite A
Fayetteville, NC 28304
9104013288
9103230539

LETTER OF TRANSMITTAL

June 26, 2023
W.S. Wellons Realty
PO Box 766
Spring Lake, NC 28390
ATTN: Chandler Jones

RE: **Lot 124 HLN**
ECS Job # **33:6230-D**

Permits:
Location: **41 Sugarberry PI**
Spring Lake, NC 28390

Field Reports For your use As requested

CC:

ENCL: Field Report # 1 6/23/2023

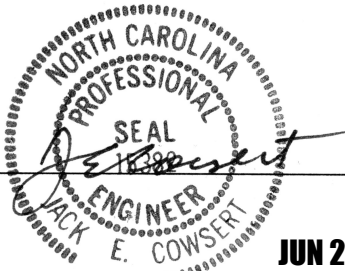

JUN 26 2023

Jack Cowsert, P.E.
Office Manager

Aaron Kyle Adair
Team Leader

Disclaimer

1. This report (and any attachments) shall not be reproduced except in full without prior written approval of ECS.
2. The information in this report relates only to the activities performed on the report date.
3. Where appropriate, this report includes statements as to compliance with applicable project drawings, and specifications for the activities, performed on this report date.
4. Incomplete or non-conforming work will be reported for future resolution.
5. The results of samples and/or specimens obtained or prepared for subsequent laboratory testing will be presented in separate reports/documents.



ECS Southeast, LLP
6151 Raeford Road, Suite A
Fayetteville, NC 28304
(910) 401-3288 [Phone]
(910) 323-0539 [Fax]

FIELD REPORT

Project **Lot 124 HLN**
Location **Spring Lake, NC**
Client **W.S. Wellons Realty**
Contractor **W.S. Wellons Realty**

Project No. **33:6230-D**
Report No. **1**
Day & Date **Friday 6/23/2023**
Weather **80 °/ Sunny**
On-Site Time **1.00**
Lab Time **0.00**
Travel Time* **0.00**
Total **1.00**
Re Obs Time **0.00**

Remarks

Trip Charges*	Tolls/Parking*	Mileage*	Time of Arrival	Departure
Chargeable Items			12:00P	1:00P

* Travel time and mileage will be billed in accordance with the contract.

Summary of Services Performed (field test data, locations, elevations & depths are estimates) & Individuals Contacted.

ECS arrived on site, as requested, to check the bearing capacity of soils via hand auger/DCP method (ASTM SPT-399) for preliminary observations.

A total of 3 hand auger/DCP evaluations were performed to a depth of approximately 3 feet below the current footing sub grade elevation. It is to the opinion of ECS that the materials in place (at the locations and elevations tested) did appear to be suitable to support the design bearing capacity 2,000 psf.

ECS will return upon request to provide additional services.

SI Created with ScanWritr. To remove this watermark please use the upgrade options.

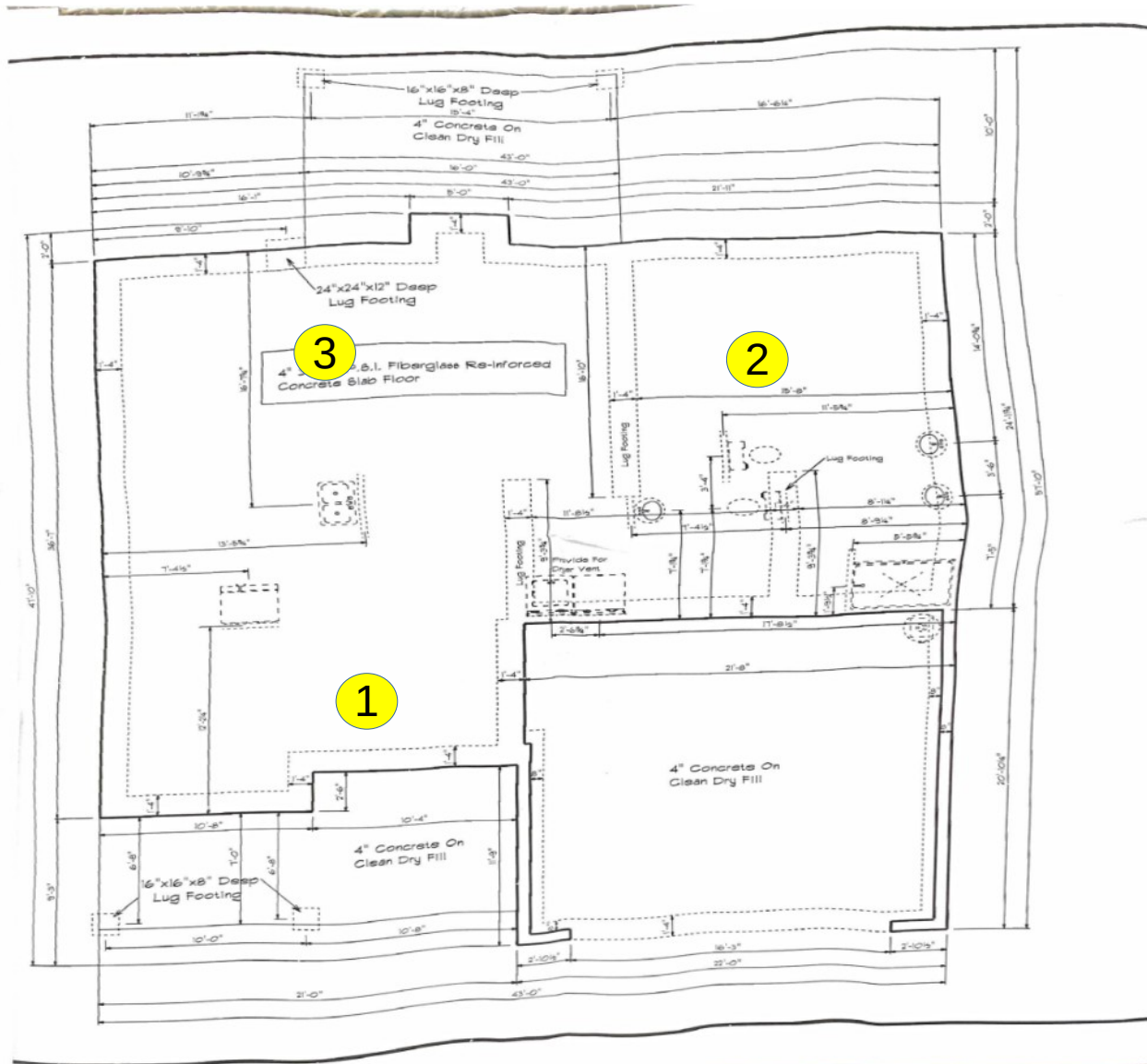

Sulaiman ShariEFF
6/23/2023
HLN lot 124
Proj #: 6230-D
W/O # 72826

Key (NTS)
DCP Location

#



NORTH



Attachments



IMG_0502[1]

Figure 1



Report of Spread Footing - Foundation Observations

Project: Lot 124 HLN
 Location: 41 Sugarberry Pl
 Spring Lake - Cumberland - NC - 28390
 Contractor: W.S. Wellons Realty

Project No.: 33:6230-D
 Day/Date: 6/23/2023

Footing Number	Location	Size (W x H x L)		Footing Bottom Elevation		Description of Steel Placed	Description of Subgrade Material	Required Blow Counts # of Blows / Increment	Design Bearing Pressure
		Design	Actual	Design **	Depth of Undercut (in)				
1	south	x x	x x	N/A	0,-1,-2,-3		(0,-1,-2) orange sand (-3) tan sand	6 (0) 5-5-5 (-1) 6-5-6 (-2) 15-16-16 (-3) 10-13-11	2000
2	north east	x x	x x	N/A	0,-1,-2,-3		(0,-1) orange sand(-2) brown sand (-3) tan sand	6 (0)5-5-7 (-1)11-15-17 (-2) 9-8-8 (-3) 9-7-8	2000
3	north west	x x	x x	N/A	0,-1,-2,-3		(0,-1) orange sand(-2) brown sand (-3) tan sand	6 (0)5-4-6 (-1)9-9-7 (-2)13 -11-10 (-3) 8-8-9	2000

** SGE: Subgrade Elevation to be determined by surveyor.

By: Sulaiman Sharieff

ECS Southeast, LLP

WO: 72826