

SOUTHEASTERN SOIL & ENVIRONMENTAL ASSOC., INC.

PROPOSED SUBSURFACE WASTE DISPOSAL SYSTEM DETAIL SHEET

SUBDIVISION: ROCKING SPRINGS

LOT .. 123

INITIAL SYSTEM: APPROVED 25% REDUCTION

REPAIR APPROVED 25% REDUCTION

DISTRIBUTION: D-BOX

DISTRIBUTION D-BOX

BENCHMARK: 100.0

LOCATION CONCRETE FC 123/124

NO. BEDROOMS: 4

LTAR 0.5 GPD/FT²

SEPTIC TANK SIZE 1000

PUMP TANK SIZE

LINE	FLAG COLOR	ELEVATION	LENGTH
1	W	97.92	60'
2	Y	97.00	60'
3	W	96.42	60'
4	Y	95.92	60'
			<u>240'</u>
5	W	95.17	60'
6	Y	94.58	60'
7	W	94.08	60'
8	Y	93.50	60'
			<u>240'</u>

*Installed
system*

BY M EAKER

DATE 11/2022

TYPICAL PROFILE

0-20 W
20-36 vt sec/sc
cr 2 > 36"
INSTALL AT 18"

**THERE SHALL BE NO GRADING,
 CUTTING, LOGGING OR OTHER SOIL
 DISTURBANCE IN SEPTIC AREA**

HEALTH DEPARTMENT USE ONLY.
 DESIGNS DO NOT GUARANTEE FUNCTIONALITY

Southeastern Soil & Environmental Associates, Inc.

P.O. Box 9321
 Fayetteville, NC 28311
 Phone/Fax (910) 822-4540
 Email mike@southeasternsoil.com

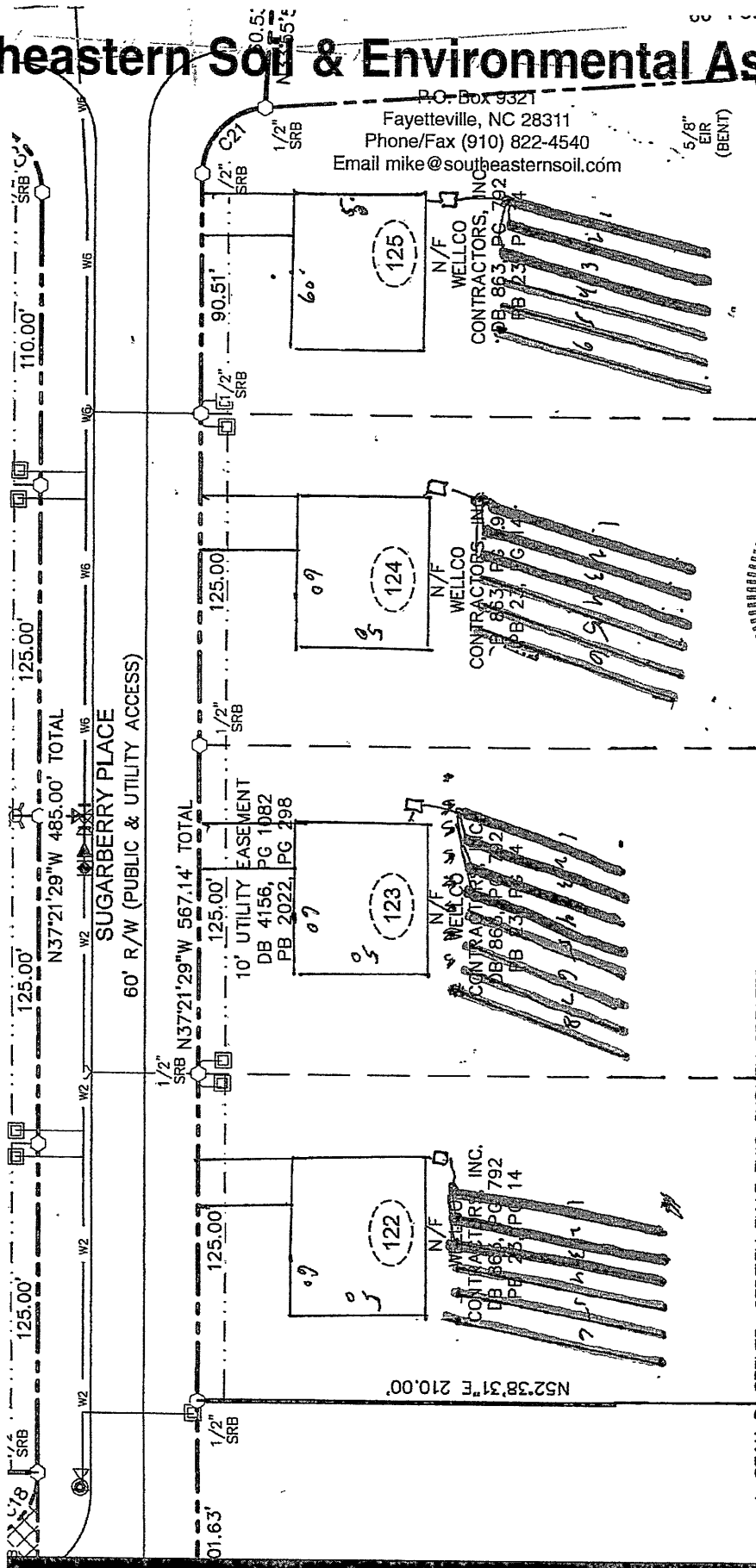

I, SEAN R. SEEVER, CERTIFY THAT THIS SURVEY CREATES A SUBDIVISION OF LAND WITHIN THE AREA OF A COUNTY OR MUNICIPALITY THAT HAS AN ORDINANCE THAT REGULATES PARCELS OF LAND.

Sean R. Seever

PROFESSIONAL LAND SURVEYOR - L-4571

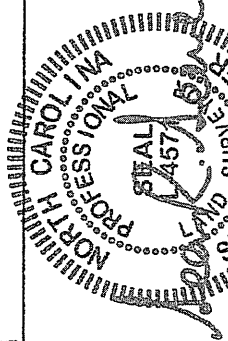

1" = 60'