

Preliminary Septic Proposal
 Donald and Kellie Stephens
 Lot #A- 3-Bedroom Septic Proposal
 Christian Light Road - Harnett County NC
 PIN# 0645-36-6598

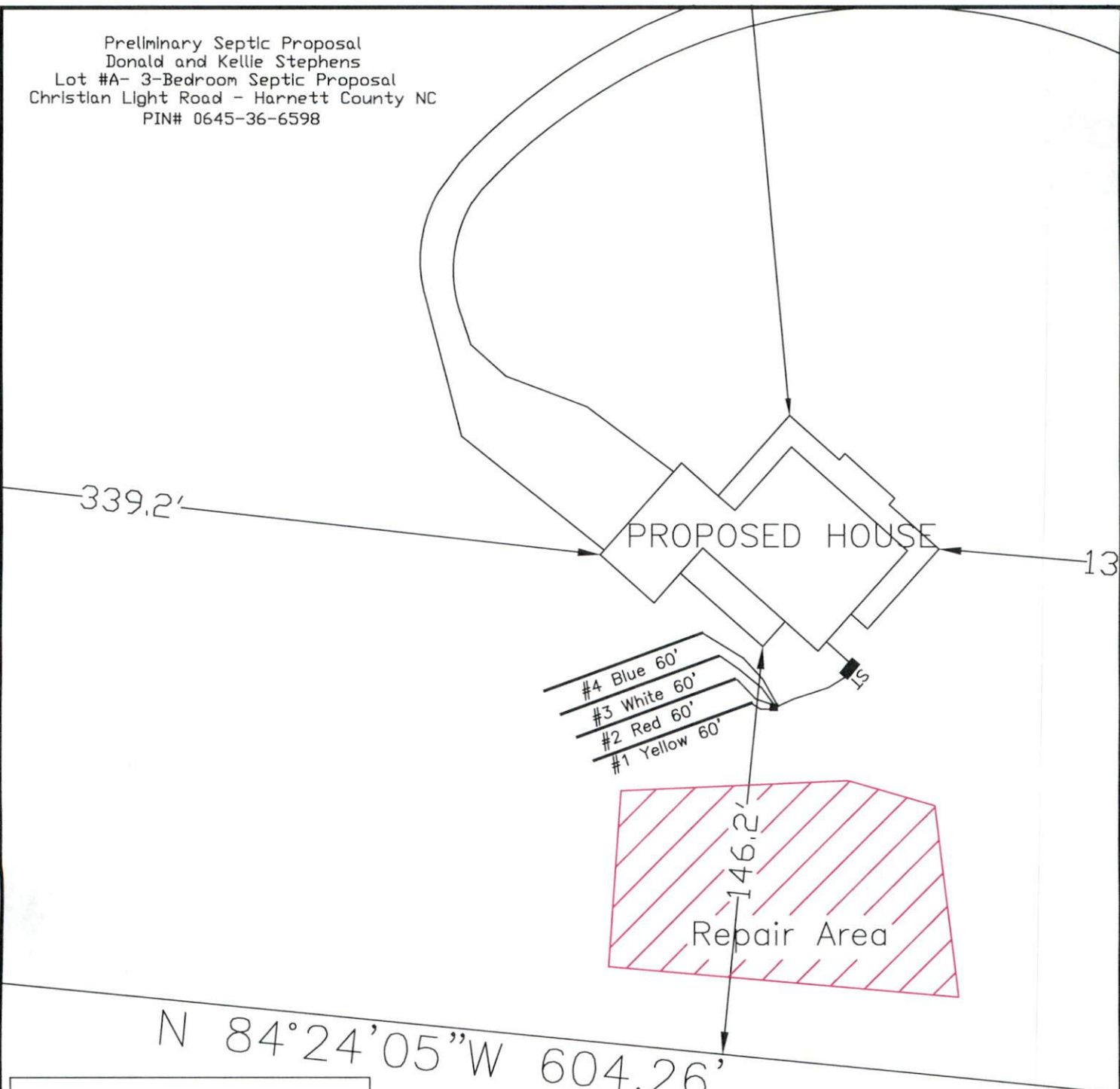

System: Gravity to D-Box
 Lines: 1-4 (240')
 0.4 LTAR
 18" Trench Bottom
 Accepted Status System
 Repair: Accepted Status
 ~10,000 sq. feet reserved
 0.4 LTAR
 24" Trench Bottom

GRAPHIC SCALE
 1" = 50'



Adams
 Soil Consulting
 919-414-6761
 Job #1516