

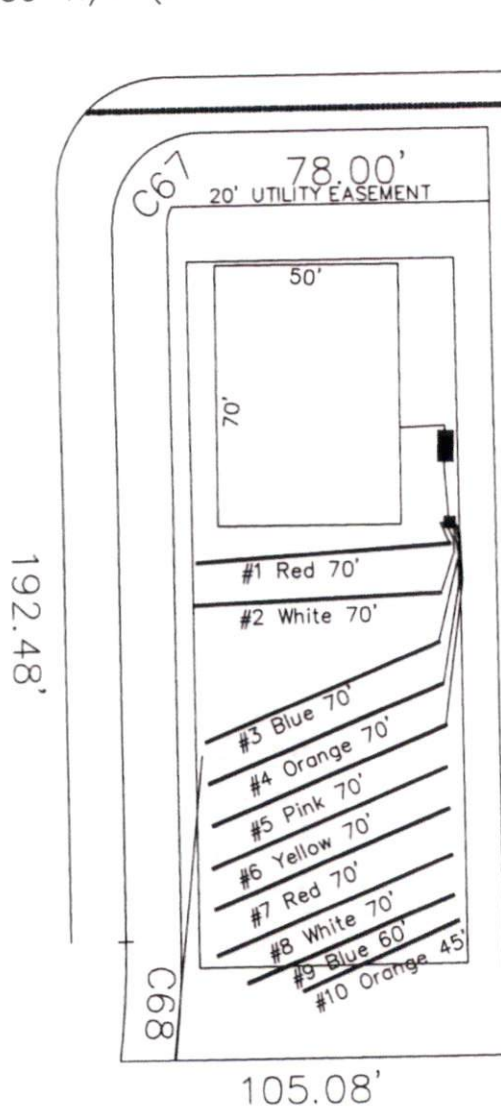



4-Bedroom Septic Plan  
 Lot #70 - Duncan's Crossing  
 Harnett County  
 Smith Douglas Homes

DOUBLE BARRELL STREET  
 50' R/W (PUBLIC & UTILITY ACCESS)



\*House footprint to be field staked by surveyor and system verified prior to any construction

\*\*Septic area must not be altered by construction activities.

\*\*\*No cuts of 2' or greater within 15' of septic area

\*\*\*\* Recommend protective barrier around septic field during construction.

70

25,638 SF  
 (0.59 AC)

\*If plumbing is not sufficient a pump tank will be required to septic field.

System: Gravity to D-Box  
 Lines: Lines 1-5 (350')  
 0.35 LTAR  
 24" Max Trench Bottom  
 Accepted Status System  
 Repair: Pressure Manifold  
 Lines: Lines 6-10 (315')  
 0.4 LTAR  
 24" Trench Bottom  
 Accepted Status System

GRAPHIC SCALE  
 1" = 50'



Adams  
 Soil Consulting  
 919-414-6761  
 Job #1146