

4-Bedroom Septic Plan
 Lot #77 – Duncan’s Crossing
 Harnett County
 Smith Douglas Homes

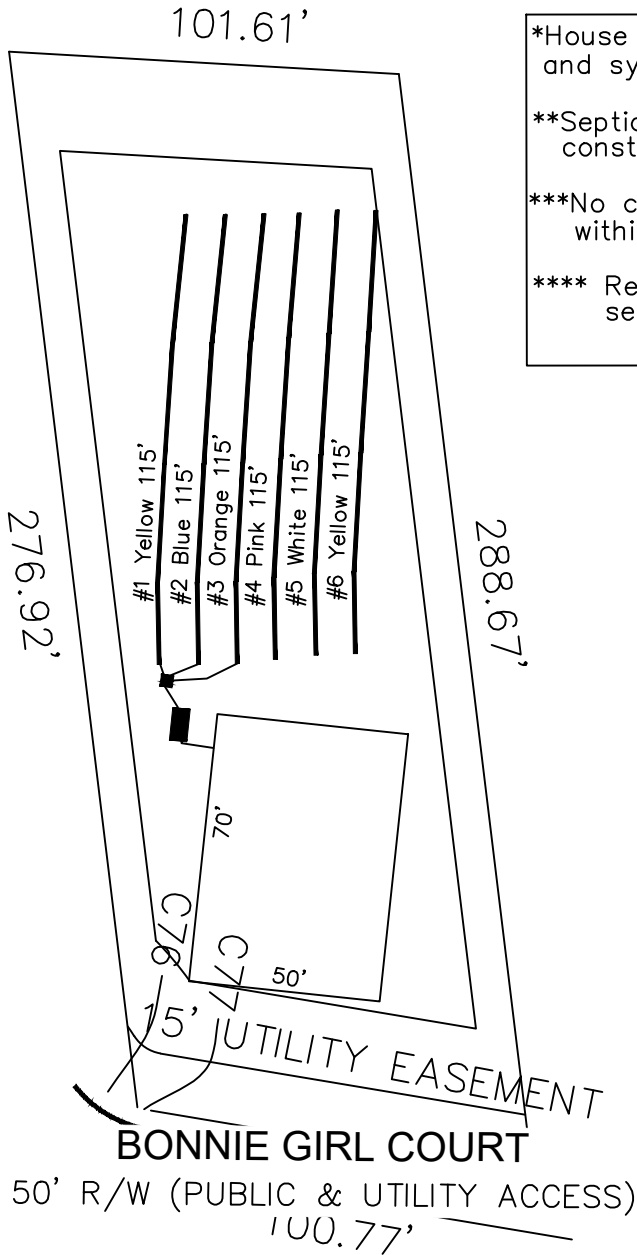

*House footprint to be field staked by surveyor and system verified prior to any construction

**Septic area must not be altered by construction activities.

***No cuts of 2' or greater within 15' of septic area

**** Recommend protective barrier around septic field during construction.



28,293 SF
 (0.65 AC)

*If plumbing is not sufficient a pump tank will be required to septic field.

System: Gravity to serial dist.
 Lines: Lines 1-3 (345')
 0.35 LTAR
 24" Max Trench Bottom
 Accepted Status System
 Repair: Gravity to D-Box
 Lines: Lines 4-6 (345')
 0.35 LTAR
 24" Trench Bottom
 Accepted Status System

GRAPHIC SCALE
 1" = 50'



Adams
 Soil Consulting
 919-414-6761
 Job #1146