

- *Keep tanks and drain lines 10' from property lines.
- *Not a survey.
- *Not a guarantee of a septic permit.
- *Keep supply lines >5' from property lines.
- *Some lines are flagged longer in the field than lengths indicate.
- *No grading septic area.

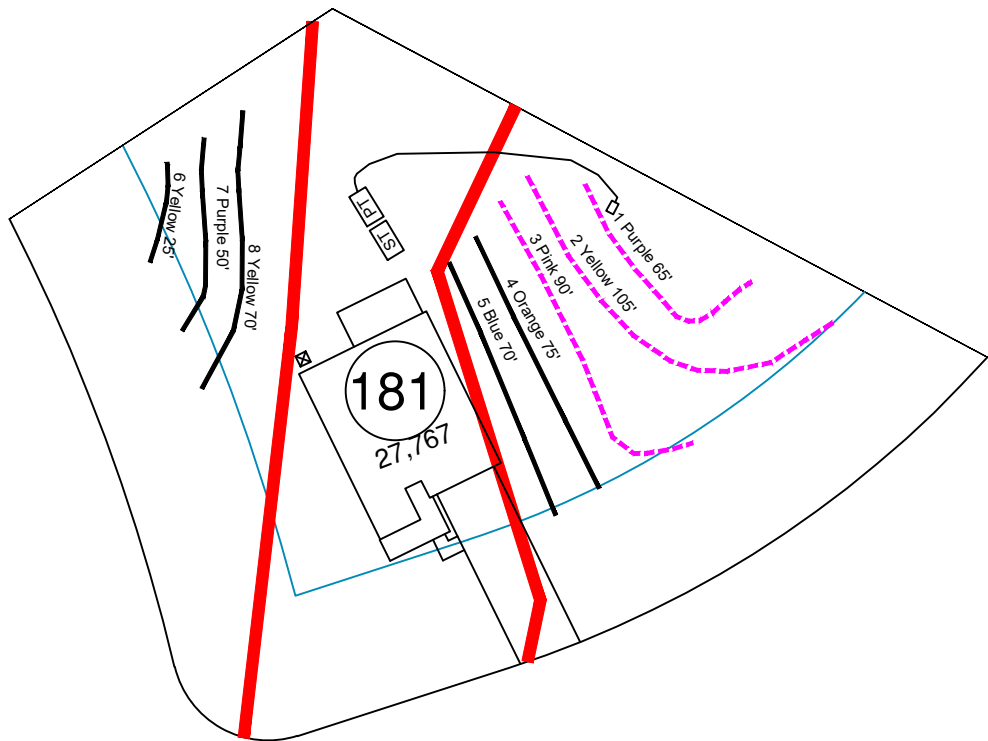

System:
 Repair:

System: Pressure Manifold Lines: 1-3, (260') Accepted Status System 0.35 Soil LTAR
Repair: Pressure Manifold Lines: 4-8, (290') Accepted Status System 0.35 Soil LTAR

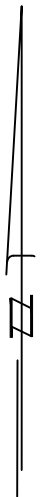
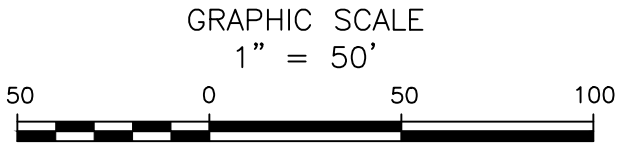

Central Carolina Soil Consulting, PLLC
 1900 South Main Street, Suite 110
 Wake Forest, North Carolina 27587
 Phone (919)569-6704 Fax (919)569-6703

3-Bedroom Septic Layout
 Lot 181, Birchwood Subdivision
 Harnett County, North Carolina

Job# : 3753
Drawn By : AH
Date : 11/14/2022
Revision:

Birchwood S/D Lot 181 TAP CHART

Bench Mark						Elevation Head		2.80	
Pump tank elev.			100.00	Pump elev.		94.60	Manifold elev.		97.40
line	color	rod read	Elevation	length	hole size	flow/tap	gal/day	trench area	LINE LTAR
1	Purple	3.60	96.40	65	1/2in SCH 40	7.11	86.15	195	0.4418
2	Yellow	3.90	96.10	105	3/4in SCH 40	12.5	151.46	315	0.4808
3	Pink	4.10	95.90	90	3/4in SCH 80	10.1	122.38	270	0.4533

	total	feet =	260	gal/min =	29.71	LTAR =	0.3500
						LTAR + %5	0.3675
% of Dose Vol.	75		Des. Flow	360		(ltar W/ INOV)	0.4667
Dose Volume	126.75		Pump Run=	12.12		(ltar W/ INOV + 5%)	0.4900
Dose Pump Time	4.27		Tank Gal/IN	20			
Drawdown in Inches	6.34						

Birchwood S/D Lot 181 Repair TAP CHART

Bench Mark						Elevation Head		2.20	
Pump tank elev.			100.00	Pump elev.		94.60	Manifold elev.		96.80
line	color	rod read	Elevation	length	hole size	flow/tap	gal/day	trench area	LINE LTAR
4	Orange	4.20	95.80	75	1/2in SCH 40	7.11	90.00	225	0.4000
5	Blue	4.60	95.40	70	1/2in SCH 40	7.11	90.00	210	0.4286
6&7	Y/PU	4.30	95.70	75	1/2in SCH 40	7.11	90.00	225	0.4000
8	Purple	4.90	95.10	70	1/2in SCH 40	7.11	90.00	210	0.4286

	total	feet =	290	gal/min =	28.44	LTAR =	0.3500
						LTAR + %5	0.3675
			Des. Flow	360		(ltar W/ Panel)	0.4667
			Pump Run=	12.66		(ltar W/ INOV + 5%)	0.4900
			Tank Gal/IN	20			