

Engineering
Lech
 ASSOCIATES, P.A.

STRUCTURAL ENGINEERS
 License No. C-3870
 318 W Millbrook Rd. Unit 201
 Raleigh, North Carolina 27609
 Phone (919) 844-1661

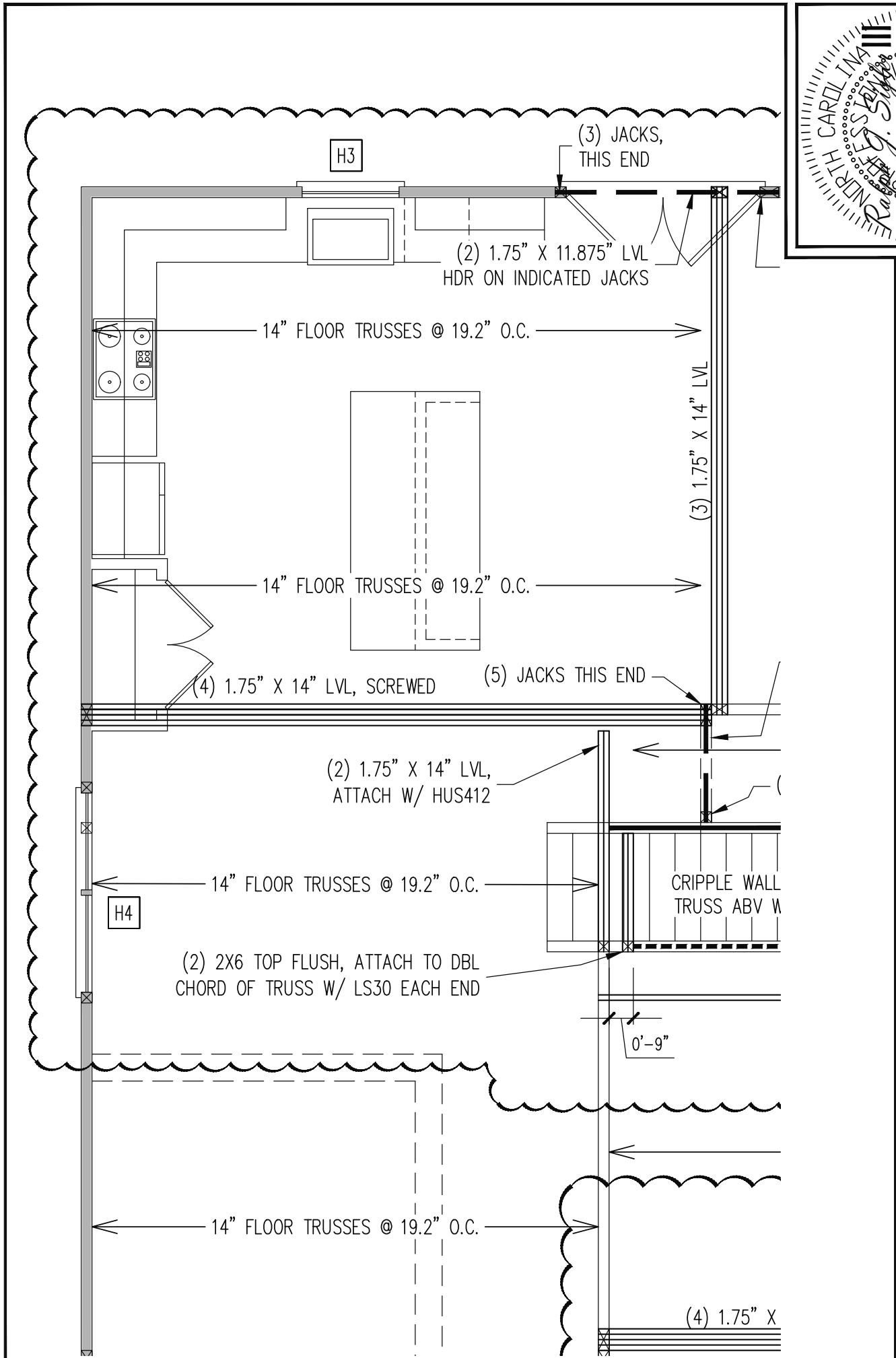

BQUEST	
SCOPE	LVL LAYOUT CLARIFICATION
LOC	1050 W. STRICKLAND RD
REV #	REF PROJ #
DATE	

ENG: RJS/CR
 DATE: 1/19/2023

PARENT
 22-18-275

PROJECT NO.
 23-75-059

SHEET NO.
 SL1

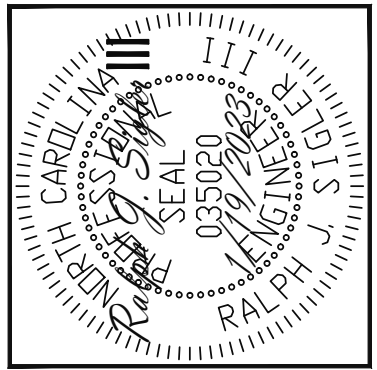
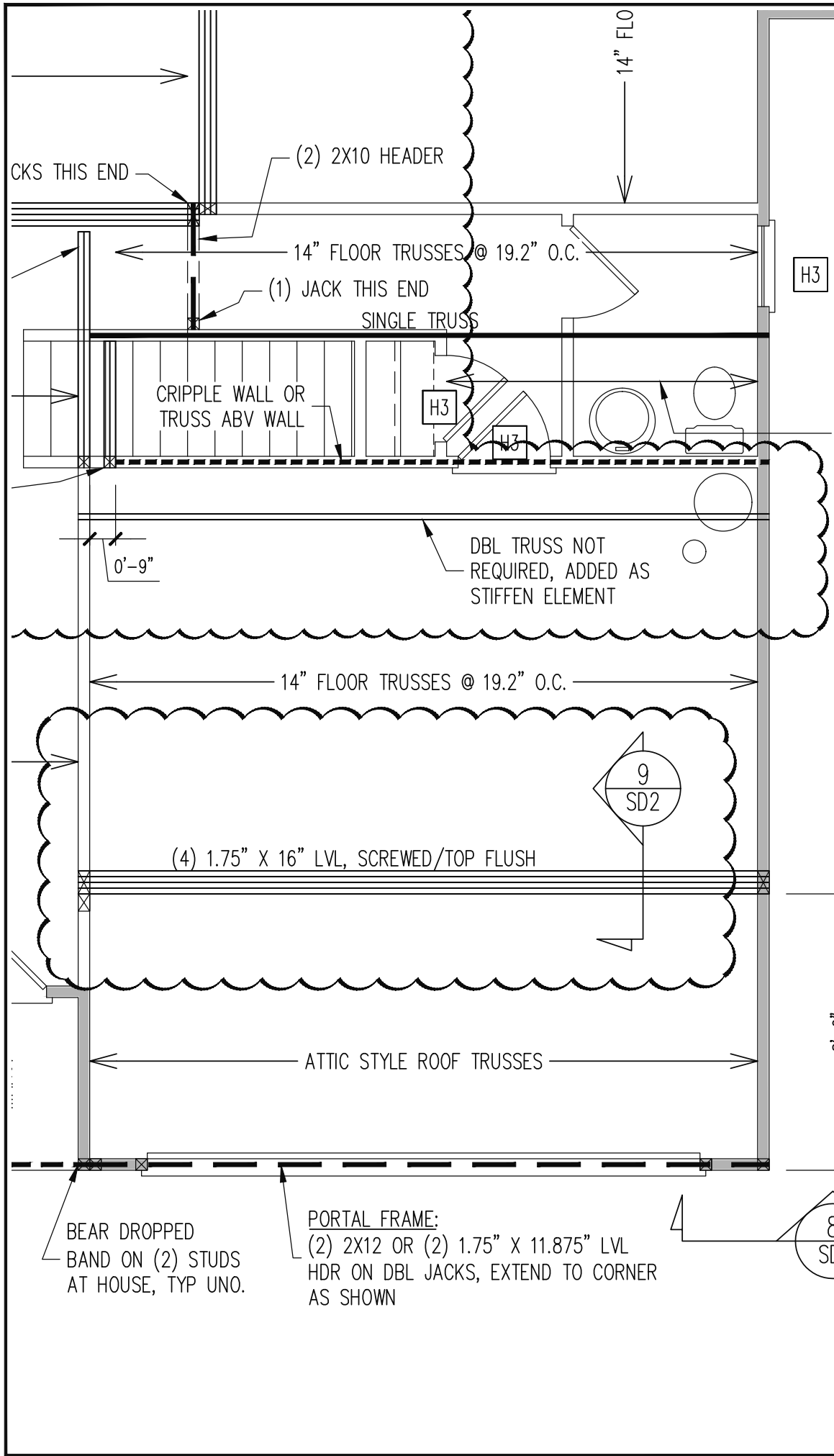

Engineering
Lech
 ASSOCIATES, P.A.

STRUCTURAL ENGINEERS
 License No. C-3870
 318 W Millbrook Rd. Unit 201
 Raleigh, North Carolina 27609
 Phone (919) 844-1661

BQUEST	
SCOPE	LVL LAYOUT CLARIFICATION
LOC	1050 W. STRICKLAND RD
REV #	REF PROJ #
DATE	

ENG: RJS/CR
 DATE: 1/19/2023

PARENT
 22-18-275

PROJECT NO.
 23-75-059

SHEET NO.
 SL2