

1149 Denning Road 3-Bedroom Septic Proposal On Tops Building

PERMIT NUMBER 2210-0015 **REVISION**

*If plumbing is sufficiently then a pump and pump tank may not be required.

*Not a Survey
Sketched from a plot plan supplied by owner

System: Pump to D-Box
Lines: 3-5 (255')
0.35 LTAR
12-15" Max Trench Bottom
Accepted Status System
Repair: T&J Panel Block - 50% reduction
Lines: 1-2 (170')
0.35 LTAR
14" Max Trench Bottom

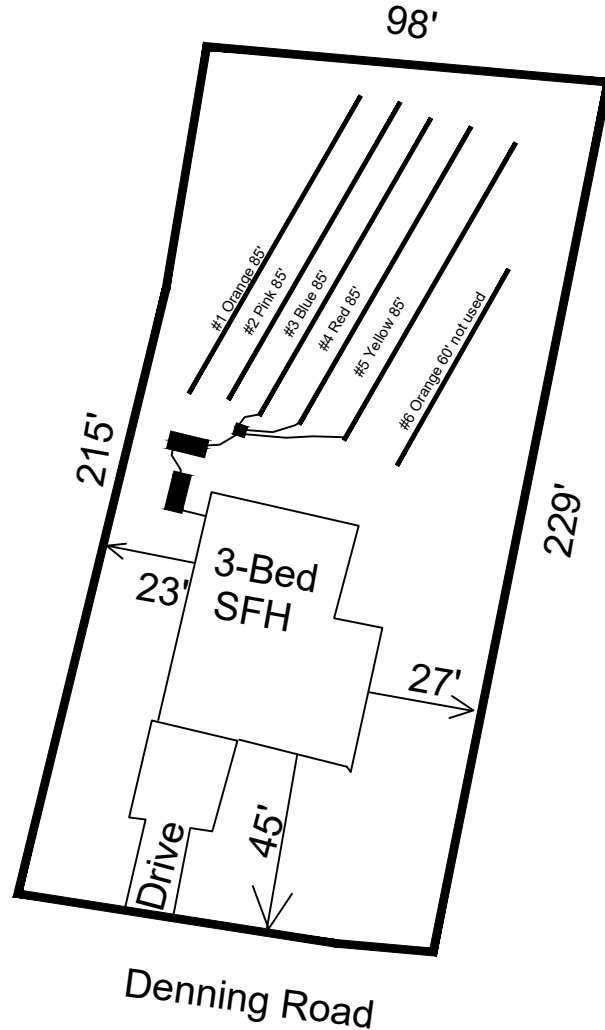

****1000 Gallon Septic Tank**
Tank and trenches to be located minimum of 10'
from any property line and minimum of 5'
from any building foundation.
*Do Not Cut, Fill, or Alter Drainfield or Repair Area
*Comply with all setbacks

Adams
Soil Consulting
919-414-6761
Job #1538

GRAPHIC SCALE
1" = 50'



DocuSigned by:
Michael Ford
03CE83D6A2D946C...