

Initial Application Date: 3.10.2023

Application # \_\_\_\_\_

CU# \_\_\_\_\_

COUNTY OF HARNETT RESIDENTIAL LAND USE APPLICATION

Central Permitting 420 McKinney Pkwy, Lillington, NC 27546 Phone: (910) 893-7525 ext:1 Fax: (910) 893-2793 www.harnett.org/permits

\*\*A RECORDED SURVEY MAP, RECORDED DEED (OR OFFER TO PURCHASE) & SITE PLAN ARE REQUIRED WHEN SUBMITTING A LAND USE APPLICATION\*\*

LANDOWNER: On Top Building Co., LLC Mailing Address: 2393 Twin Acres Rd.
City: Clayton State: NC Zip: 27520 Contact No: 919.201.1133 Email: ontopbuildingcompany@gmail.com

APPLICANT\*: On Top Building Co., LLC Mailing Address: 2393 Twin Acres Rd.
City: Clayton State: NC Zip: 27520 Contact No: 919.201.1133 Email: ontopbuildingcompany@gmail.com
\*Please fill out applicant information if different than landowner

ADDRESS: 1171 Denning Rd., Angier NC 27501 PIN: 1602.11.4613.000

Zoning: RA-30 Flood: Minimal Watershed: S.Coastal Deed Book / Page: 4153:1577

Setbacks - Front: 35' Back: 25' Side: 10' Corner: 10'

PROPOSED USE:

SFD: (Size 60 x 60) # Bedrooms: 3 # Baths: 2.5 Basement(w/wo bath): Garage: Deck: Crawl Space: Slab: Slab:
TOTAL HTD SQ FT 1608 GARAGE SQ FT 484 (Is the bonus room finished? ( ) yes ( ) no w/ a closet? ( ) yes ( ) no (if yes add in with # bedrooms)

Modular: (Size x ) # Bedrooms # Baths Basement (w/wo bath) Garage: Site Built Deck: On Frame Off Frame
TOTAL HTD SQ FT (Is the second floor finished? ( ) yes ( ) no Any other site built additions? ( ) yes ( ) no

Manufactured Home: SW DW TW (Size x ) # Bedrooms: Garage: (site built?) Deck: (site built?)

Duplex: (Size x ) No. Buildings: No. Bedrooms Per Unit: TOTAL HTD SQ FT

Home Occupation: # Rooms: Use: Hours of Operation: #Employees:

Addition/Accessory/Other: (Size x ) Use: Closets in addition? ( ) yes ( ) no
TOTAL HTD SQ FT GARAGE

Water Supply: County Existing Well New Well (# of dwellings using well ) \*Must have operable water before final
(Need to Complete New Well Application at the same time as New Tank)

Sewage Supply: New Septic Tank Expansion Relocation Existing Septic Tank County Sewer
(Complete Environmental Health Checklist on other side of application if Septic)

Does owner of this tract of land, own land that contains a manufactured home within five hundred feet (500') of tract listed above? ( ) yes ( ) no

Does the property contain any easements whether underground or overhead ( ) yes ( ) no

Structures (existing or proposed): Single family dwellings: Manufactured Homes: Other (specify):

If permits are granted I agree to conform to all ordinances and laws of the State of North Carolina regulating such work and the specifications of plans submitted. I hereby state that foregoing statements are accurate and correct to the best of my knowledge. Permit subject to revocation if false information is provided.

Blandie Robertson
Signature of Owner or Owner's Agent

3.10.2023
Date

\*\*\*It is the owner/applicants responsibility to provide the county with any applicable information about the subject property, including but not limited to: boundary information, house location, underground or overhead easements, etc. The county or its employees are not responsible for any incorrect or missing information that is contained within these applications.\*\*\*
\*This application expires 6 months from the initial date if permits have not been issued\*\*

APPLICATION CONTINUES ON BACK

**\*\*This application expires 6 months from the initial date if permits have not been issued\*\***

**\*This application to be filled out when applying for a septic system inspection.\***

**County Health Department Application for Improvement Permit and/or Authorization to Construct**

IF THE INFORMATION IN THIS APPLICATION IS FALSIFIED, CHANGED, OR THE SITE IS ALTERED, THEN THE IMPROVEMENT PERMIT OR AUTHORIZATION TO CONSTRUCT SHALL BECOME INVALID. The permit is valid for either 60 months or without expiration depending upon documentation submitted. (Complete site plan = 60 months; Complete plat = without expiration)

**Environmental Health New Septic System**

- **All property irons must be made visible.** Place "pink property flags" on each corner iron of lot. All property lines must be clearly flagged approximately every 50 feet between corners.
- Place "orange house corner flags" at each corner of the proposed structure. Also flag driveways, garages, decks, out buildings, swimming pools, etc. Place flags per site plan developed at/for Central Permitting.
- Place orange Environmental Health card in location that is easily viewed from road to assist in locating property.
- If property is thickly wooded, Environmental Health requires that you clean out the undergrowth to allow the soil evaluation to be performed. Inspectors should be able to walk freely around site. **Do not grade property.**
- **All lots to be addressed within 10 business days after confirmation. \$25.00 return trip fee may be incurred for failure to uncover outlet lid, mark house corners and property lines, etc. once lot confirmed ready.**

**Environmental Health Existing Tank Inspections**

- Follow above instructions for placing flags and card on property.
- Prepare for inspection by removing soil over **outlet end** of tank as diagram indicates, and lift lid straight up (*if possible*) and then **put lid back in place.** (Unless inspection is for a septic tank in a mobile home park)
- **DO NOT LEAVE LIDS OFF OF SEPTIC TANK**

**"MORE INFORMATION MAY BE REQUIRED TO COMPLETE ANY INSPECTION"**

**SEPTIC**

If applying for authorization to construct please indicate desired system type(s): can be ranked in order of preference, must choose one.

- Accepted     
  Innovative     
  Conventional     
  Any  
 Alternative     
  Other \_\_\_\_\_

The applicant shall notify the local health department upon submittal of this application if any of the following apply to the property in question. If the answer is "yes", applicant **MUST ATTACH SUPPORTING DOCUMENTATION**:

- YES     NO    Does the site contain any Jurisdictional Wetlands?  
 YES     NO    Do you plan to have an irrigation system now or in the future?  
 YES     NO    Does or will the building contain any drains? Please explain. \_\_\_\_\_  
 YES     NO    Are there any existing wells, springs, waterlines or Wastewater Systems on this property?  
 YES     NO    Is any wastewater going to be generated on the site other than domestic sewage?  
 YES     NO    Is the site subject to approval by any other Public Agency?  
 YES     NO    Are there any Easements or Right of Ways on this property?  
 YES     NO    Does the site contain any existing water, cable, phone or underground electric lines?  
 If yes please call No Cuts at 800-632-4949 to locate the lines. This is a free service.

**I Have Read This Application And Certify That The Information Provided Herein Is True, Complete And Correct. Authorized County And State Officials Are Granted Right Of Entry To Conduct Necessary Inspections To Determine Compliance With Applicable Laws And Rules. I Understand That I Am Solely Responsible For The Proper Identification And Labeling Of All Property Lines And Corners And Making The Site Accessible So That A Complete Site Evaluation Can Be Performed.**

1171 Denning Road  
 3-Bedroom Septic Proposal  
 On Tops Building

Permit 2210-0014

Revision

\*Not a Survey  
 Sketched from a plot plan supplied by owner

System: Gravity to D-Box  
 Lines: 2-5 (275')  
 0.35 LTAR  
 18" Max Trench Bottom  
 Accepted Status System  
 Repair: T&J Panel Block - 50% reduction  
 Lines: 1,6-7 (165')  
 0.375 LTAR  
 18" Max Trench Bottom

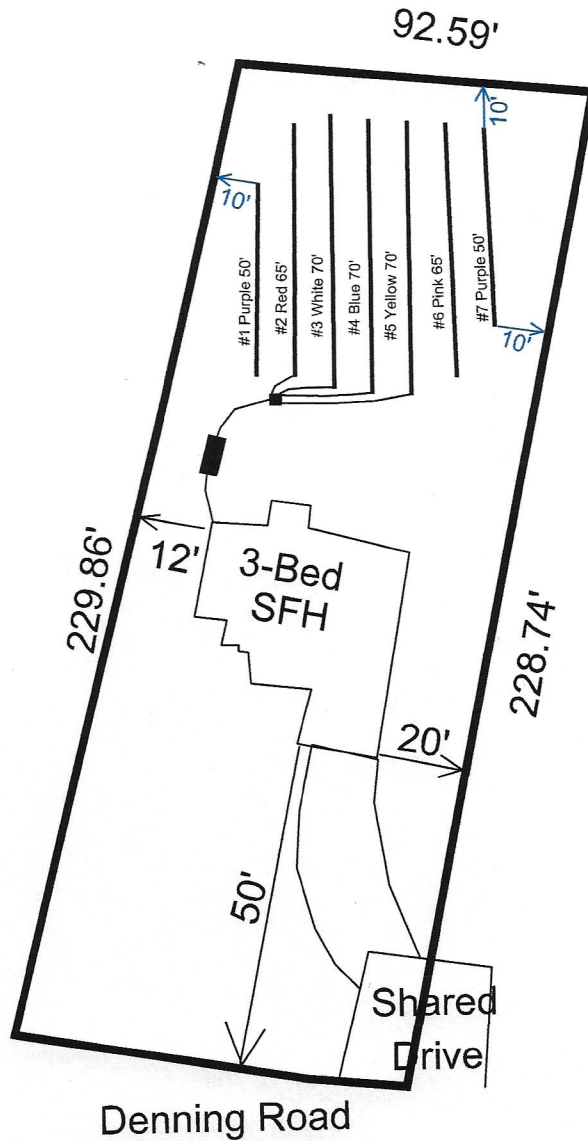

Denning Road

\*\*1000 Gallon Septic Tank  
 Tank and trenches to be located minimum of 10'  
 from any property line and minimum of 5'  
 from any building foundation.  
 \*Do Not Cut, Fill, or Alter Drainfield or Repair Area  
 \*Comply with all setbacks

Adams  
 Soil Consulting  
 919-414-6761  
 Job #1538

GRAPHIC SCALE  
 1" = 50'

