

1191 Denning Road
 3-Bedroom Septic Proposal
 On Tops Building

*Not a Survey
 Sketched from a plot plan supplied by owner

System: Serial Dist.
 Lines: 1-3 (240')
 0.375 Installation LTAR
 18" Max Trench Bottom
 Accepted Status System
 Repair: T&J Panel Block - 50% reduction
 Lines: 4-6 (170')
 0.35 Instalatoin LTAR
 14" Max Trench Bottom

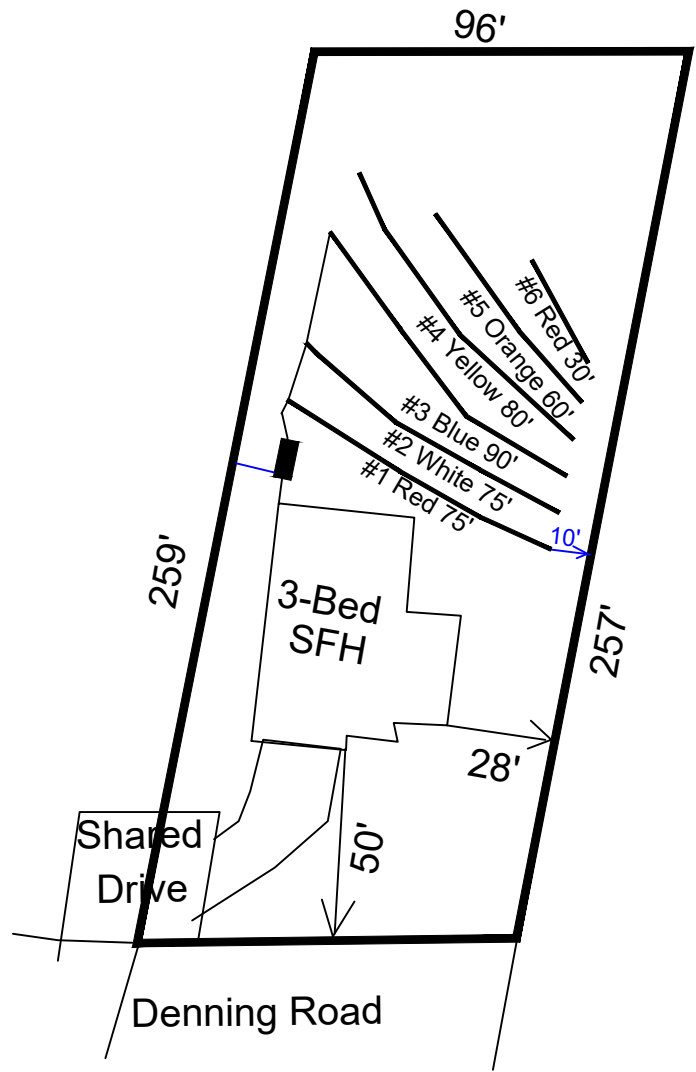

**1000 Gallon Septic Tank
 Tank and trenches to be located minimum of 10'
 from any property line and minimum of 5'
 from any building foundation.
 *Do Not Cut, Fill, or Alter Drainfield or Repair Area
 *Comply with all setbacks

Adams
 Soil Consulting
 919-414-6761
 Job #1538

GRAPHIC SCALE
 1" = 50'

