



ECS Southeast, LLP

6151 Raeford Road, Suite A
Fayetteville, NC 28304
9104013288
9103230539

LETTER OF TRANSMITTAL

October 24, 2022
Precision Custom Homes

Raeford, NC 28376
ATTN: Shaun Gardner

RE: **Liberty Meadows Lot 37**
ECS Job # **33:6122-K**

Permits:
Location: **52 Hancock Ct.**
Cameron, NC 28326

<input checked="" type="checkbox"/>	Field Reports	<input checked="" type="checkbox"/>	For your use	<input checked="" type="checkbox"/>	As requested
CC:	Precision Custom Homes - Allen Peterson		Precision Custom Homes - Lauren Ceruti		
ENCL:	Field Report # 1	10/21/2022			



OCT 24 2022

Jack Cowser, P.E.
Office Manager

Aaron Adair
Team Leader

Disclaimer

1. This report (and any attachments) shall not be reproduced except in full without prior written approval of ECS.
2. The information in this report relates only to the activities performed on the report date.
3. Where appropriate, this report includes statements as to compliance with applicable project drawings, and specifications for the activities, performed on this report date.
4. Incomplete or non-conforming work will be reported for future resolution.
5. The results of samples and/or specimens obtained or prepared for subsequent laboratory testing will be presented in separate reports/documents.



ECS Southeast, LLP
 6151 Raeford Road, Suite A
 Fayetteville, NC 28304
 (910) 401-3288 [Phone]
 (910) 323-0539 [Fax]

FIELD REPORT

Project **Liberty Meadows Lot 37**
 Location **Cameron, NC**
 Client **Precision Custom Homes**
 Contractor **Precision Custom Homes**

Project No. **33:6122-K**
 Report No. **1**
 Day & Date **Friday 10/21/2022**
 Weather **66 °/ Sunny**
 On-Site Time **1.50**
 Lab Time **0.00**
 Travel Time* **0.00**
 Total **1.50**
 Re Obs Time **0.00**

Remarks

Trip Charges*	Tolls/Parking*	Mileage*	Time of Arrival	Departure
Chargeable Items			12:00P	1:30P

* Travel time and mileage will be billed in accordance with the contract.

Summary of Services Performed (field test data, locations, elevations & depths are estimates) & Individuals Contacted.

ECS arrived on site, as requested, to check the bearing capacity of soils via hand auger/DCP method for the monolithic slab area for 52 Hancock Ct. - Lot 37. Please see the attached sketch and data sheet for details.

A hand auger was used to advance the boreholes to different depths noted on the boring logs. Dynamic Cone Penetrometer (DCP) test were performed in the hand auger boreholes by a 1.5 inch diameter cone driven into the soil by a 15 pound ring weight with a free fall of 20 inches. The number of blows required to drive the cone into the soil a distance of 1.75 inches is termed the DCP Value and is indicated for each test on the hand auger.

A total of 4 hand auger/DCP evaluations were performed to a depth of approximately 3 feet below the current footing sub grade elevation. Test results indicated that the materials in place , at the locations and elevations tested, did appear to be suitable to support the design bearing capacity 2,000 psf.

ECS will return upon request.

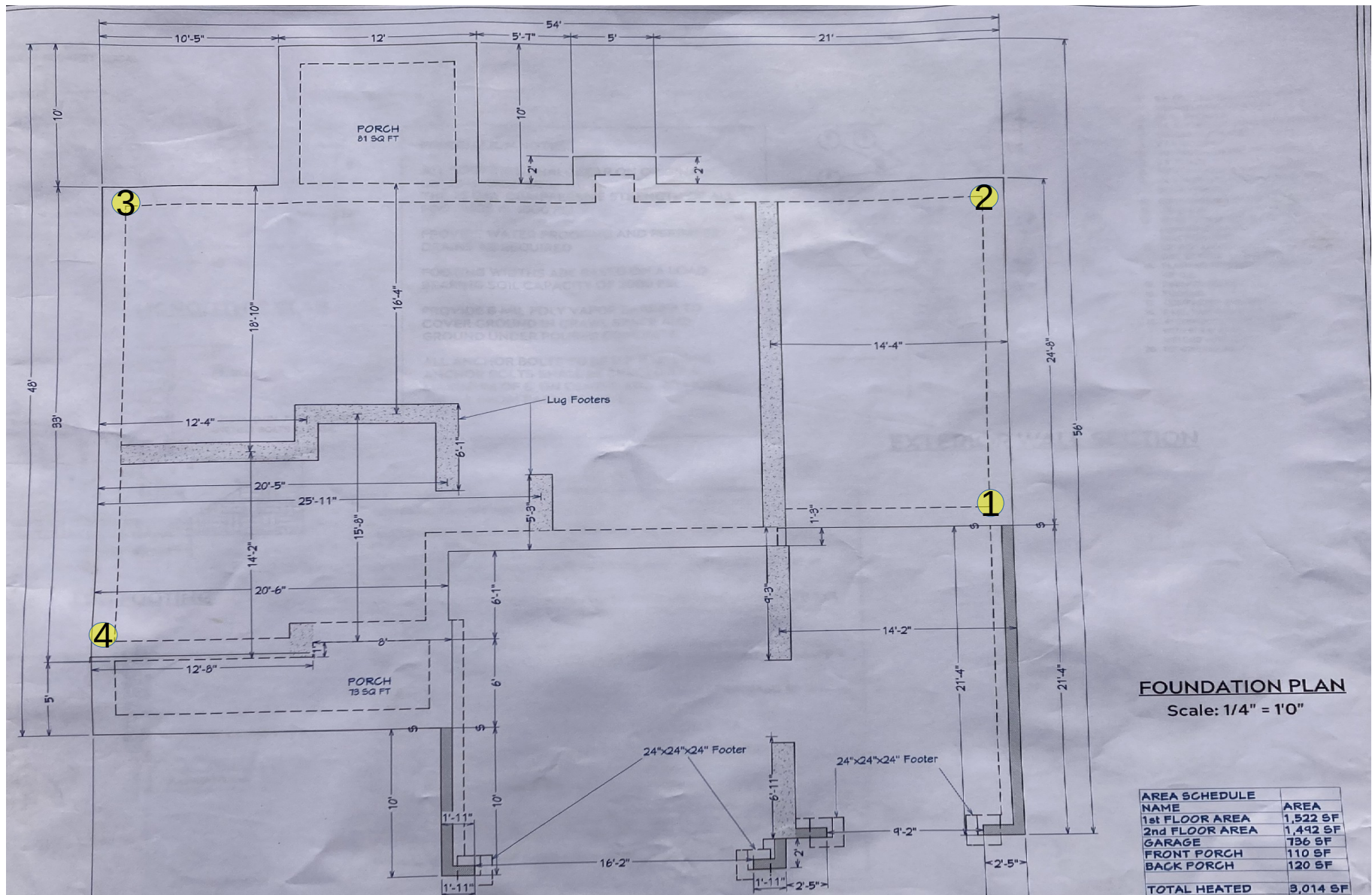

Todd T. Davis
10/21/2022
52 Hancock Ct. - Lot 37
Proj #: 6122-K
W/O # 69382

Key (NTS)
DCP / Hand Auger
Test Locations --- #





Todd T. Davis
10/21/2022
52 Hancock Ct. - Lot 37
Proj #: 6122-K
W/O # 69382

Key (NTS)
View of 52 Hancock Ct. - Lot 37





Report of Spread Footing - Foundation Observations

Project: Liberty Meadows Lot 37
 Location: 52 Hancock Ct.
Cameron - Harnett - NC - 28326
 Contractor: Precision Custom Homes

Project No.: 33:6122-K
 Day/Date: 10/21/2022

Footing Number	Location	Size (W x H x L)		Footing Bottom Elevation		Description of Steel Placed	Description of Subgrade Material	Required Blow Counts	Design Bearing Pressure
		Design	Actual	Design **	Depth of Undercut (in)			# of Blows / Increment	
1	See Attached Drawing	x x	x x	N/A	N/A		(0) Tan-Orange Silty Sand (1) Tan Silty Sand (2-3) Tan-Orange Clayey Sand	6	2000
								(0) 5,6,7 (1) 12,15,17 (2) 10,12,13 (3) 13,15,16	
2	See Attached Drawing	x x	x x	N/A	N/A		(0) Tan-Orange Silty Sand (1) Tan Silty Sand (2-3) Tan-Orange Clayey Sand	6	2000
								(0) 6,7,8 (1) 14,17,19 (2) 10,10,11 (3) 10,13,15	
3	See Attached Drawing	x x	x x	N/A	N/A		(0) Tan-Orange Silty Sand (1) Tan Silty Sand (2-3) Tan-Orange Clayey Sand	6	2000
								(0) 7,8,9 (1) 12,15,18 (2) 9,10,12 (3) 12,13,16	
4	See Attached Drawing	x x	x x	N/A	N/A		(0) Tan-Orange Silty Sand (1) Tan Silty Sand (2-3) Tan-Orange Clayey Sand	6	2000
								(0) 5,7,8 (1) 12,15,17 (2) 9,10,13 (3) 12,15,17	

** SGE: Subgrade Elevation to be determined by surveyor.



Report of Spread Footing - Foundation Observations

Project: Liberty Meadows Lot 37
Location: 52 Hancock Ct.
Cameron - Harnett - NC - 28326
Contractor: Precision Custom Homes

Project No.: 33:6122-K
Day/Date: 10/21/2022

By: Todd Davis

ECS Southeast, LLP

WO: 69382