



ECS Southeast, LLP

6151 Raeford Road, Suite A
Fayetteville, NC 28304
9104013288
9103230539

LETTER OF TRANSMITTAL

October 24, 2022
Precision Custom Homes

Raeford, NC 28376
ATTN: Shaun Gardner

RE: **Liberty Meadows Lot 40**
ECS Job # **33:6122-L**

Permits:
Location: **389 Solomon Dr**
Cameron, NC 28326

	<input checked="" type="checkbox"/>	Field Reports	<input checked="" type="checkbox"/>	For your use	<input checked="" type="checkbox"/>	As requested
CC:		Precision Custom Homes - Allen Peterson		Precision Custom Homes - Lauren Ceruti		

ENCL: Field Report # 1 10/21/2022



OCT 24 2022

Jack Cowsert, P.E.
Office Manager

Aaron Adair
Team Leader

Disclaimer

1. This report (and any attachments) shall not be reproduced except in full without prior written approval of ECS.
2. The information in this report relates only to the activities performed on the report date.
3. Where appropriate, this report includes statements as to compliance with applicable project drawings, and specifications for the activities, performed on this report date.
4. Incomplete or non-conforming work will be reported for future resolution.
5. The results of samples and/or specimens obtained or prepared for subsequent laboratory testing will be presented in separate reports/documents.



ECS Southeast, LLP
 6151 Raeford Road, Suite A
 Fayetteville, NC 28304
 (910) 401-3288 [Phone]
 (910) 323-0539 [Fax]

FIELD REPORT

Project **Liberty Meadows Lot 40**
 Location **Cameron, NC**
 Client **Precision Custom Homes**
 Contractor **Precision Custom Homes**

Project No. **33:6122-L**
 Report No. **1**
 Day & Date **Friday 10/21/2022**
 Weather **66 °/ Sunny**
 On-Site Time **1.50**
 Lab Time **0.00**
 Travel Time* **0.00**
 Total **1.50**
 Re Obs Time **0.00**

Remarks

Trip Charges*	Tolls/Parking*	Mileage*	Time of Arrival	Departure
Chargeable Items			10:30A	12:00P

* Travel time and mileage will be billed in accordance with the contract.

Summary of Services Performed (field test data, locations, elevations & depths are estimates) & Individuals Contacted.

ECS Representative arrived on site, as requested, to check the bearing capacity of soils via hand auger/DCP method for the monolithic slab area for 389 Solomon Drive - Lot 40. Please see the attached sketch and data sheet for details.

A hand auger was used to advance the boreholes to different depths noted on the boring logs. Dynamic Cone Penetrometer (DCP) test were performed in the hand auger boreholes by a 1.5 inch diameter cone driven into the soil by a 15 pound ring weight with a free fall of 20 inches. The number of blows required to drive the cone into the soil a distance of 1.75 inches is termed the DCP Value and is indicated for each test on the hand auger.

A total of 4 hand auger/DCP evaluations were performed to a depth of approximately 3 feet below the current footing sub grade elevation. Test results indicated that the materials in place , at the locations and elevations tested, did appear to be suitable to support the design bearing capacity 2,000 psf.

ECS will return upon request.

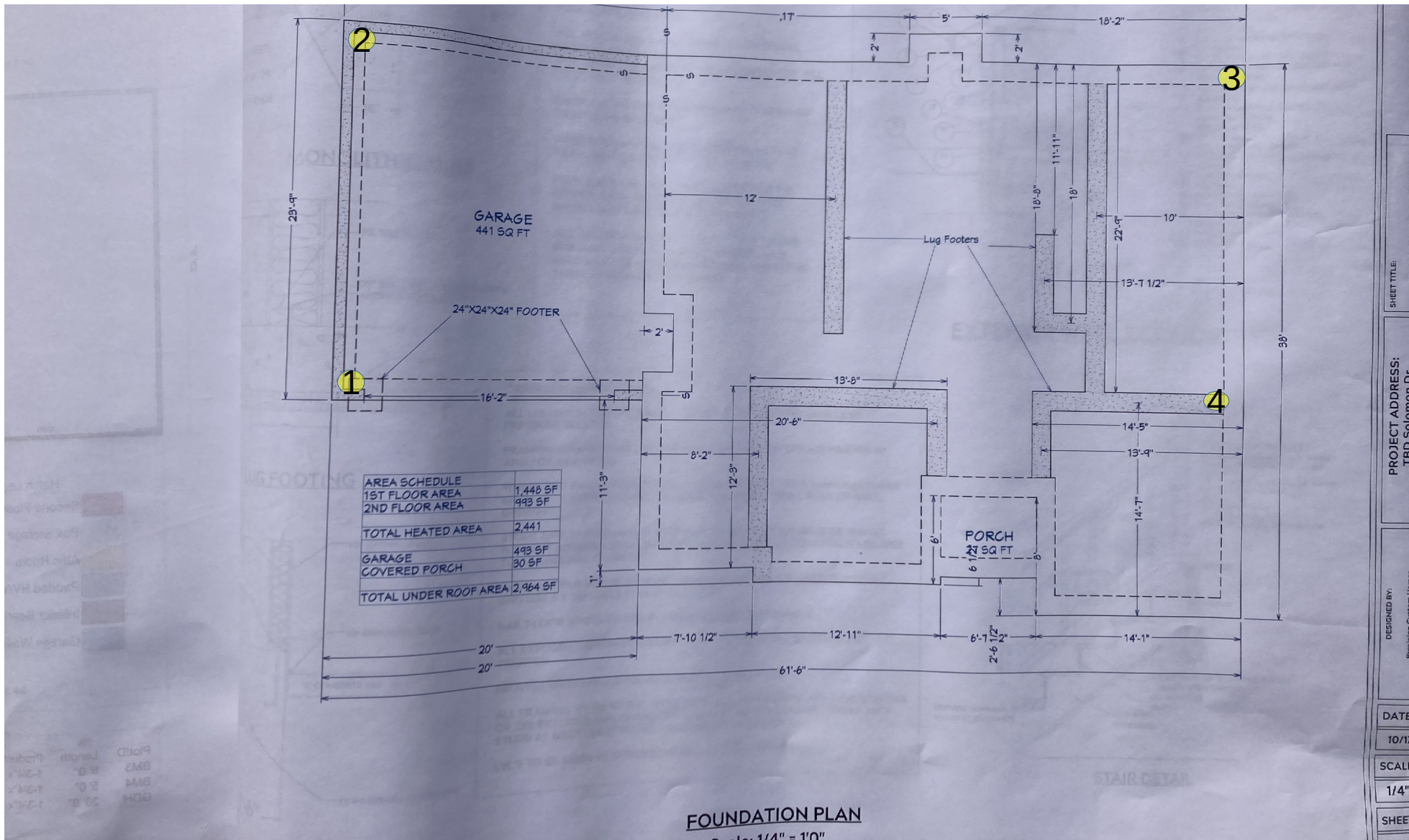

Todd T. Davis
10/21/2022
389 Solomon Dr. - Lot 40
Proj #: 6122-L
W/O # 69383

Key (NTS)
DCP / Hand Auger
Test Locations --- #



Key (NTS)

View of 389 Solomon Dr. - Lot 40





Report of Spread Footing - Foundation Observations

Project: Liberty Meadows Lot 40
 Location: 389 Solomon Dr
 Cameron - Harnett - NC - 28326
 Contractor: Precision Custom Homes

Project No.: 33:6122-L
 Day/Date: 10/21/2022

Footing Number	Location	Size (W x H x L)		Footing Bottom Elevation		Description of Steel Placed	Description of Subgrade Material	Required Blow Counts	Design Bearing Pressure
		Design	Actual	Design **	Depth of Undercut (in)			# of Blows / Increment	
1	See Attached Drawing	x x	x x	N/A	N/A		(0) Tan-Orange Silty Sand (1) Gray Silty Sand (2-3) Tan Silty Sand	6 (0) 7,7,10 (1) 11,20,21 (2) 11,12,13 (3) 12,12,15	2000
2	See Attached Drawing	x x	x x	N/A	N/A		(0) Tan-Orange Silty Sand (1) Gray Silty Sand (2-3) Light Tan Silty Sand	6 (0) 7,9,13 (1) 8,13,14 (2) 8,9,9 (3) 9,9,11	2000
3	See Attached Drawing	x x	x x	N/A	N/A		(0-1) Tan-Orange Silty Sand (2-3) Gray Silty Sand	6 (0) 5,7,8 (1) 7,9,10 (2) 12,15,17 (3) 14,16,19	2000
3	See Attached Drawing	x x	x x	N/A	N/A		(0-2) Tan-Orange Silty Sand (3) Gray Silty Sand	6 (0) 6,8,9 (1) 6,7,11 (2) 7,9,10 (3) 15,17,19	2000

** SGE: Subgrade Elevation to be determined by surveyor.

By: Todd Davis



Report of Spread Footing - Foundation Observations

Project: Liberty Meadows Lot 40
Location: 389 Solomon Dr
Cameron - Harnett - NC - 28326
Contractor: Precision Custom Homes

Project No.: 33:6122-L
Day/Date: 10/21/2022

ECS Southeast, LLP

WO: 69383