

Owner: HAVEN S/D  
 Address: LOT 52  
 Location: 135 HARMONY TRAIL

**PITTMAN SOIL CONSULTING**  
**PO BOX 1387**  
**RICHLANDS, NC 28574**  
**910-330-2784**  
**pittmansoil@yahoo.com**

LOT INFORMATION OBTAINED VIA PLAT BY STANCIL AND ASSOCIATES FOR XCESSIVE RISK DEVELOPMENT, DATED APRIL 27, 2019.

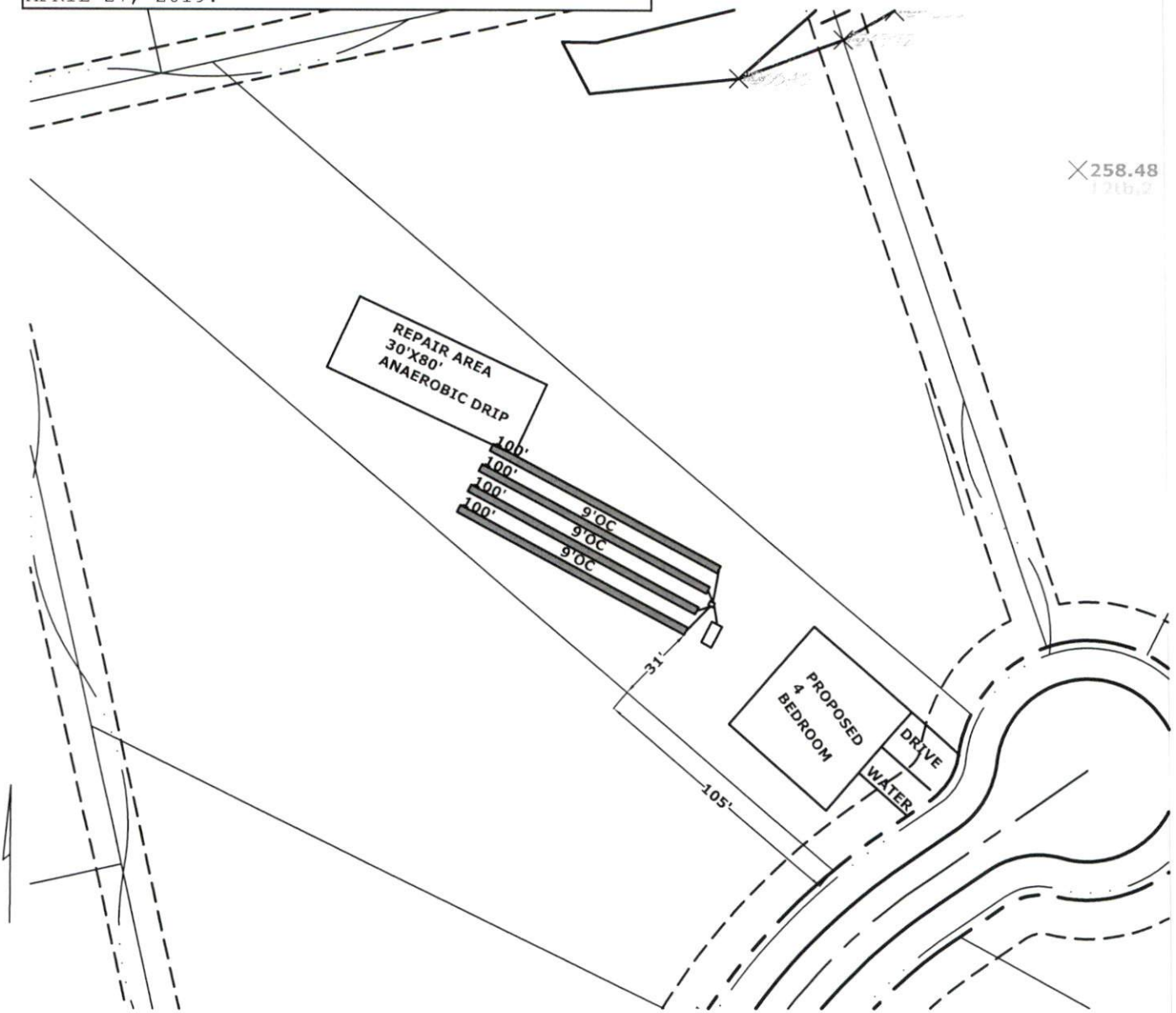

*Handwritten signature*

DR: NATHAN M. PARKER, PE, P.E., S.E., S.A.M.P.D.  
 ENGINEERING, P.C.  
 43250  
 10/22/2012, 09/08/1973, 44-2412



- INITIAL**
- 4 BEDROOM
- LTAR .3
- 4-100' 25% REDUCTION LINES
- 12-24" TB
- >6" SOIL COVER REQUIRED OVER SYSTEM AND 5' BEYOND SYSTEM
- REPAIR AREA**
- 4 BEDROOM
- LTAR .2
- 30'X80' ANAEROBIC DRIP LINES
- 6" TB
- >6" SOIL COVER REQUIRED OVER SYSTEM AND 5' BEYOND SYSTEM

**SCALE 1"=60'**

# *Pittman Soil Consulting*

1003 Gregory Fork Road

Richlands, NC 28574

Phone (910)330-2784

*pittmansoil@yahoo.com*

SEPTEMBER 8, 2022

Ref: HAVEN Lot 52, HARNETTCOUNTY

A soil evaluation was conducted on the above referenced tract to determine the sites suitability for septic. The current laws and rules of NC was used as guide for this evaluation.

Hand Auger borings on the site were used to characterize the soil texture, and depth to the soil wetness condition. The attached plot plan shows the location of the septic system in the most ideal location on the site. The soil wetness condition was found to be 24-48" from the surface with a clay loam texture. I have assigned an LTAR of 0.3 gpd/sqft for a 480 gpd 4 bedroom residence. This will require the installation of 4-100' 25% reduction lines that shall be installed in accordance with the current rules. The depth to soil wetness of 24-48" would constitute a 12-24" trench bottom. The system will require 6" soil cover that shall extend 5' from the edge of the system. The system will require a 1000 gallon septic tank.

The repair area will require a 30'x80' anaerobic drip installed at a depth of 6" from the surface (LTAR 0.2).

After installation the site should be landscaped to shed surface water. Any alterations to the site may impact soil conditions.

If you have any questions please feel free to contact me at 910-330-2784. Thank You.

Sincerely,

R. Haywood Pittman II  
NC Licensed Soil Scientist

# AMP'd Engineering, PLLC

Civil Engineer – Consulting Engineer – Land Development

PO Box 4580

Emerald Isle, NC 28594

(252) 777-0141 ✦ athan.parker@ampdengineering.com

Firm License Number P-1532

## Ref: AMP'D Engineering, PLLC Septic Standards

To Whom It May Concern,

Due to unforeseen negligence by previous owners and contractors regarding the Engineered Option Permit ("EOP") process and installation, the following standards have been adopted by AMP'D Engineering, PLLC and are to be strictly followed. If these standards are not followed, AMP'D Engineering, PLLC has the right to void all warranties related to engineering work involved with these EOPs.

- Engineer shall approve septic installer prior to installation.
- Engineer shall be notified at a minimum of 48 hours prior to septic installation.
- No vehicles, equipment, structures, debris, or any other items that may compact the soils or damage the septic lines allowed on the septic location before or after installation. Equipment only allowed over the septic area by a certified septic installer to backfill and grade the septic area after installation.
- All systems are to have a minimum of 6" cover over the system and five feet beyond the system. Only approved soil to be used as cover.
- After installation, the area should be graded to shed water. All drainage should be diverted away from septic area and tanks.
- All drip systems to have a minimum of 12" cover over the system and five feet beyond the system. Only group I soil allowed over system with a cap of topsoil to promote growth of groundcover.
- Groundcover is to be established over every system within 14 days after installation.
- Orange safety fencing with T-Posts to be used to surround the system after installation to prevent any unqualified individuals from entering septic area.

If you have any questions, please feel free to give me a call (252) 777-0141 or email me (athan.parker@ampdengineering.com).

Sincerely,



DN: o=ATHAN M. PARKER, PE, c=US, o=AMP'D  
ENGINEERING, PLLC,  
e=athan.parker@ampdengineering.com,  
Date: 2022.09.08 16:23:58 -0400

Athan M Parker, PE  
President  
AMP'd Engineering, PLLC  
Firm License No. P-1532







# CERTIFICATE OF LIABILITY INSURANCE

DATE (MM/DD/YYYY)

07/27/2022

THIS CERTIFICATE IS ISSUED AS A MATTER OF INFORMATION ONLY AND CONFERS NO RIGHTS UPON THE CERTIFICATE HOLDER. THIS CERTIFICATE DOES NOT AFFIRMATIVELY OR NEGATIVELY AMEND, EXTEND OR ALTER THE COVERAGE AFFORDED BY THE POLICIES BELOW. THIS CERTIFICATE OF INSURANCE DOES NOT CONSTITUTE A CONTRACT BETWEEN THE ISSUING INSURER(S), AUTHORIZED REPRESENTATIVE OR PRODUCER, AND THE CERTIFICATE HOLDER.

**IMPORTANT:** If the certificate holder is an ADDITIONAL INSURED, the policy(ies) must have ADDITIONAL INSURED provisions or be endorsed. If SUBROGATION IS WAIVED, subject to the terms and conditions of the policy, certain policies may require an endorsement. A statement on this certificate does not confer rights to the certificate holder in lieu of such endorsement(s).

<b>PRODUCER</b> N.C. Farm Bureau Ins. Agency 5301 Glenwood Avenue (27612) P.O. Box 27427 Raleigh NC 27611		<b>CONTACT NAME:</b> <b>PHONE (A/C, No, Ext):</b> <b>FAX (A/C, No):</b> <b>E-MAIL ADDRESS:</b>	
<b>INSURED</b> Ronald H. Pittman, II DBA Pittman Soil Consulting 1003 Gregory Fork Rd Richlands NC 28574		<b>INSURER(S) AFFORDING COVERAGE</b> <b>INSURER A:</b> Capitol Specialty Insurance Corporation <b>INSURER B:</b> <b>INSURER C:</b> <b>INSURER D:</b> <b>INSURER E:</b> <b>INSURER F:</b>	
		<b>NAIC #</b>	

**COVERAGES**

CERTIFICATE NUMBER: CL2272123407

REVISION NUMBER:

THIS IS TO CERTIFY THAT THE POLICIES OF INSURANCE LISTED BELOW HAVE BEEN ISSUED TO THE INSURED NAMED ABOVE FOR THE POLICY PERIOD INDICATED. NOTWITHSTANDING ANY REQUIREMENT, TERM OR CONDITION OF ANY CONTRACT OR OTHER DOCUMENT WITH RESPECT TO WHICH THIS CERTIFICATE MAY BE ISSUED OR MAY PERTAIN, THE INSURANCE AFFORDED BY THE POLICIES DESCRIBED HEREIN IS SUBJECT TO ALL THE TERMS, EXCLUSIONS AND CONDITIONS OF SUCH POLICIES. LIMITS SHOWN MAY HAVE BEEN REDUCED BY PAID CLAIMS.

INSR LTR	TYPE OF INSURANCE	ADDL INSD	SUBR WVD	POLICY NUMBER	POLICY EFF (MM/DD/YYYY)	POLICY EXP (MM/DD/YYYY)	LIMITS
A	<input checked="" type="checkbox"/> COMMERCIAL GENERAL LIABILITY <input type="checkbox"/> CLAIMS-MADE <input checked="" type="checkbox"/> OCCUR			EV20182381-05	07/19/2022	07/19/2023	EACH OCCURRENCE \$ 1,000,000
	<input checked="" type="checkbox"/> Professional Liability						DAMAGE TO RENTED PREMISES (Ea occurrence) \$ 50,000
	GEN' AGGREGATE LIMIT APPLIES PER: <input checked="" type="checkbox"/> POLICY <input type="checkbox"/> PRO-JECT <input type="checkbox"/> LOC OTHER:						MED EXP (Any one person) \$ 5,000
							PERSONAL & ADV INJURY \$ 1,000,000
	<b>AUTOMOBILE LIABILITY</b> <input type="checkbox"/> ANY AUTO <input type="checkbox"/> OWNED AUTOS ONLY <input type="checkbox"/> HIRED AUTOS ONLY <input type="checkbox"/> SCHEDULED AUTOS <input type="checkbox"/> NON-OWNED AUTOS ONLY						GENERAL AGGREGATE \$ 2,000,000
	<input type="checkbox"/> UMBRELLA LIAB <input type="checkbox"/> EXCESS LIAB DED RETENTION \$						PRODUCTS - COMPOP AGG \$ 2,000,000 Professional Occ/Agg \$ 1M/2M
	<b>WORKERS COMPENSATION AND EMPLOYERS' LIABILITY</b> ANY PROPRIETOR/PARTNER/EXECUTIVE OFFICER/MEMBER EXCLUDED? (Mandatory in NH) If yes, describe under DESCRIPTION OF OPERATIONS below						COMBINED SINGLE LIMIT (Ea accident) \$ BODILY INJURY (Per person) \$ BODILY INJURY (Per accident) \$ PROPERTY DAMAGE (Per accident) \$
A	Contractors Pollution Liability - Occurrence Form			EV20182381-05	07/19/2022	07/19/2023	EACH OCCURRENCE \$ AGGREGATE \$ PER STATUTE   OTH-ER E.L. EACH ACCIDENT \$ E.L. DISEASE - EA EMPLOYEE \$ E.L. DISEASE - POLICY LIMIT \$ Each Incident \$1,000,000 Aggregate Limit \$2,000,000

DESCRIPTION OF OPERATIONS / LOCATIONS / VEHICLES (ACORD 101, Additional Remarks Schedule, may be attached if more space is required)

**CERTIFICATE HOLDER****CANCELLATION**

NC 28540	SHOULD ANY OF THE ABOVE DESCRIBED POLICIES BE CANCELLED BEFORE THE EXPIRATION DATE THEREOF, NOTICE WILL BE DELIVERED IN ACCORDANCE WITH THE POLICY PROVISIONS.
	AUTHORIZED REPRESENTATIVE 