

PITTMAN SOIL CONSULTING

PO BOX 1387

RICHLANDS, NC 28574

910-330-2784

pittmansoil@yahoo.com

Owner: JENNY MCPHAIL ALLEN

Address: LOT 2

Location: OLD US 421

PROPERTY INFORMATION OBTAINED VIA SURVEY BY M.A.P.S. SURVEYING, INC., DATED APRIL 19, 2022.



Handwritten signature/initials

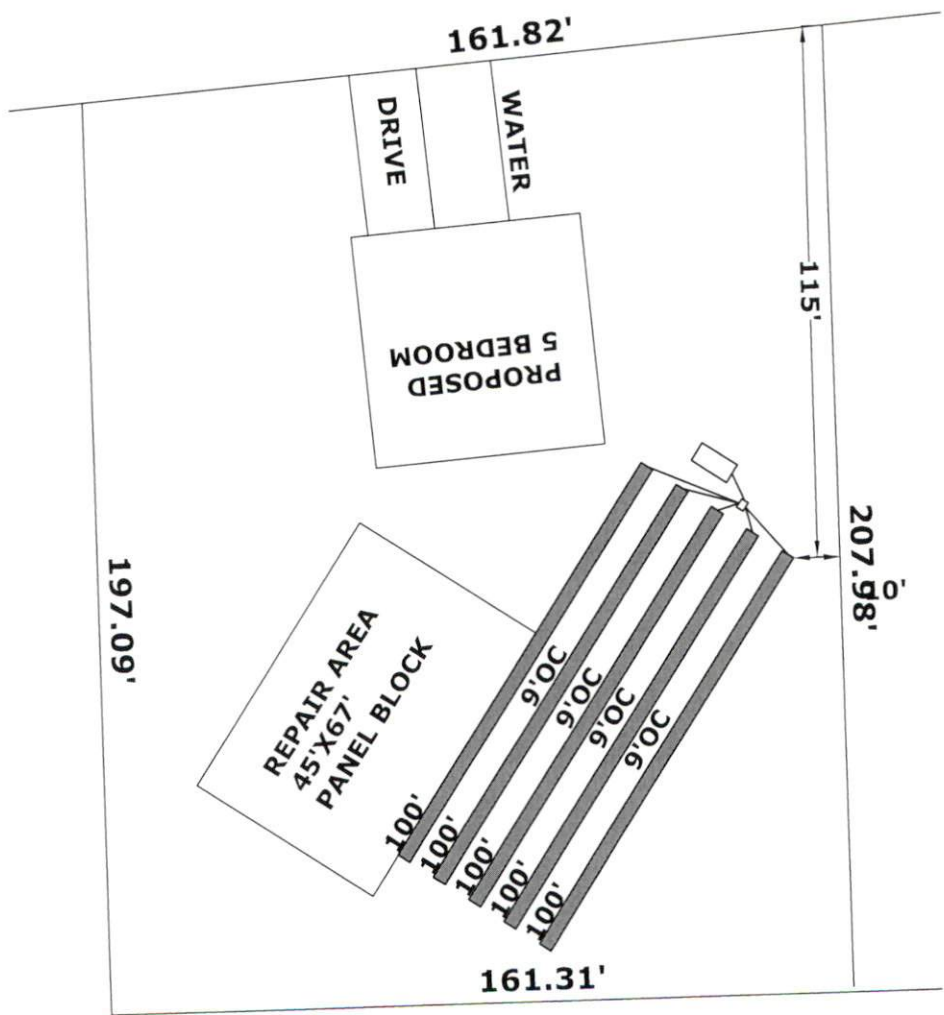

- INITIAL**
- 5 BEDROOM
- LTAR .3
- 5-100' 25% REDUCTION LINES
- 18-20" TB
- >6" SOIL COVER REQUIRED OVER SYSTEM AND 5' BEYOND SYSTEM
- REPAIR AREA**
- 5 BEDROOM
- LTAR .3
- 5-67' PANEL BLOCK LINES
- 18-20" TB
- >6" SOIL COVER REQUIRED OVER SYSTEM AND 5' BEYOND SYSTEM

SCALE 1"=40'

Pittman Soil Consulting

1003 Gregory Fork Road

Richlands, NC 28574

Phone (910)330-2784

pittmansoil@yahoo.com

August 15, 2022

Ref: OLD US 421 LOT 2

A soil evaluation was conducted on the above referenced tract to determine the sites suitability for septic. The current laws and rules of NC was used as guide for this evaluation.

Hand Auger borings were conducted across the site and on the site were used to characterize the soil texture, and depth to the soil wetness condition. The attached plot plan shows the location of the septic system in the most ideal location. The soil wetness condition was found to be 38" from the surface with a clay loam texture. I have assigned an LTAR of 0.3 gpd/sqft for a 600 gpd 5 bedroom residence. This will require the installation of 5-100' 25% reduction lines that shall be installed in accordance with the current rules. The depth to soil wetness of 38" would constitute a 18-20" trench bottom. The system will require 6" soil cover that shall extend 5' from the edge of the system. The system will require a 1000 gallon septic tank.

The repair area will require 5-67' PANEL BLOCK lines installed at 18-20" from the surface (LTAR 0.3gpd).

After installation the site should be landscaped to shed surface water. Any alterations to the site may impact soil conditions.

If you have any questions please feel free to contact me at 910-330-2784. Thank You.

Sincerely,



R. HAYWOOD PITTMAN II

R. Haywood Pittman II
NC Licensed Soil Scientist



CERTIFICATE OF LIABILITY INSURANCE

DATE (MM/DD/YYYY)
02/17/2022

THIS CERTIFICATE IS ISSUED AS A MATTER OF INFORMATION ONLY AND CONFERS NO RIGHTS UPON THE CERTIFICATE HOLDER. THIS CERTIFICATE DOES NOT AFFIRMATIVELY OR NEGATIVELY AMEND, EXTEND OR ALTER THE COVERAGE AFFORDED BY THE POLICIES BELOW. THIS CERTIFICATE OF INSURANCE DOES NOT CONSTITUTE A CONTRACT BETWEEN THE ISSUING INSURER(S), AUTHORIZED REPRESENTATIVE OR PRODUCER, AND THE CERTIFICATE HOLDER.

IMPORTANT: If the certificate holder is an ADDITIONAL INSURED, the policy(ies) must have ADDITIONAL INSURED provisions or be endorsed. If SUBROGATION IS WAIVED, subject to the terms and conditions of the policy, certain policies may require an endorsement. A statement on this certificate does not confer rights to the certificate holder in lieu of such endorsement(s).

PRODUCER The Sewell Insurance Agency 785-1 W Corbett Ave PO Box 835 Swansboro NC 28584	CONTACT NAME: Kira Gibson, AINS, SBCS PHONE (A/C, No, Ext): (910) 326-5754 E-MAIL ADDRESS: kira@thesewellagency.com FAX (A/C, No): (910) 326-6310													
	<table border="1"> <thead> <tr> <th>INSURER(S) AFFORDING COVERAGE</th> <th>NAIC #</th> </tr> </thead> <tbody> <tr> <td>INSURER A : Bankers Insurance Group</td> <td>33162</td> </tr> <tr> <td>INSURER B : Progressive Southeastern</td> <td>38784</td> </tr> <tr> <td>INSURER C : NorGUARD Insurance Company</td> <td>31470</td> </tr> <tr> <td>INSURER D : Berkshire Hathaway GUARD Insurance Company</td> <td></td> </tr> <tr> <td>INSURER E :</td> <td></td> </tr> <tr> <td>INSURER F :</td> <td></td> </tr> </tbody> </table>	INSURER(S) AFFORDING COVERAGE	NAIC #	INSURER A : Bankers Insurance Group	33162	INSURER B : Progressive Southeastern	38784	INSURER C : NorGUARD Insurance Company	31470	INSURER D : Berkshire Hathaway GUARD Insurance Company		INSURER E :		INSURER F :
INSURER(S) AFFORDING COVERAGE	NAIC #													
INSURER A : Bankers Insurance Group	33162													
INSURER B : Progressive Southeastern	38784													
INSURER C : NorGUARD Insurance Company	31470													
INSURER D : Berkshire Hathaway GUARD Insurance Company														
INSURER E :														
INSURER F :														
INSURED AMP'D Engineering PLLC PO Box 4580 Emerald Isle NC 28594														

COVERAGES **CERTIFICATE NUMBER:** CL2221703839 **REVISION NUMBER:**

THIS IS TO CERTIFY THAT THE POLICIES OF INSURANCE LISTED BELOW HAVE BEEN ISSUED TO THE INSURED NAMED ABOVE FOR THE POLICY PERIOD INDICATED. NOTWITHSTANDING ANY REQUIREMENT, TERM OR CONDITION OF ANY CONTRACT OR OTHER DOCUMENT WITH RESPECT TO WHICH THIS CERTIFICATE MAY BE ISSUED OR MAY PERTAIN, THE INSURANCE AFFORDED BY THE POLICIES DESCRIBED HEREIN IS SUBJECT TO ALL THE TERMS, EXCLUSIONS AND CONDITIONS OF SUCH POLICIES. LIMITS SHOWN MAY HAVE BEEN REDUCED BY PAID CLAIMS.

INSR LTR	TYPE OF INSURANCE	ADDL INSD	SUBR WYD	POLICY NUMBER	POLICY EFF (MM/DD/YYYY)	POLICY EXP (MM/DD/YYYY)	LIMITS
A	<input checked="" type="checkbox"/> COMMERCIAL GENERAL LIABILITY <input type="checkbox"/> CLAIMS-MADE <input checked="" type="checkbox"/> OCCUR GEN'L AGGREGATE LIMIT APPLIES PER: <input checked="" type="checkbox"/> POLICY <input type="checkbox"/> PRO-JECT <input type="checkbox"/> LOC OTHER:			32 0040007108 0 02	03/02/2022	03/02/2023	EACH OCCURRENCE \$ 1,000,000 DAMAGE TO RENTED PREMISES (Ea occurrence) \$ 300,000 MED EXP (Any one person) \$ 10,000 PERSONAL & ADV INJURY \$ 1,000,000 GENERAL AGGREGATE \$ 2,000,000 PRODUCTS - COMP/OP AGG \$ 2,000,000 Add'l for policy minimum \$
B	AUTOMOBILE LIABILITY <input type="checkbox"/> ANY AUTO OWNED AUTOS ONLY <input type="checkbox"/> HIRED AUTOS ONLY <input checked="" type="checkbox"/> SCHEDULED AUTOS NON-OWNED AUTOS ONLY			01335494	11/05/2021	11/05/2022	COMBINED SINGLE LIMIT (Ea accident) \$ 1,000,000 BODILY INJURY (Per person) \$ BODILY INJURY (Per accident) \$ PROPERTY DAMAGE (Per accident) \$ \$
	UMBRELLA LIAB <input type="checkbox"/> OCCUR EXCESS LIAB <input type="checkbox"/> CLAIMS-MADE DED RETENTION \$						EACH OCCURRENCE \$ AGGREGATE \$ \$
C	WORKERS COMPENSATION AND EMPLOYERS' LIABILITY ANY PROPRIETOR/PARTNER/EXECUTIVE OFFICER/MEMBER EXCLUDED? (Mandatory in NH) If yes, describe under DESCRIPTION OF OPERATIONS below	Y/N	N/A	AMWC357500	03/01/2022	03/01/2023	<input checked="" type="checkbox"/> PER STATUTE <input type="checkbox"/> OTH-ER E.L. EACH ACCIDENT \$ 500,000 E.L. DISEASE - EA EMPLOYEE \$ 500,000 E.L. DISEASE - POLICY LIMIT \$ 500,000
D	Professional Liability			AMPL339476	03/01/2022	03/01/2023	Per Claim \$1,000,000 Aggregate \$2,000,000

DESCRIPTION OF OPERATIONS / LOCATIONS / VEHICLES (ACORD 101, Additional Remarks Schedule, may be attached if more space is required)

CERTIFICATE HOLDER**CANCELLATION**

AMP'D Engineering PLLC PO Box 4580 Emerald Isle NC 28594	SHOULD ANY OF THE ABOVE DESCRIBED POLICIES BE CANCELLED BEFORE THE EXPIRATION DATE THEREOF, NOTICE WILL BE DELIVERED IN ACCORDANCE WITH THE POLICY PROVISIONS. AUTHORIZED REPRESENTATIVE 
--	--

© 1988-2015 ACORD CORPORATION. All rights reserved.

