

SOIL/SITE EVALUATION
for ON-SITE WASTEWATER SYSTEM

Owner: Lameo Applicant:
Address: 52 Rolling Postura
Proposed Facility: SFD

Date Evaluated: 10-3-22
Design Flow (.1949): 360

Property Size:

Location of Site: Property Recorded:
Water Supply: Public Individual Well Spring Other
Evaluation Method: Auger Boring Pit Cut
Type of Wastewater: Sewage Industrial Process Mixed

P R O F I L E #	.1940 Landscape Position/ Slope %	Horizon Depth (In.)	SOIL MORPHOLOGY .1941		OTHER PROFILE FACTORS				Profile Class & LTAR
			.1941 Structure/ Texture	.1941 Consistence Mineralogy	.1942 Soil Wetness/ Color	.1943 Soil Depth (IN.)	.1956 Sapro Class	.1944 Restr Horiz	
<u>1,2 3</u>	<u>L 2-5%</u>	<u>0-10</u>	<u>LS Gr</u>	<u>Fr/ls/sp/np</u>	<u>10YR6/2</u>	<u>>48"</u>	<u>—</u>	<u>—</u>	<u>PS-4</u>
		<u>10-48</u>	<u>SCI SBlk</u>	<u>Fr/ls/sp/np</u>	<u>≥ 30"</u>				<u>Group III</u>

Description	Initial System	Repair System	Other Factors (.1946): Site Classification (.1948): <u>PS-4</u> Evaluated By: <u>M. Ch. RETS</u> Others Present:
Available Space (.1945)	<u>25%</u>	<u>25%</u>	
System Type(s)	<u>25%</u>	<u>25%</u>	
Site LTAR	<u>.4</u>	<u>.4</u>	

COMMENTS: _____

LANDSCAPE POSITIONS	GROUP	TEXTURES	.1955 LTAR	CONSISTENCE MOIST	WET
R-RIDGE	I	S-SAND	1.2 - 0.8	VFR-VERY FRIABLE	NS-NON-STICKY
S-SHOULDER SLOPE		LS-LOAMY SAND		FR-FRIABLE	SS-SLIGHTLY STICKY
L-LINEAR SLOPE	II	SL-SANDY LOAM	0.8 - 0.6	FI-FIRM	S-STICKY
FS-FOOT SLOPE		L-LOAM		VFI-VERY FIRM	VS-VERY STICKY
N-NOSE SLOPE	III	SI-SILT	0.6 - 0.3	EFI-EXTREMELY FIRM	NP-NON-PLASTIC
H-HEAD SLOPE		SIL-SILT LOAM			SP-SLIGHTLY STICKY
CC-CONCLAVE SLOPE		CL-CLAY LOAM			P-PLASTIC
CV-CONVEX SLOPE		SCL-SANDY CLAY LOAM			VP-VERY PLASTIC
T-TERRACE	IV	SIC-SILTY CLAY	0.4 - 0.1		
FP-FLOOD PLAN		C-CLAY			
		SC-SANDY CLAY			

STRUCTURE

- SG-SINGLE GRAIN
- M- MASSIVE
- CR-CRUMB
- GR-GRANULAR
- SBK-SUBANGULAR BLOCKY
- ABK-ANGULAR BLOCKY
- PL-PLATY
- PR-PRISMATIC

MINERALOGY

- SLIGHTLY EXPANSIVE
- EXPANSIVE

Show profile locations and other site features (dimensions, references or benchmark, and North)

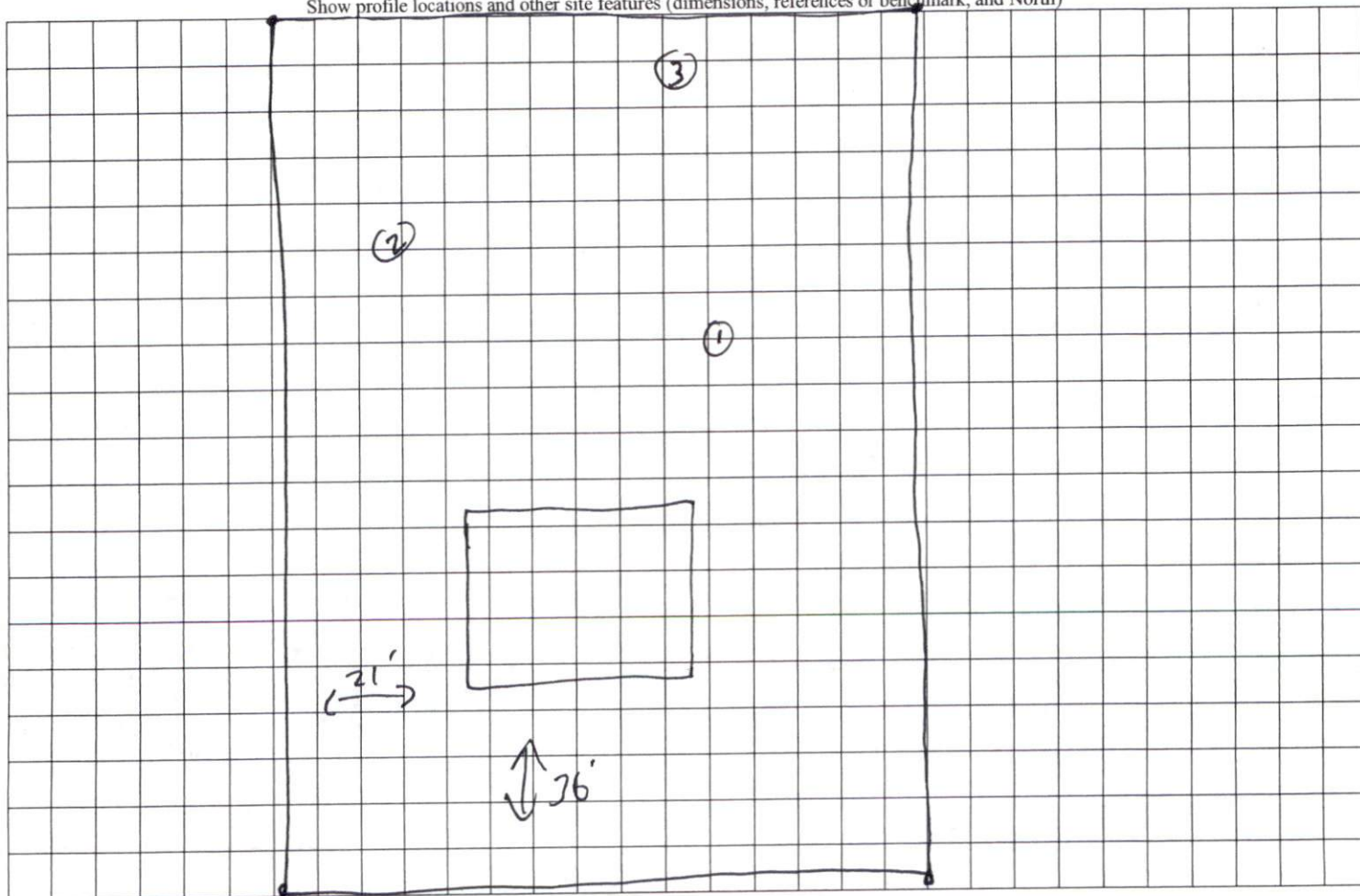

Rolling Pasture way