

Southeastern Soil & Environmental Associates, Inc.

P.O. Box 9321
Fayetteville, NC 28311
Phone/Fax (910) 822-4540
Email mike@southeasternsoil.com

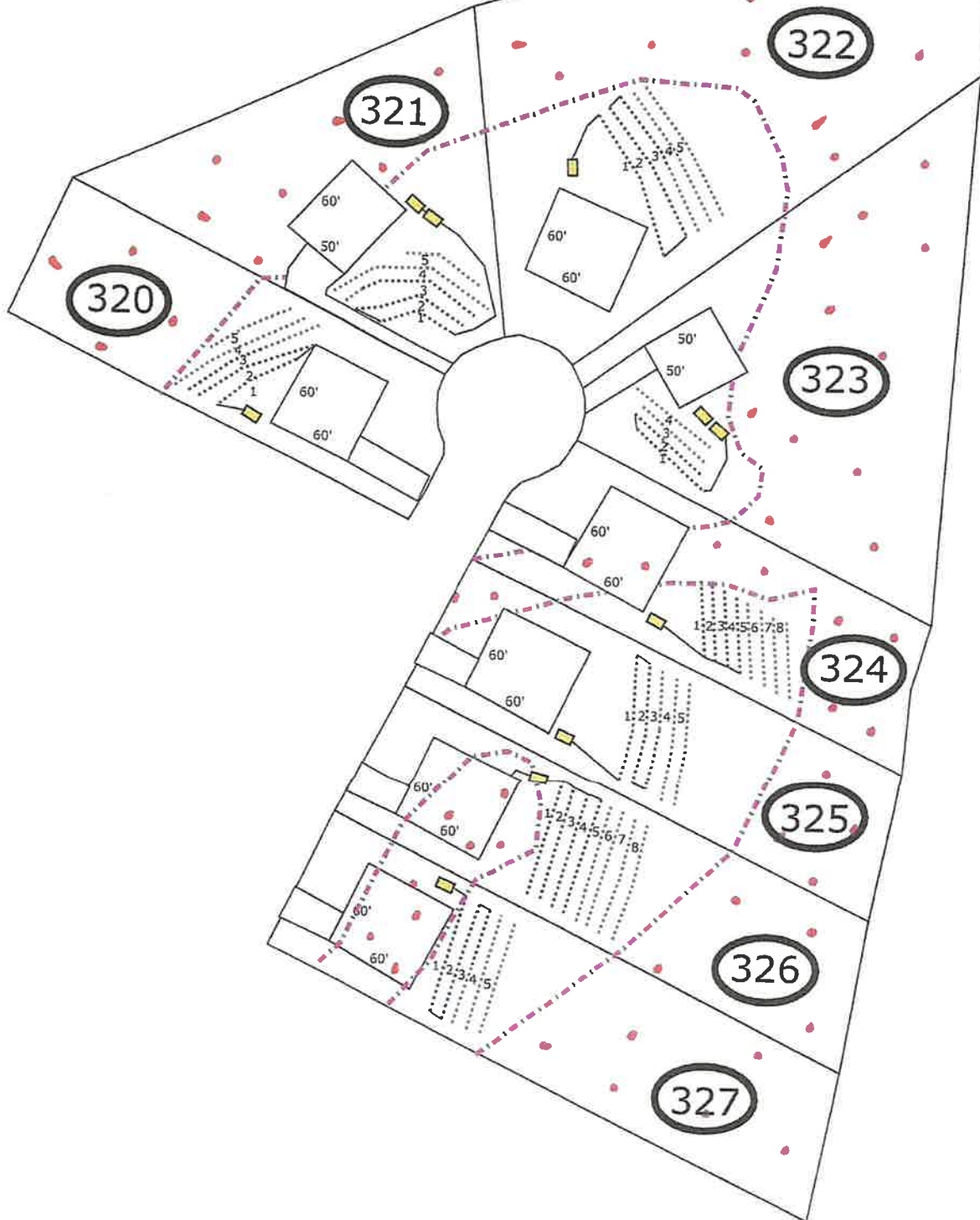

SOUTHEASTERN SOIL & ENVIRONMENTAL ASSOC., INC.

PROPOSED SUBSURFACE WASTE DISPOSAL SYSTEM DETAIL SHEET

SUBDIVISION: Dakmont

LOT 321

INITIAL SYSTEM: ^{Pump} APPROVED 25% REDUCTION

REPAIR ^{Pump} Approved 25% Reduction

DISTRIBUTION: SERIAL

DISTRIBUTION SERIAL

BENCHMARK: 100.0

LOCATION R+D T/G27 Nail

NO. BEDROOMS: 5

LTAR 0.8 gpd 1ft²

LINE	FLAG COLOR	ELEVATION	LENGTH
1	B	98.08	50
2	0	97.42	80
3a	4	97.08	60
			190
3b	4	97.08	30
4	B	96.42	115
5	0	95.83	55
			190

BY B.C. Raynor

DATE 06/09/2020

TYPICAL PROFILE

THERE SHALL BE NO GRADING,

0-42 LS vfri gran

CUTTING, LOGGING OR OTHER SOIL

CL2 >42"

DISTURBANCE IN SEPTIC AREA

HEALTH DEPARTMENT USE ONLY.

DESIGNS DO NOT GUARANTEE FUNCTIONALITY