

4-Bedroom Septic Plan  
 Lot 8 – Duncan's Crossing  
 Harnett County  
 Smith Douglas Homes

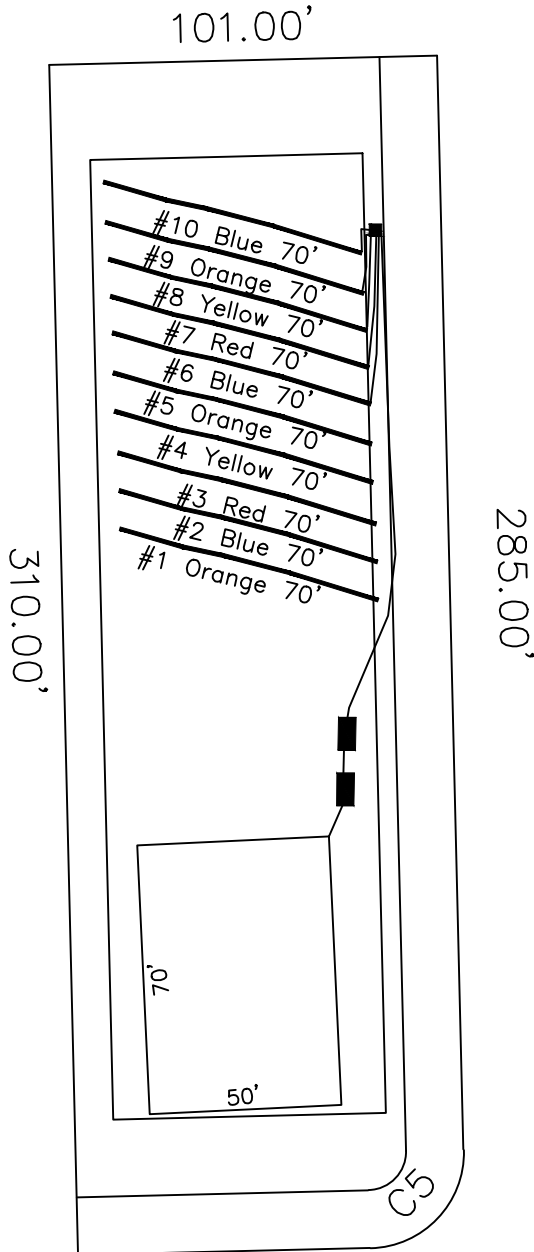

\*House footprint to be field staked by surveyor and system verified prior to any construction

\*\*Septic area must not be altered by construction activities.

\*\*\*No cuts of 2' or greater within 15' of septic area

\*\*\*\* Recommend protective barrier around septic field during construction.



25,116 SF  
 (0.58 AC)

76.00'  
**DOUBLE BARRELL STREET**  
 50' R/W (PUBLIC & UTILITY ACCESS)

System: Pump to D-Box  
 Lines: Lines 6-10 (350')  
 0.35 LTAR  
 22" Max Trench Bottom  
 Accepted Status System  
 Repair: Pressure Manifold  
 Lines: Lines 1-5 (350')  
 0.35 LTAR  
 15" Trench Bottom  
 Accepted Status System

GRAPHIC SCALE  
 1" = 50'



Adams  
 Soil Consulting  
 919-414-6761  
 Job #1146