

LOT 48

Sheet:  
 Property ID:  
 Lot #:  
 File #:  
 Code:

**SOIL/SITE EVALUATION  
 for ON-SITE WASTEWATER SYSTEM**

Owner: Ben Strat Applicant:  
 Address: 60 Melville Ln  
 Proposed Facility: SFD  
 Location of Site:

Date Evaluated: 1/7-22  
 Design Flow (.1949): 480  
 Property Recorded:

Property Size:  
 Spring  Other  
 Well  Mixed

Water Supply:  Public  Individual  Well  
 Evaluation Method:  Auger Boring  Pit  Cut  
 Type of Wastewater:  Sewage  Industrial Process

P R O F I L E #	.1940 Landscape Position/ Slope %	Horizon Depth (In.)	SOIL MORPHOLOGY .1941		OTHER PROFILE FACTORS				Profile Class & LTAR	
			.1941 Structure/ Texture	.1941 Consistence Mineralogy	.1942 Soil Wetness/ Color	.1943 Soil Depth (IN.)	.1956 Sapro Class	.1944 Restr Horiz		
1.3	L	0-20	LS	Gr	Fr/ns/wp/lxp	10YR6/2	>48"	—	—	PS. 5
	2-5%	20-48	sci	SBk	Fi/ss/sp/sxp	≥ 30"				Group III
2	L	0-20	LS	Gr	Fr/ns/wp/lxp	10YR6/1	>48"	—	—	PS. 4
	2-5%	20-48	sci	SBk	Fi/ss/sp/sxp	≥ 24"				Group III

Description	Initial System	Repair System	Other Factors (.1946): Site Classification (.1948): PS Evaluated By: MA BEW Others Present:
Available Space (.1945)	✓	✓	
System Type(s)	✓	✓	
Site LTAR	.5	.4	

COMMENTS: \_\_\_\_\_

<u>LANDSCAPE POSITIONS</u>	<u>GROUP</u>	<u>TEXTURES</u>	<u>.1955 LTAR</u>	<u>CONSISTENCE MOIST</u>	<u>WET</u>
R-RIDGE	I	S-SAND	1.2 - 0.8	VFR-VERY FRIABLE	NS-NON-STICKY
S-SHOULDER SLOPE		LS-LOAMY SAND		FR-FRIABLE	SS-SLIGHTLY STICKY
L-LINEAR SLOPE	II	SL-SANDY LOAM	0.8 - 0.6	FI-FIRM	S-STICKY
FS-FOOT SLOPE		L-LOAM		VFI-VERY FIRM	VS-VERY STICKY
N-NOSE SLOPE	III	SI-SILT	0.6 - 0.3	EFI-EXTREMELY FIRM	NP-NON-PLASTIC
H-HEAD SLOPE		SIL-SILT LOAM			SP-SLIGHTLY STICKY
CC-CONCLAVE SLOPE		CL-CLAY LOAM			P-PLASTIC
CV-CONVEX SLOPE		SCL-SANDY CLAY LOAM			VP-VERY PLASTIC
T-TERRACE	IV	SIC-SILTY CLAY	0.4 - 0.1		
FP-FLOOD PLAN		C-CLAY			
		SC-SANDY CLAY			

STRUCTURE

- SG-SINGLE GRAIN
- M- MASSIVE
- CR-CRUMB
- GR-GRANULAR
- SBK-SUBANGULAR BLOCKY
- ABK-ANGULAR BLOCKY
- PL-PLATY
- PR-PRISMATIC

MINERALOGY

- SLIGHTLY EXPANSIVE
- EXPANSIVE

Show profile locations and other site features (dimensions, references or benchmark, and North)

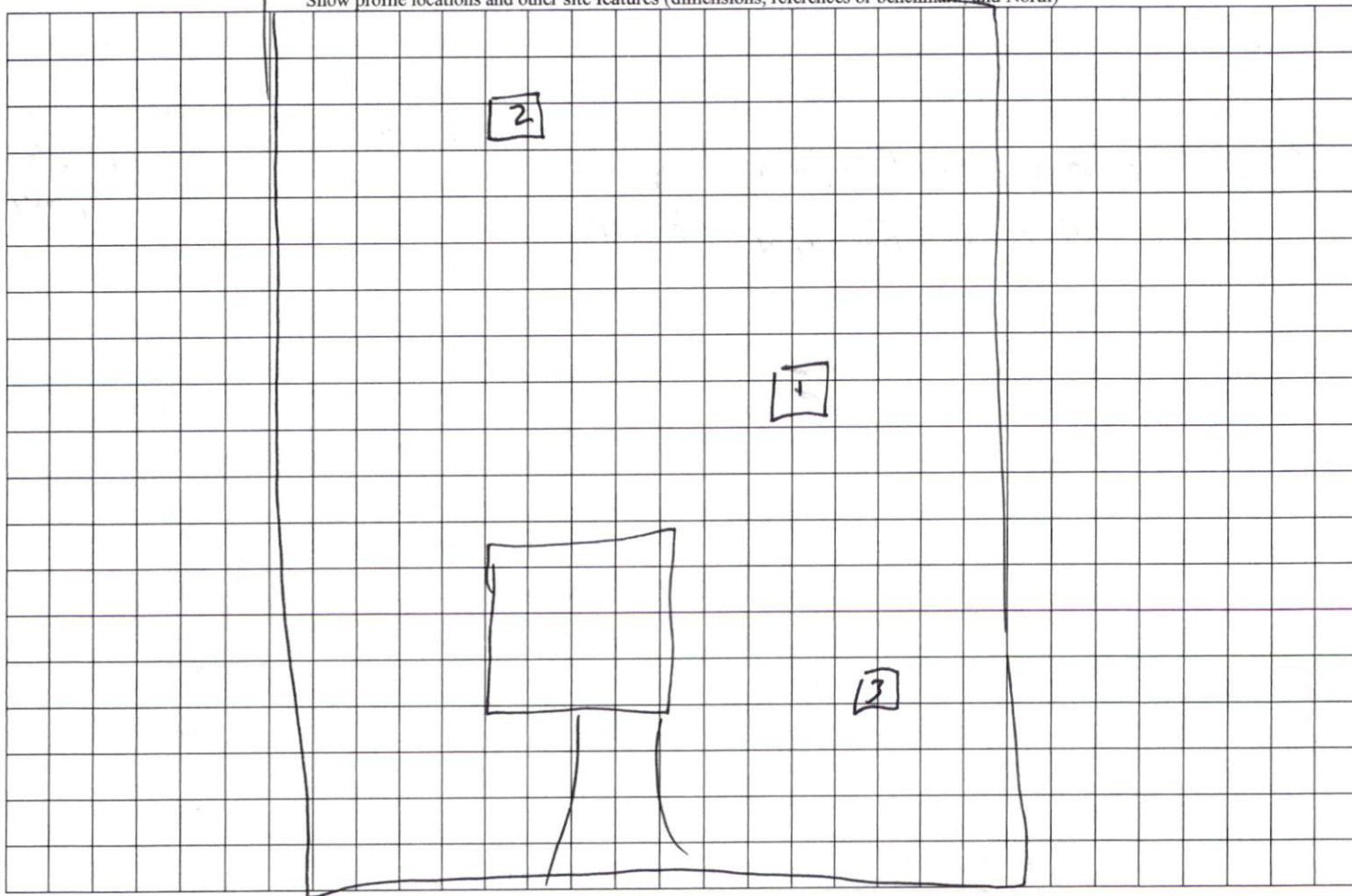

Melville