



ROOF & FLOOR TRUSSES & BEAMS

Reilly Road Industrial Park
Fayetteville, N.C. 28309
Phone: (910) 864-8787
Fax: (910) 864-4444

Bearing reactions less than or equal to 3000# are deemed to comply with the prescriptive Code requirements. The contractor shall refer to the attached Tables (derived from the prescriptive Code requirements) to determine the minimum foundation size and number of wood studs required to support reactions greater than 3000# but not greater than 15000#. A registered design professional shall be retained to design the support system for any reaction that exceeds those specified in the attached Tables. A registered design professional shall be retained to design the support system for all reactions that exceed 15000#.

Signature **David Landry**
David Landry

LOAD CHART FOR JACK STUDS

(BASED ON TABLES R502.5(1) & (b))
NUMBER OF JACK STUDS REQUIRED @ EA END OF HEADER/GIRDER

END REACTION (UP TO)	REQ. STUDS FOR (1) FT HEADER	END REACTION (UP TO)	REQ. STUDS FOR (1) FT HEADER	END REACTION (UP TO)	REQ. STUDS FOR (1) FT HEADER
1700	1	2550	1	3400	1
3400	2	5100	2	6800	2
5100	3	7650	3	10200	3
6800	4	10200	4	13600	4
8500	5	12750	5	17000	5
10200	6	15300	6		
11900	7				
13600	8				
15300	9				

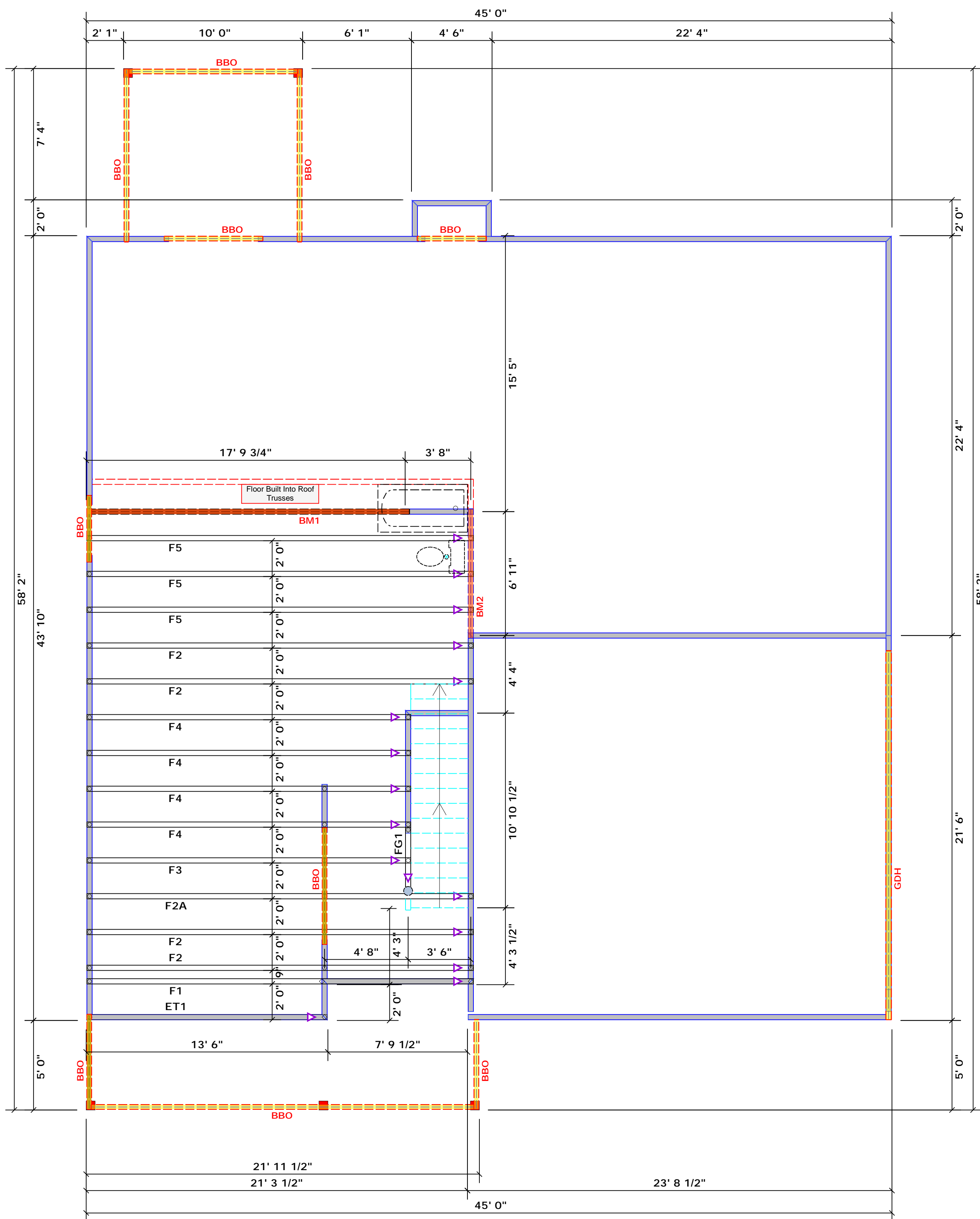

All Walls Shown Are Considered Load Bearing

Dimension Notes

1. All exterior wall to wall dimensions are to face of sheathing unless noted otherwise
2. All interior wall dimensions are to face of frame wall unless noted otherwise
3. All exterior wall to truss dimensions are to face of frame wall unless noted otherwise

Plumbing Drop Notes

1. Plumbing drop locations shown are NOT exact.
2. Contractor to verify ALL plumbing drop locations prior to setting Floor Trusses.
3. Adjust spacing as needed not to exceed 24" oc.

1 Truss Placement Plan
Scale: 1/4"=1'

Products

PlotID	Length	Product	Piles	Net Qty	Fab Type
BM1	18' 0"	1-3/4"x 16" LVL Kerto-S	2	2	FF
BM2	8' 0"	1-3/4"x 14" LVL Kerto-S	2	2	FF
GDH	24' 0"	1-3/4"x 18" LVL Kerto-S	3	3	FF

Connector Information

Sym	Product	Manuf	Qty	Supported Member	Header	Truss
●	MSH422	USP	1	Varies	10d/3"	10d/3"

BUILDER	JOB NAME	PLAN	SEAL DATE	QUOTE #	JOB #
Benjamin Stout Real Estate	Lot 6 Liberty Meadows	The Caroline / 2GRS, CP	N/A		J0822-4069
CITY / CO.	Harnett Co. / Harnett	ADDRESS	MODEL	DATE REV.	SALES REP.
		128 Solomon Drive	Floor	08/10/22	David Landry
					Marshall Naylor

▲ = Indicates Left End of Truss
(Reference Engineered Truss Drawing)
Do NOT Erect Truss Backwards

THIS IS A TRUSS PLACEMENT DIAGRAM ONLY. These trusses are designed as individual building components to be incorporated into the building design at the specification of the building designer. See individual design sheets for each truss design identified on the placement drawing. The building designer is responsible for temporary and permanent bracing of the roof and floor system and for the overall structure. The design of the truss support structure including headers, beams, walls, and columns is the responsibility of the building designer. For general guidance regarding bracing, consult BCSI-B1 and BCSI-B3 provided with the truss delivery package or online @ sbcindustry.com