

603

**SOIL/SITE EVALUATION
 for ON-SITE WASTEWATER SYSTEM**

Owner: Ben Stovt Applicant: _____
 Address: 82 Wolcott Ct (1202) Date Evaluated: 11-7-22
 Proposed Facility: SFD Design Flow (.1949): 480
 Location of Site: _____ Property Recorded: _____
 Water Supply: Public Individual Well Spring Other
 Evaluation Method: Auger Boring Pit Cut
 Type of Wastewater: Sewage Industrial Process Mixed

Property Size:

P R O F I L E #	.1940 Landscape Position/ Slope %	Horizon Depth (In.)	SOIL MORPHOLOGY .1941		OTHER PROFILE FACTORS				Profile Class & LTAR
			.1941 Structure/ Texture	.1941 Consistence Mineralogy	.1942 Soil Wetness/ Color	.1943 Soil Depth (IN.)	.1956 Sapro Class	.1944 Restr Horiz	
1	L	0-8	LS Gr	Fr/ns/wp/uxp	10YR 6/2	>48"	-	-	PS. 4 Group III
	2-5%	8-48	sci	sbk	Fr/ss/sp/sxp	≥ 24"			
2	L	0-32	LS Gr	Fr/ns/wp/uxp	10YR 6/2	>48"	-	-	PS. 4 Group III
	2-5%	32-48	sci	sbk	Fr/ss/sp/sxp	≥ 33"			
3	L	Unsuitable to wetness from 1" - 48"							
	2-5%								

Description	Initial System	Repair System	Other Factors (.1946): Site Classification (.1948): Evaluated By: Others Present:
Available Space (.1945)	✓	✓	PS M. Ash REHS
System Type(s)	25% rd	50% rd	
Site LTAR	.4	.4	

COMMENTS: _____

LANDSCAPE POSITIONS	GROUP	TEXTURES	.1955 LTAR	CONSISTENCE MOIST	WET
R-RIDGE	I	S-SAND	1.2 - 0.8	VFR-VERY FRIABLE	NS-NON-STICKY
S-SHOULDER SLOPE		LS-LOAMY SAND		FR-FRIABLE	SS-SLIGHTLY STICKY
L-LINEAR SLOPE	II	SL-SANDY LOAM	0.8 - 0.6	FI-FIRM	S-STICKY
FS-FOOT SLOPE		L-LOAM		VFI-VERY FIRM	VS-VERY STICKY
N-NOSE SLOPE	III	SI-SILT	0.6 - 0.3	EFI-EXTREMELY FIRM	NP-NON-PLASTIC
H-HEAD SLOPE		SIL-SILT LOAM			SP-SLIGHTLY STICKY
CC-CONCLAVE SLOPE		CL-CLAY LOAM			P-PLASTIC
CV-CONVEX SLOPE		SCL-SANDY CLAY LOAM			VP-VERY PLASTIC
T-TERRACE	IV	SIC-SILTY CLAY	0.4 - 0.1		
FP-FLOOD PLAN		C-CLAY			
		SC-SANDY CLAY			

STRUCTURE

- SG-SINGLE GRAIN
- M- MASSIVE
- CR-CRUMB
- GR-GRANULAR
- SBK-SUBANGULAR BLOCKY
- ABK-ANGULAR BLOCKY
- PL-PLATY
- PR-PRISMATIC

MINERALOGY

- SLIGHTLY EXPANSIVE
- EXPANSIVE

Show profile locations and other site features (dimensions, references or benchmark, and North)

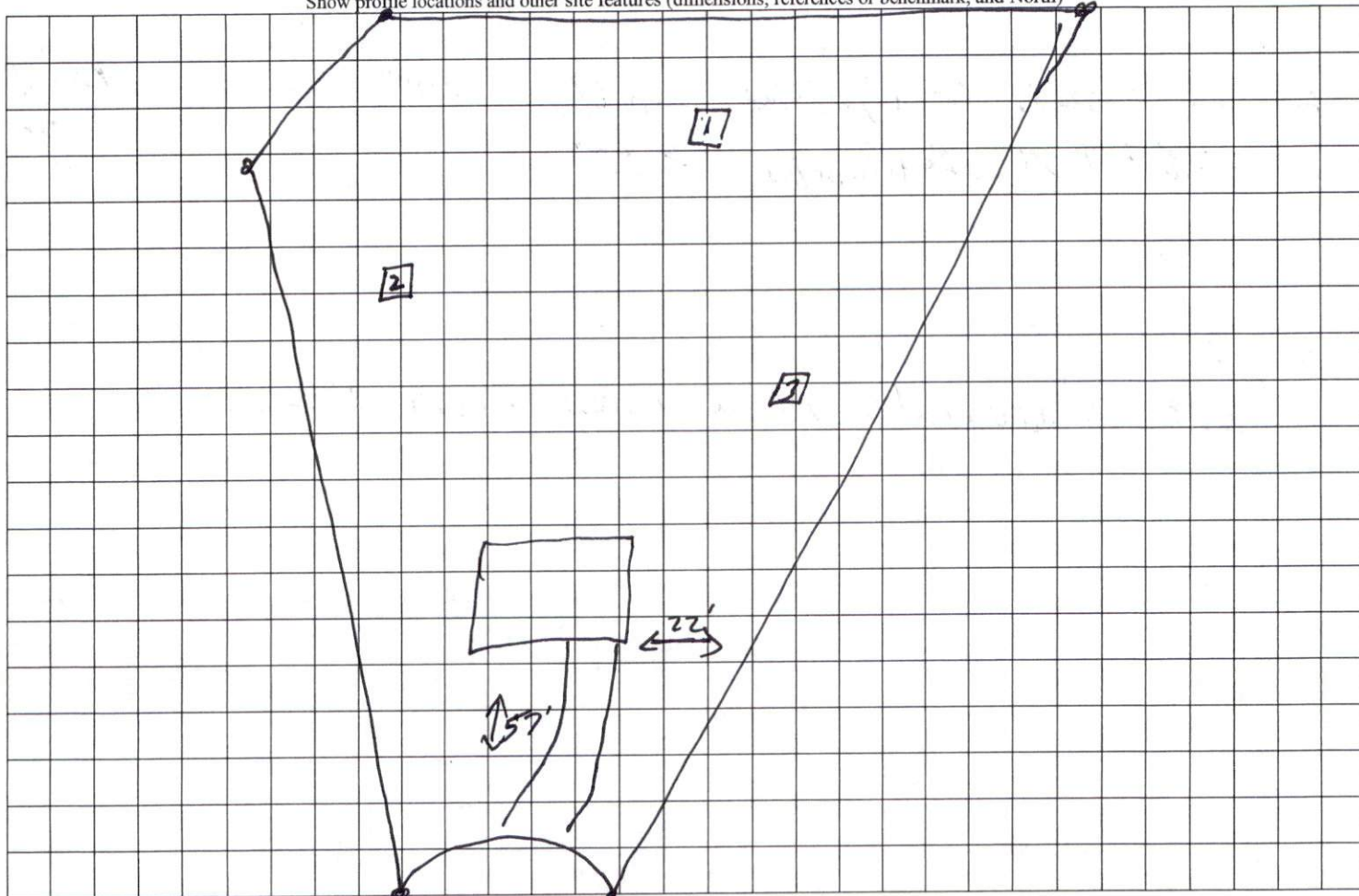

Walcott