

65

ROLLING SPRINGS SECTION 6 MB 20, PG 86

CURVE TABLE				
CURVE	LENGTH	RADIUS	BEARING	CHORD
C1	123.49'	50.00'	S34°16'48"W	94.41'

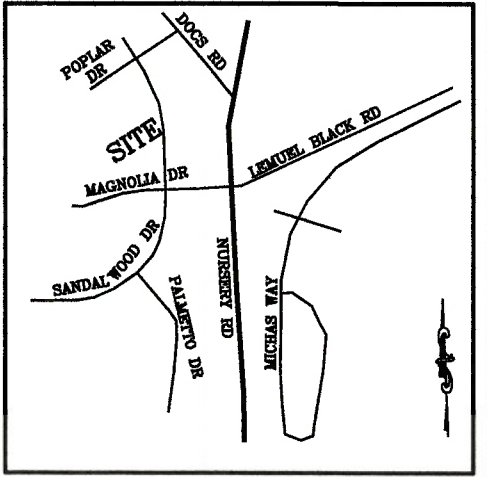

VICINITY MAP (NO SCALE)

150

1.45 ACRES
63,091 SQ. FT.

N/F WELLCO CONTRACTORS, INC DB 863, PG 792

PROPOSED HOUSE PLAN #11 (SEE INSERT 'A')

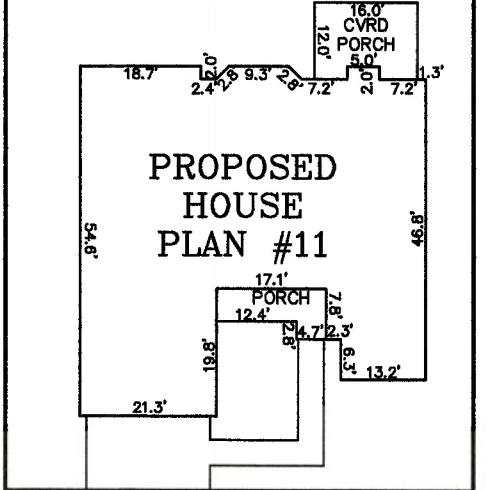

INSERT 'A' (1" = 30')

64

ROLLING SPRINGS SECTION 6 MB 20, PG 86

149

ROLLING SPRINGS SECTION 7 MB 23, SL 14

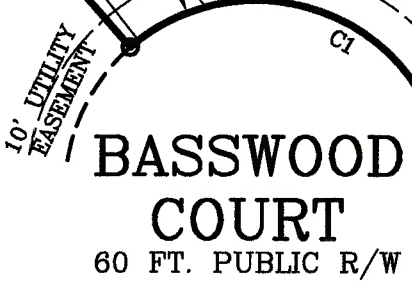

NOTE : CONTRACTOR TO VERIFY ALL BUILDING SETBACKS PRIOR TO CONSTRUCTION.

ZONING: RA-20R
SETBACKS
FRONT - 35'
REAR - 25'
SIDE - 10'

IMPERVIOUS AREA:
HOUSE, PORCHES 2,740 SQ. FT.
DRIVEWAY, SIDEWALK 1,052 SQ. FT.
TOTAL 3,792 SQ. FT.

PLOT PLAN

PLOT PLAN FOR: WELLONS REALTY
ADDRESS: BASSWOOD COURT
CITY OF: SPRING LAKE, NC
COUNTY OF: HARNETT

TOWNSHIP OF: ANDERSON CREEK
DATE: AUGUST 24TH, 2022
SCALE: 1" = 50'
REFERENCE: LOT 150
ROLLING SPRINGS SECTION 7
MB 2022, PG 369



W. Larry King 8-26-22
W. LARRY KING, PLS - L-1339

Larry King & Associates, R.L.S., P.A.
P.O. Box 53787
1333 Morganton Road, Suite 201
Fayetteville, NC 28305
Phone: (910)483-4300
Fax: (910)483-4052
www.LKandA.com
NC Firm License C-0887

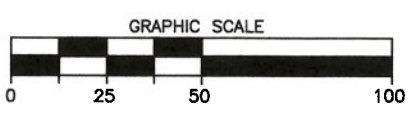

I, W. LARRY KING, CERTIFY THAT THIS MAP IS FOR THE PURPOSE OF PERMITTING ONLY, IT IS NOT A SURVEY AND NO RELIANCE MAY BE PLACED ON ITS ACCURACY. THE STRUCTURE SHOWN ON THIS PLOT PLAN IS PLACED ACCORDING TO THE INSTRUCTIONS GIVEN BY THE BUILDER. ALL DIMENSIONS AND SETBACKS SHOULD BE VERIFIED FOR COMPLIANCE WITH ZONING AND COVENANTS.

THIS MAP CAN NOT BE USED FOR RECORDATION OR ATTACHED TO A DEED TO BE RECORDED. THIS MAP IS NOT DRAWN IN ACCORDANCE WITH GS 47-30.

THE BOUNDARY AND LOT INFORMATION SHOWN ON THIS MAP IS TAKEN FROM THAT DOCUMENT DESCRIBED IN THE "REFERENCE" LINE SHOWN HEREON. THIS INFORMATION SHOULD BE CONFIRMED AS THE MOST CURRENT FOR THIS PROPERTY BEFORE ISSUANCE OF PERMITS OR COMMENCEMENT OF CONSTRUCTION. NO TITLE SEARCH WAS PERFORMED ON THIS PROPERTY BY THIS SURVEYOR.