

SED 2208-0057

**SOIL/SITE EVALUATION
 for ON-SITE WASTEWATER SYSTEM**

Owner: — Applicant: DOOR HOMES
 Address: 3901 OSMOND RD Date Evaluated: 09/06/2022
 Proposed Facility: Design Flow (.1949): Property Size:
 Location of Site: 3901 OSMOND RD Property Recorded: 3606RD
 Water Supply: Public Individual Well Spring Other
 Evaluation Method: Auger Boring Pit Cut
 Type of Wastewater: Sewage Industrial Process Mixed

P R O F I L E #	.1940 Landscape Position/ Slope %	Horizon Depth (In.)	SOIL MORPHOLOGY .1941		OTHER PROFILE FACTORS				Profile Class & LTAR
			.1941 Structure/ Texture	.1941 Consistence Mineralogy	.1942 Soil Wetness/ Color	.1943 Soil Depth (IN.)	.1956 Sapro Class	.1944 Restr Horiz	
1,3,3	L 3 3/8	0-24	GL VFL LS	W SMP VFL					PS
		24-48	GL SLL	W SMP FL	7.5 x 27.1 @ 42"	48			0.375
4,5	L 4 1/8	0-24	GL LS	VFL W SMP					PS
		24-38	GL SLL	FL SP	7.5 x 27.1 @ 36"	38			0.375
6	L 4 9/16	0-16	GL LS	VFL W SMP					U/PS
		16-30	GL SLL	FL SP	7.5 x 27.1 @ 28"	30			0.375

Description	Initial System	Repair System	Other Factors (.1946): Site Classification (.1948): <u>PROVISIONALLY SUITABLE</u> Evaluated By: <u>ANDREW COLLINS, PERS</u> Others Present:
Available Space (.1945)	<input checked="" type="checkbox"/>	<input checked="" type="checkbox"/>	
System Type(s)	<u>25/6 1057</u>	<u>25/6 1057</u>	
Site LTAR	<u>0.375</u>	<u>0.375</u>	

COMMENTS: _____

LANDSCAPE POSITIONS	GROUP	TEXTURES	.1955 LTAR	CONSISTENCE MOIST	WET
R-RIDGE	I	S-SAND	1.2 - 0.8	VFR-VERY FRIABLE	NS-NON-STICKY
S-SHOULDER SLOPE		LS-LOAMY SAND		FR-FRIABLE	SS-SLIGHTLY STICKY
L-LINEAR SLOPE	II	SL-SANDY LOAM	0.8 - 0.6	FI-FIRM	S-STICKY
FS-FOOT SLOPE		L-LOAM		VFI-VERY FIRM	VS-VERY STICKY
N-NOSE SLOPE	III	SI-SILT	0.6 - 0.3	EFI-EXTREMELY FIRM	NP-NON-PLASTIC
H-HEAD SLOPE		SIL-SILT LOAM		SP-SLIGHTLY STICKY	
CC-CONCLAVE SLOPE		CL-CLAY LOAM		P-PLASTIC	
CV-CONVEX SLOPE		SCL-SANDY CLAY LOAM		VP-VERY PLASTIC	
T-TERRACE	IV	SIC-SILTY CLAY	0.4 - 0.1		
FP-FLOOD PLAN		C-CLAY			
		SC-SANDY CLAY			

STRUCTURE

- SG-SINGLE GRAIN
- M- MASSIVE
- CR-CRUMB
- GR-GRANULAR
- SBK-SUBANGULAR BLOCKY
- ABK-ANGULAR BLOCKY
- PL-PLATY
- PR-PRISMATIC

MINERALOGY

- SLIGHTLY EXPANSIVE
- EXPANSIVE

⑥

⑤

Show profile locations and other site features (dimensions, references or benchmark, and North)

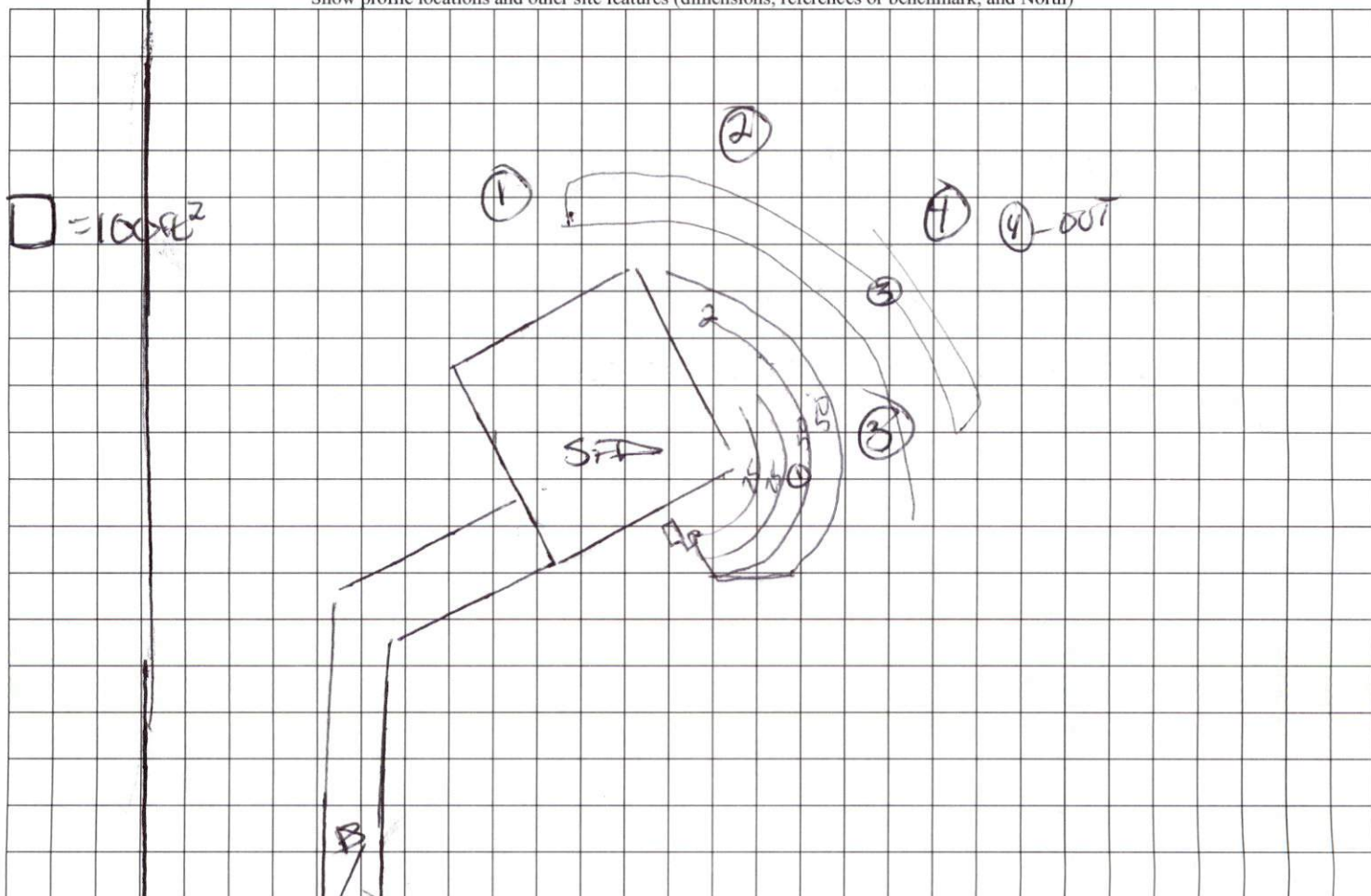

JM
 1,2,3,6-2026 0-10SL P&G&NSP
 10-40SCLAY Silty from
 SBK
 VSVP
 Site vid Be A
 .25:32 — .055-.4
 4 - OUT WET