



**ECS Southeast, LLP**

6151 Raeford Road, Suite A  
Fayetteville, NC 28304  
9104013288  
9103230539

**LETTER OF TRANSMITTAL**

September 29, 2022  
W.S. Wellons Realty  
PO Box 766  
Spring Lake, NC 28390  
ATTN: Accounts Payable

RE: **Wellons Realty Lot 113**  
ECS Job # **33:6204-C**  
  
Permits:  
Location: **62 Black Oak Place**  
**Spring Lake, NC 28390**

Field Reports       For your use       As requested

CC: W.S. Wellons Realty - Jason Wellons

ENCL: Field Report # 1      9/29/2022



**SEP 29 2022**

Jack Cowsert, P.E.  
Office Manager

Aaron Adair  
Team Leader

*Disclaimer*

1. This report (and any attachments) shall not be reproduced except in full without prior written approval of ECS.
2. The information in this report relates only to the activities performed on the report date.
3. Where appropriate, this report includes statements as to compliance with applicable project drawings, and specifications for the activities, performed on this report date.
4. Incomplete or non-conforming work will be reported for future resolution.
5. The results of samples and/or specimens obtained or prepared for subsequent laboratory testing will be presented in separate reports/documents.



ECS Southeast, LLP  
 6151 Raeford Road, Suite A  
 Fayetteville, NC 28304  
 (910) 401-3288 [Phone]  
 (910) 323-0539 [Fax]

## FIELD REPORT

Project **Wellons Realty Lot 113**  
 Location **Spring Lake, NC**  
 Client **W.S. Wellons Realty**  
 Contractor **None Listed**

Project No. **33:6204-C**  
 Report No. **1**  
 Day & Date **Thursday 9/29/2022**  
 Weather **66 °/ Cloudy**  
 On-Site Time **1.50**  
 Lab Time **0.00**  
 Travel Time\* **0.00**  
 Total **1.50**  
 Re Obs Time **0.00**

Remarks

Trip Charges*	Tolls/Parking*	Mileage*	Time of Arrival	Departure
Chargeable Items			<b>10:30A</b>	<b>12:00P</b>

\* Travel time and mileage will be billed in accordance with the contract.

**Summary of Services Performed (field test data, locations, elevations & depths are estimates) & Individuals Contacted.**

An ECS representative arrived on site, as requested, to check the bearing capacity of soils via hand auger/DCP method for monolithic slab foundation. Please see the attached sketch for location details.

A hand auger was used to advance the boreholes to different depths noted on the boring logs. Dynamic Cone Penetrometer (DCP) test were performed in the hand auger boreholes by a 1.5 inch diameter cone driven into the soil by a 15 pound ring weight with a free fall of 20 inches. The number of blows required to drive the cone into the soil a distance of 1.75 inches is termed the DCP Value and is indicated for each test on the hand auger.

A total of 4 hand auger/DCP evaluations were performed to a depth of approximately 3 feet below the current sub grade elevation. It is to the opinion of ECS that the materials in place (at the locations and elevations tested) did appear to be suitable to support the design bearing capacity 2000 psf.

ECS will return, as requested, to perform additional services.

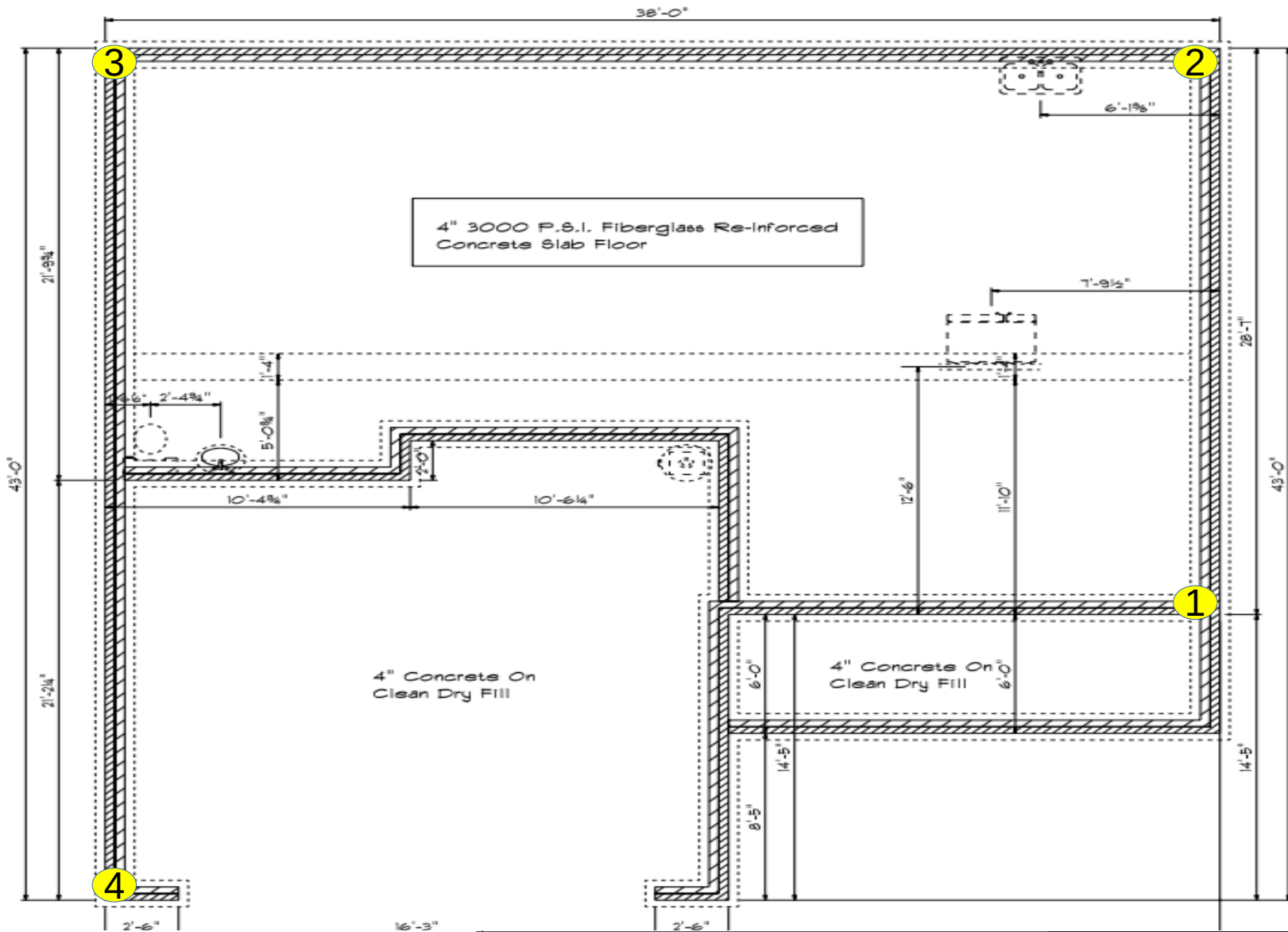

George Oxendine  
 DATE 9/29/2022  
 Job: Wellons Lot 113  
 J#: 6204-C  
 W.O.#: 69035

**KEY**

DCP Locations



Design Sheet #:



North



## Report of Spread Footing - Foundation Observations

Project: Wellons Realty Lot 113  
 Location: 62 Black Oak Place  
 Spring Lake - Cumberland - NC - 28390  
 Contractor: None Listed

Project No.: 33:6204-C  
 Day/Date: 9/29/2022

Footing Number	Location	Size (W x H x L)		Footing Bottom Elevation		Description of Steel Placed	Description of Subgrade Material	Required Blow Counts # of Blows / Increment	Design Bearing Pressure
		Design	Actual	Design **	Depth of Undercut (in)				
1	south east corner	x x	x x	N/A	N/A		(0/-1) orange sand (-2/-3) tan sand	6 (0)2,4,5(-1)8,5,7(-2) 8,9,14(-3)10,11,12	2000
2	north east corner	x x	x x	N/A	N/A		(0/-1) orange sand (-2/-3) tan sand	6 (0)11,11,13(-1)12,14,13 (-2)14,14,13(-3)9,9,11	2000
3	north west corner	x x	x x	N/A	N/A		(0/-1) brown sand (-2/-3) tan sand	6 (0)4,4,5(-1)14,17,18(-2) 10,9,8(-3)6,7,7	2000
4	south west corner	x x	x x	N/A	N/A		(0/-1) orange sand (-2/-3) tan sand	6 (0)4,5,6(-1)10,13,15(-2) 10,16,12(-3)17,17,15	2000

\*\* SGE: Subgrade Elevation to be determined by surveyor.

By: George Pate Oxendine Jr.

ECS Southeast, LLP



## Report of Spread Footing - Foundation Observations

Project: Wellons Realty Lot 113  
Location: 62 Black Oak Place  
Spring Lake - Cumberland - NC - 28390  
Contractor: None Listed

Project No.: 33:6204-C  
Day/Date: 9/29/2022

WO: 69035