

3-Bedroom Septic Plan  
 Lot #4 – Duncan’s Crossing  
 Harnett County  
 Smith Douglas Homes

4

42,317 SF  
 (0.97 AC)

\*House footprint to be field staked by surveyor and system verified prior to any construction

\*\*Septic area must not be altered by construction activities.

\*\*\*No cuts of 2’ or greater within 15’ of septic area

\*\*\*\* Recommend protective barrier around septic field during construction.

\*If plumbing is not sufficient a pump tank will be required to septic field.

System: Gravity to Serial Dist.  
 Lines: Lines 1–4 (240’)  
 0.4 LTAR  
 18” Max Trench Bottom  
 Accepted Status System  
 Repair: Pressure Manifold  
 Lines: Lines 5–7 (180’)  
 0.35 LTAR  
 24” Trench Bottom  
 T&J Panel – 50% Reduction

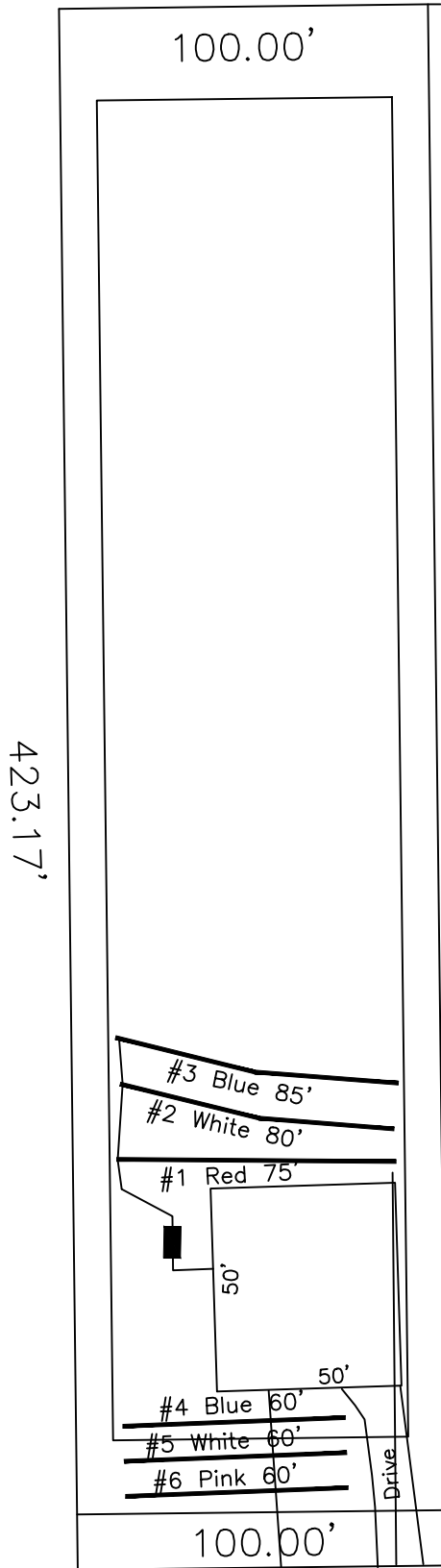

**DOUBLE BARRELL STREET**  
 50' R/W (PUBLIC & UTILITY ACCESS)

GRAPHIC SCALE  
 1" = 50'



Adams  
 Soil Consulting  
 919-414-6761  
 Job #1146