

FEMA FLOOD HAZARD STATEMENT
 The subject property shown on this plot is located within the FEMA "Zone X" (Minimal Flood Risk) Area as shown on FIRM Number: 3720068000J Effective date: 10/3/2006

LINE LEGEND:
 - Subject Boundary Surveyed
 - Subject Boundary Not Surveyed
 - Adjacent Property Lines
 - Abandoned Property Lines
 - Right of Way Lines
 - Center of Right-of-Way
 - Easement Lines
 - Survey Tie Lines
 - Minimum Building Setback
 - Overhead Electric Lines
 - Water Line

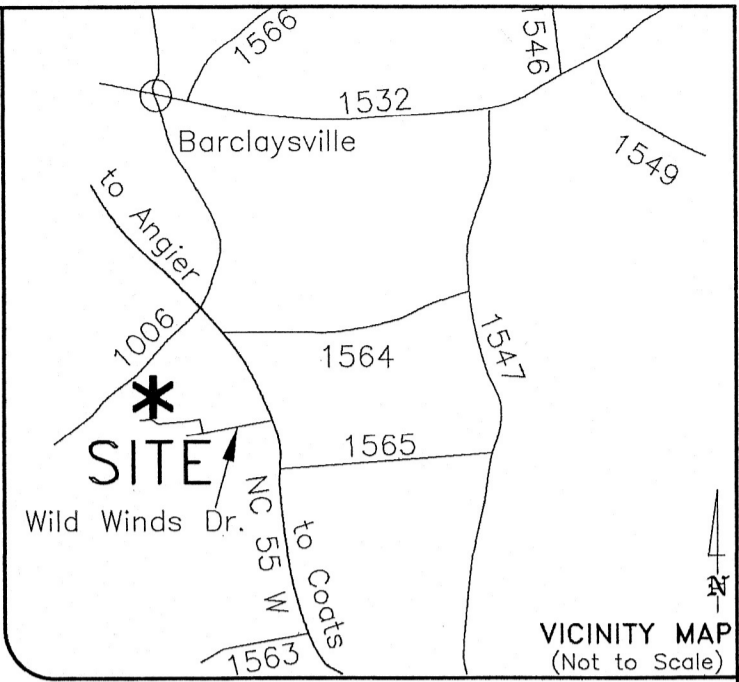

Harnett County Minimum Building Setback Requirements
 RA-20R, RA-20M, RA-30 & RA-40
 FRONT: 35' from R/W
 REAR: 25'
 SIDE: 10'
 CORNER LOT SIDE: 20'
 MAXIMUM HEIGHT: 35'

SYMBOLS & ABBREVIATIONS:
 ● EIP/EIS... Existing Iron Pipe or Stake
 ● ERB... Existing ReBar Stake
 ● ERRS... Existing Rail Road Spike
 ● EPK... Existing Parker-Kaylon Nail
 ● EMN... Existing Magnetic Nail
 ● ECS... Existing Cotton Picker Spindle
 ⊠ ECM... Existing Concrete Monument
 AG/BG... Above/Below Ground Surface
 △ CP... Calculated Point (not set)
 ⊙ CNTRL... Control Point - Grid Coordinates
 ○ ISS... Iron Stake Set (#4 rebar)
 ⊙ MNS... Magnetic Nail Set
 ⊙ CSS... Cotton Spindle Set
 ● FH... Fire Hydrant
 ● PP... Power Pole
 ○ OHE... Overhead Electric Lines
 ↗ Land Hook (Property combined)
 C/L... Centerline of Road or Easement
 R/W... Right-of-Way
 D.B... Deed Book
 P.B/P.C... Plat Book / Plat Cabinet
 M.B... Map Book
 NC PIN... Parcel Identifier Number
 Ac... Acres (Area of property)
 SF... Square Feet
 [123]... House Address

SURVEY NOTES:

- Iron Stakes (1/2" Re-bar) set at all new property corners unless labeled otherwise.
- Magnetic Nails set at all points in paved road surfaces, unless otherwise indicated.
- Areas determined by coordinate method.
- All distances & dimensions are horizontal ground distances unless otherwise indicated.
- No NC Geodetic Survey monuments or other such control monuments were found within 2,000 feet of the subject property unless otherwise shown hereon.
- This survey is based upon the references shown as taken from County GIS records. No title search was provided for this survey. A complete title search by a licensed attorney may reveal other easements, restrictions, and title issues not made available to the surveyor.
- No underground utilities were marked by providers prior to this survey. Call NC 811 prior to any excavation to locate any underground utilities.
- Wetlands, soil conditions, or other environmental features were not delineated for this survey.

Note: This portion of the 30' Easement as shown on Plat Cabinet F, 556-A lying East of Wild Horse Run (50' R/W) has apparently been abandoned and no longer used for access.

Access Note:
 The subject property (2.30 Acres) is accessed from NC 55 via Wild Winds Drive (60' Public R/W), Wild Horse Run (50' Private Easement), and Wild Horse Run (30' Private Easement).

North Carolina
 Harnett County

I, Robert E. Godwin, Jr., hereby certify that this plat was drawn under my supervision from an actual survey made under my supervision per deed description recorded in Book 4104, Page 5; That the boundaries not surveyed are shown as broken lines plotted from references as shown hereon; That the ratio of precision meets or exceeds Class B standards; That there were no encroachments across surveyed property lines unless otherwise shown hereon; And that this survey was conducted in accord with The Standards of Practice for Land Surveying in North Carolina (21 NCAC 56-1600) and this map may not meet all statutory mapping requirements for recordation. Witness my original signature, license number, and seal this the 7th day of JULY, A.D. 2022

Robert E. Godwin, Jr. P.L.S.
 License Number: L-3790

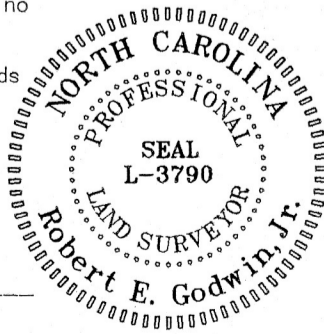

REFERENCE:
 -Deed Book 4104, Pg. 5
 -Map #2021-623

Revisions:
July 5, 2022: Add Proposed House

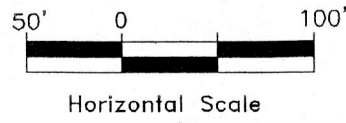

"Plot Plan"
 Survey For:
Brian Ellis & Katherine E. Pope
 381 Wild Horse Run, Coats, NC 27521-8998

PROPERTY ADDRESS: 334 Wild Horse Run, Coats, NC 27521

GROVE TOWNSHIP - HARNETT COUNTY - NORTH CAROLINA

ZONE: RA-30 ~ PIN: 0691-19-3165.000 ~ PID: 070690 0201 20

STREAMLINE LAND SURVEYING, Inc.
 NC FIRM C-1898
 870 NC 55 W, Coats, N.C. 27521
 Phone: 910-897-7715

SURVEYED DATE: OCTOBER 1, 2021 & JULY 5, 2022

SCALE: 1" = 100' | SURVEYED BY: REG | DRAWN BY: MGG

FILE: DATA\0691\211001PO.dwg (PlotPlan)