

VICINITY MAP
(NO SCALE)

LEGEND			
△	DENOTES CONTROL CORNER		
□	CONCRETE MONUMENT		
○	DENOTES BREAK IN LINE		
EIP	EXISTING IRON PIPE		
EIR	EXISTING IRON REBAR		
SIR	SET IRON REBAR		
EMN	EXISTING MAG NAIL		
SMN	SET MAG NAIL		
AG	ABOVE GROUND	REC	RECORDED
BG	BELOW GROUND	MEAS	MEASURED
NOTE 1/2" IRON REBAR SET FLUSH W/ THE GROUND AT ALL PROPERTY CORNERS			

52

ABJ INVESTMENTS LLC
PIN# 0565-71-6731.000
P.B. 2022, PG. 222
D.B. 3551, PG. 111

53

ABJ INVESTMENTS LLC
PIN# 0565-71-6846.000
P.B. 2022, PG. 222
D.B. 3551, PG. 111

55

0.46 ACRES
20,246 SQ. FT.

56

ABJ INVESTMENTS LLC
PIN# 0565-71-4667.000
P.B. 2022, PG. 222
D.B. 3551, PG. 111

54

JSJ BUILDERS INC
PIN# 0565-71-5954.000
P.B. 2022, PG. 222
D.B. 4158, PG. 2031

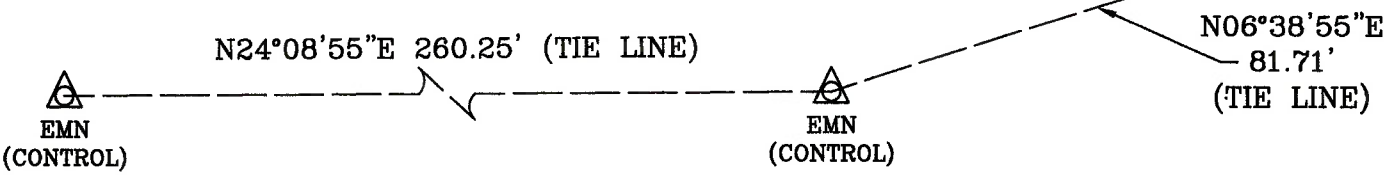
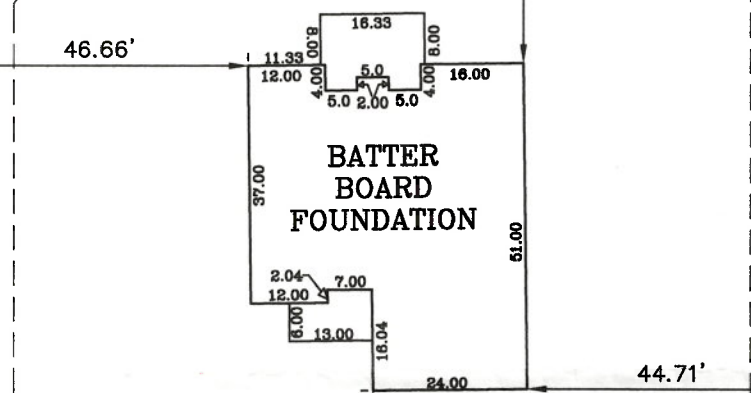

ROCKING CANAL PLACE

50 FT. PUBLIC R/W

FOUNDATION SURVEY

SURVEY FOR: JSJ BUILDERS

ADDRESS: ROCKING CANAL PLACE

CITY OF: ERWIN, NC

COUNTY OF: HARNETT

TOWNSHIP OF: STEWARTS CREEK

DATE: SEPT 16TH, 2022

SCALE: 1" = 30'

REFERENCE: LOT 55
WILLIAMS FARM
PHASE TWO
P.B. 2022, PG. 222

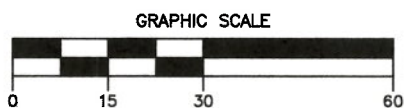

Larry King & Associates, R.L.S., P.A.
P.O. Box 53787
1333 Morganton Road, Suite 201
Fayetteville, NC 28305
Phone: (910)483-4300
Fax: (910)483-4052
www.LKandA.com
NC Firm License C-0887

"I certify that this map was drawn under my supervision from an actual survey made under my supervision (deed description recorded in P.B. 2022, PG. 222 or other reference source as shown); that the boundaries not surveyed are indicated as drawn from information in Book and page as referenced above that the ratio of precision or positional accuracy is > 1:10,000, and that this map meets the requirements of The Standards of Practice for Land Surveying in North Carolina (21 NCAC 56.1600)."

9-17-22
W. Larry King, Professional Land Surveyor L-1339