

CURVE	ARC	RADIUS	CHORD LENGTH	CHORD BEARING
C1	100.00	255.00	99.36	N 89°49'04" E

GENERAL NOTES:
 1. ALL DISTANCES ARE HORIZONTAL GROUND DISTANCES MEASURED IN U.S. SURVEY FEET.
 2. AREAS COMPUTED BY COORDINATE METHOD.
 3. THIS SURVEY DONE WITHOUT THE BENEFIT OF A TITLE SEARCH.
 4. ALL IRONS FOUND ARE FLUSH WITH GROUND UNLESS OTHERWISE NOTED.
 5. ANY DRAINAGEWAYS SHOWN HEREON AND/OR ADJACENT TO THIS SITE MAY CREATE ADDITIONAL BUFFERS CLAIMED BY THE STATE OF NORTH CAROLINA OR OTHER REGULATORY AGENCY.

LEGEND:
 ● IRON PIPE FOUND
 ○ IRON PIPE SET

VICINITY MAP
 NOT TO SCALE

DB 3965 Pg.440

OPEN SPACE BOOK 2021 Pg.373

N 87°23'07" W 182.10'

NAD 83 (2011)
 NC GRID COORDINATES
 N = 636268.0662
 E = 2037559.6044
 REF: BOOK 2021 Pg.373

LOT 61
 0.601 AC
 (BY COORDINATES)

LOT 60

LOT 62

S 06°05'49" E 193.45'

N 18°38'52" E 193.91'

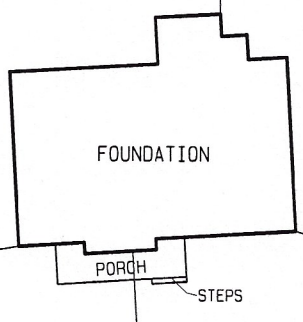

20' PUBLIC UTILITY EASEMENT

PRINCE PLACE DRIVE
 50' PUBLIC R/W & UTILITY EASEMENT

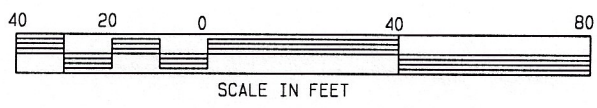
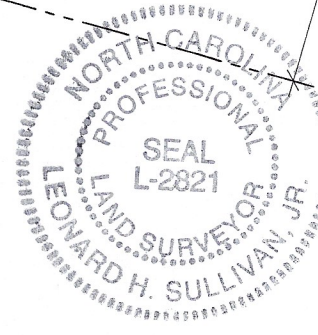

238 PRINCE PLACE DRIVE

MAP 2021 PAGE 373 DEED BOOK 4066 PAGE 727 * NOT FOR RECORDATION *

LOT 61 PHASE 1 PRINCE PLACE SUBDIVISION

I, LEONARD H. SULLIVAN JR., DO HEREBY CERTIFY THAT THIS PLAT WAS DRAWN UNDER MY SUPERVISION FROM AN ACTUAL SURVEY MADE UNDER MY SUPERVISION USING REFERENCES SHOWN HEREON; THAT THE BOUNDARIES NOT SURVEYED ARE SHOWN AS BROKEN LINES PLOTTED FROM INFORMATION SHOWN HEREON; THAT THE RATIO OF PRECISION AS CALCULATED IS 1:10,000+; THAT THIS PLAT MEETS THE STANDARDS OF PRACTICE FOR LAND SURVEYING IN NORTH CAROLINA (21 NCAC 56, 1600). WITNESS MY ORIGINAL SIGNATURE, REGISTRATION NUMBER (L-2821) AND SEAL.

ALSO, I CERTIFY THAT THIS SURVEY IS OF AN EXISTING PARCEL OR PARCELS OF LAND AND DOES NOT CREATE A NEW STREET OR CHANGE AN EXISTING STREET.

SRV'D: ALY DRAWN: TAH CHK'D: LHS JOB # 5531922 DATE: 05 OCT. 2022 SCALE: 1" = 40'

SULLIVAN SURVEYING
 LAND SURVEYORS
 1143-D EXECUTIVE CIRCLE
 CARY, NORTH CAROLINA 27511
 TELEPHONE: (919) 469-4738

SURVEY FOR:
 HALCYON HOMES
 HECTORS CREEK TOWNSHIP, HARNETT COUNTY, NORTH CAROLINA