

**SOIL/SITE EVALUATION
 for ON-SITE WASTEWATER SYSTEM**

Owner: *Ken Dowson Homes*
 Applicant:

Address: *65 Remington Hill Dr*
 Proposed Facility: *SFD*

Date Evaluated: *6-21-22*
 Design Flow (.1949): *360 GPD*

Property Size:

Location of Site: Property Recorded:
 Water Supply: Public Individual Well Spring Other
 Evaluation Method: Auger Boring Pit Cut
 Type of Wastewater: Sewage Industrial Process Mixed

P R O F I L E #	.1940 Landscape Position/ Slope %	Horizon Depth (In.)	SOIL MORPHOLOGY .1941		OTHER PROFILE FACTORS				Profile Class & LTAR
			.1941 Structure/ Texture	.1941 Consistence Mineralogy	.1942 Soil Wetness/ Color	.1943 Soil Depth (IN.)	.1956 Sapro Class	.1944 Restr Horiz	
<i>1, 2 3</i>	<i>L</i>	<i>0-26</i>	<i>LS G-</i>	<i>Fr/NS/NSP/NSP</i>	<i>10YR 7/2</i>	<i>>48"</i>	<i>—</i>	<i>—</i>	<i>PS. 4</i>
	<i>2-52</i>	<i>26-48</i>	<i>SC1</i>	<i>SBk Fr/SS/SP/SP</i>	<i>≥ 40"</i>				<i>Group III</i>

Description	Initial System	Repair System	Other Factors (.1946): Site Classification (.1948): <i>PS</i> Evaluated By: <i>MLP RCH</i> Others Present:
Available Space (.1945)	<i>✓</i>	<i>✓</i>	
System Type(s)	<i>25% red</i>	<i>25% red</i>	
Site LTAR	<i>.4</i>	<i>.4</i>	

COMMENTS: _____

LANDSCAPE POSITIONS	GROUP	TEXTURES	.1955 LTAR	CONSISTENCE MOIST	WET
R-RIDGE	I	S-SAND	1.2 - 0.8	VFR-VERY FRIABLE	NS-NON-STICKY
S-SHOULDER SLOPE		LS-LOAMY SAND		FR-FRIABLE	SS-SLIGHTLY STICKY
L-LINEAR SLOPE	II	SL-SANDY LOAM	0.8 - 0.6	FI-FIRM	S-STICKY
FS-FOOT SLOPE		L-LOAM		VFI-VERY FIRM	VS-VERY STICKY
N-NOSE SLOPE				EFI-EXTREMELY FIRM	NP-NON-PLASTIC
H-HEAD SLOPE	III	SI-SILT	0.6 - 0.3		SP-SLIGHTLY STICKY
CC-CONCLAVE SLOPE		SIL-SILT LOAM			P-PLASTIC
CV-CONVEX SLOPE		CL-CLAY LOAM			VP-VERY PLASTIC
T-TERRACE		SCL-SANDY CLAY LOAM			
FP-FLOOD PLAN	IV	SIC-SILTY CLAY	0.4 - 0.1		
		C-CLAY			
		SC-SANDY CLAY			

STRUCTURE
 SG-SINGLE GRAIN
 M- MASSIVE
 CR-CRUMB
 GR-GRANULAR
 SBK-SUBANGULAR BLOCKY
 ABK-ANGULAR BLOCKY
 PL-PLATY
 PR-PRISMATIC

MINERALOGY
 SLIGHTLY EXPANSIVE
 EXPANSIVE

← Lemuel Black Rd →
 Show profile locations and other site features (dimensions, references or benchmark, and North)

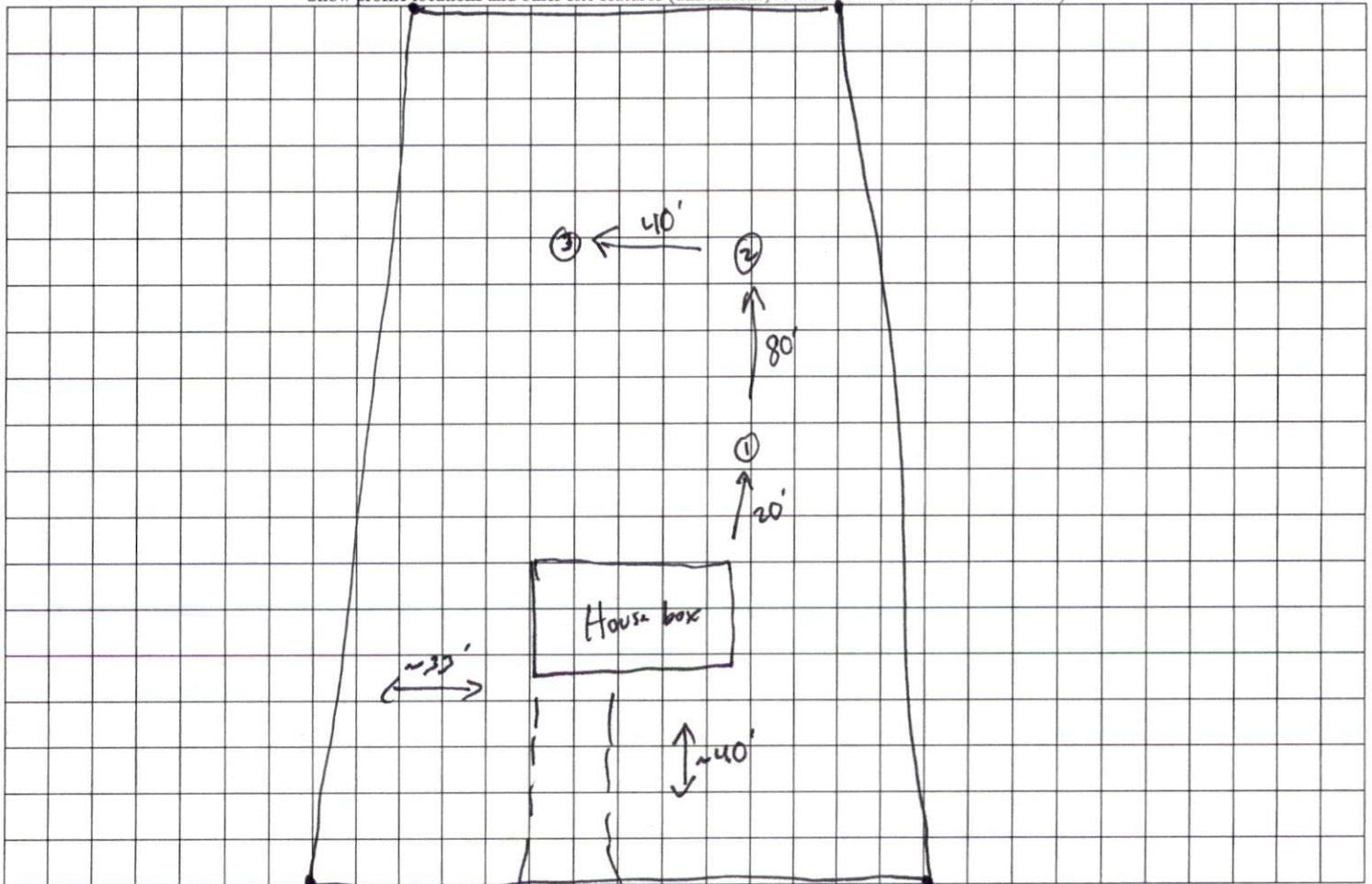

← Remington Hill Dr →