



# ROOF & FLOOR TRUSSES & BEAMS

Reilly Road Industrial Park  
Fayetteville, N.C. 28309  
Phone: (910) 864-8787  
Fax: (910) 864-4444

**THIS IS A TRUSS PLACEMENT DIAGRAM ONLY.**  
These trusses are designed as individual building components to be incorporated into the building design at the specification of the building designer. See individual design sheets for each truss design identified on the placement drawing. The building designer is responsible for temporary and permanent bracing of the roof and floor system and for the overall structure. The design of the truss support structure including headers, beams, walls, and columns is the responsibility of the building designer. For general guidance regarding bracing, consult BCSI-B1 and BCSI-B3 provided with the truss delivery package or online @ sbindustry.com

Bearing reactions less than or equal to 3000# are deemed to comply with the prescriptive Code requirements. The contractor shall refer to the attached Tables (derived from the prescriptive Code requirements) to determine the minimum foundation size and number of wood studs required to support reactions greater than 3000# but not greater than 15000#. A registered design professional shall be retained to design the support system for any reaction that exceeds those specified in the attached Tables. A registered design professional shall be retained to design the support system for all reactions that exceed 15000#.

Signature  
**Johnnie Baggett**

### LOAD CHART FOR JACK STUDS

(BASED ON TABLES R502.5(1) & (b))

NUMBER OF JACK STUDS REQUIRED @ EA END OF HEADER/GIRDER		NUMBER OF JACK STUDS REQUIRED @ EA END OF HEADER/GIRDER		NUMBER OF JACK STUDS REQUIRED @ EA END OF HEADER/GIRDER	
END REACTION (UP TO) (1) BY HEADER	REQ. STUDS FOR (2) BY HEADER	END REACTION (UP TO) (1) BY HEADER	REQ. STUDS FOR (2) BY HEADER	END REACTION (UP TO) (1) BY HEADER	REQ. STUDS FOR (2) BY HEADER
1700	1	2550	1	3400	1
3400	2	5100	2	6800	2
5100	3	7650	3	10200	3
6800	4	10200	4	13600	4
8500	5	12750	5	17000	5
10200	6	15300	6		
11900	7				
13600	8				
15300	9				

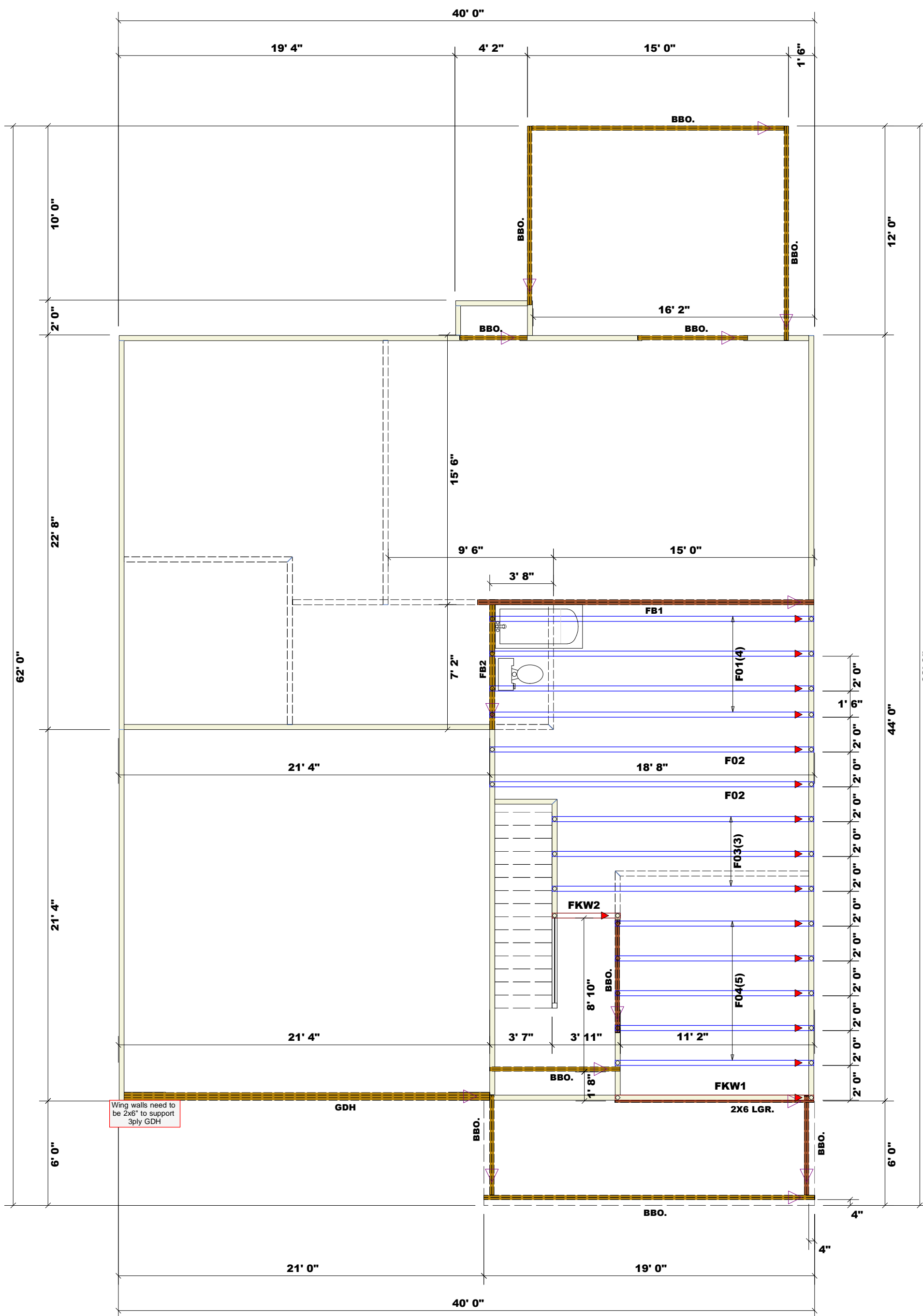

**Plumbing Drop Notes**  
1. Plumbing drop locations shown are NOT exact.  
2. Contractor to verify ALL plumbing drop locations prior to setting Floor Trusses.  
3. Adjust spacing as needed not to exceed 24"oc.

**Dimension Notes**  
1. All exterior wall to wall dimensions are to face of sheathing unless noted otherwise.  
2. All interior wall dimensions are to face of frame wall unless noted otherwise.  
3. All exterior wall to truss dimensions are to face of frame wall unless noted otherwise.

Roof Area = 2789.34 sq.ft.  
Ridge Line = 77.43 ft.  
Hip Line = 5.05 ft.  
Horiz. OH = 187.41 ft.  
Raked OH = 229.98 ft.  
Decking = 96 sheets

All Walls Shown Are Considered Load Bearing

▲ = Indicates Left End of Truss (Reference Engineered Truss Drawing)  
Do Not Erect Trusses Backwards

**WALL SCHEDULE**

PlotID	Length	Product	Products		
			Piles	Net Qty	Fab Type
FB2	8' 0"	1-3/4"x 9-1/4" LVL Kerto-S	2	2	FF
GDH	21' 0"	1-3/4"x 16" LVL Kerto-S	3	3	FF
FB1	20' 0"	1-3/4"x 16" LVL Kerto-S	2	2	FF

Wing walls need to be 2x6" to support 3ply GDH

<b>BUILDER</b>	Signature Home Builders	<b>COUNTY</b>	Harnett
<b>JOB NAME</b>	Lot 15 Williams Farm	<b>ADDRESS</b>	Lot 15 Williams Farm, Erwin NC
<b>PLAN</b>	2066	<b>MODEL</b>	Floor
<b>SEAL DATE</b>	4/7/22	<b>DATE REV.</b>	7/25/24
<b>QUOTE #</b>		<b>DRAWN BY</b>	Johnnie Baggett
<b>JOB #</b>	J0724-4211	<b>SALESMAN</b>	Anthony Williams