

SECOND FLOOR STRUCTURAL PLAN 14'-0" x 14'-0"

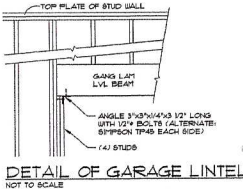

STRUCTURAL LEGEND	
RAFTERS (8'-10")	RAFTERS 2x4'S @ 16" O.C. UNLESS NOTED OTHERWISE
FL. JOISTS (24")	FLOOR JOISTS 2x4'S @ 16" O.C. WITH BRIDGING UNLESS NOTED OTHERWISE
CLG. JOISTS (24")	CEILING JOISTS 2x4'S @ 16" O.C. UNLESS NOTED OTHERWISE
---	PHANTOM LINE INDICATES STEEL BEAM
---	THIS SYMBOL INDICATES LOAD BEARING INTERIOR WALLS. ALL EXTERIOR WALLS ARE LOAD BEARINGS
---	DASH LINE INDICATES ROOF FRAMING
---	CENTER LINE INDICATES (2) 2x4'S BEAM BELOW ROOF UNLESS NOTED OTHERWISE. (SEE STUD NOTE (2) BELOW)
(3)	INDICATES THE NUMBER OF STUDS UNDER BEAM AND/OR NOTE # NUMBER OF STUDS AT BEAM ENDS ARE NOT INDICATED. USE (2) STUDS
---	BRACE ROOF TO WALL OR BEAM BELOW WITH 2x4'S @ 32" O.C.

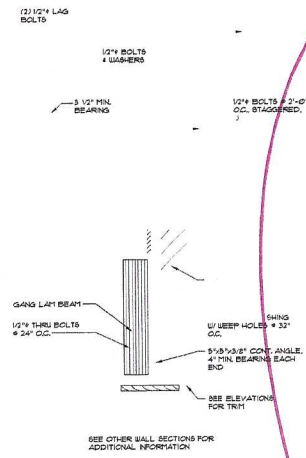
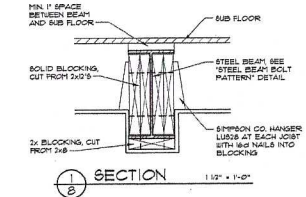

SPARKS ENGINEERING, PLLC

Copyright © Donald A. Gardner Architects, Inc.
 REG. # 130099-LIKE
 This plan may be used only for the project and location shown on this drawing. No other use without the express written consent of Sparks Engineering, PLLC. The information contained herein is confidential and proprietary to Sparks Engineering, PLLC. Any unauthorized use or disclosure of this information is strictly prohibited. Sparks Engineering, PLLC is not responsible for any errors or omissions on this drawing. Sparks Engineering, PLLC is not responsible for any damage or injury resulting from the use of this drawing. Sparks Engineering, PLLC is not responsible for any damage or injury resulting from the use of this drawing. Sparks Engineering, PLLC is not responsible for any damage or injury resulting from the use of this drawing.

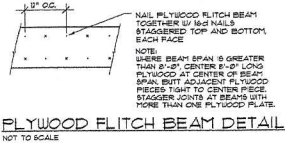
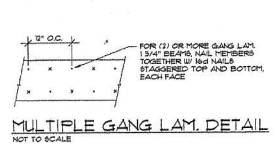

- STRUCTURAL NOTES**
- ROOF FRAMING DESIGN IS CONVENTIONAL (STEEL) FRAMING. FOR CONVERSION TO INSULATED TRUSS FRAMING, CONSULT A LOCAL TRUSS MANUFACTURER.
 - PROVIDE 2x4 COLLAR TIE @ 8' O.C. IN TOP THIRD OR TOP 3'-0" OF ATTIC SPACE IN ACCORDANCE WITH LOCAL BUILDING CODE.
 - UNLESS NOTED OTHERWISE ALL INTERIOR DOOR AND WINDOW OPENINGS IN LOAD BEARING WALLS SHALL HAVE (2) 2x4'S LINTEL WITH (2) STUDS AT EACH LINTEL END (TYPICAL).
 - UNLESS NOTED OTHERWISE ALL EXTERIOR DOOR AND WINDOW OPENINGS SHALL HAVE (2) STUDS WITH 10" PLYWOOD PLATE LINTEL. USE (2) STUDS AT LINTEL ENDS UNLESS OTHERWISE NOTED. PROVIDE STEEL LINTEL ANGLE WITH 4" MIN. BEARING WHERE REQUIRED OVER EXTERIOR PARTIALLY WALL OPENINGS.
 - AT ALL BUILDING CORNERS USE NOMINAL 10" STRUCTURAL GRADE 2 PLYWOOD OR NOMINAL 12" OSB (ORIENTED STRAND BOARD) WITH 4" O.C. LINTEL USE #6 NAILS @ 4" O.C. FOR EDGE NAILING AND 12" O.C. FOR ALL INTERMEDIATE NAILING.
 - CONCRETE INDICATED ARE MANUFACTURED BY THE SPRINKLER STRENGTH COMPANY, INC., SAN LEANDRO, CALIFORNIA. PART # 600-088-1000.

- DESIGN CRITERIA**
- (NOTE: ACTUAL DESIGN CRITERIA IN YOUR AREA MAY VARY. IT IS THE RESPONSIBILITY OF THE DESIGNER TO VERIFY THESE.)
- FRAMING DESIGN BASED ON THE FOLLOWING LOADING CONDITIONS:
 ROOF FLOOR DEAD LOADS = 15 PSF
 ROOF LIVE LOAD = 20 PSF
 FLOOR LIVE LOAD = 40 PSF
 MAXIMUM WIND SPEED = 80 MPH (3-SECOND GUST)
 - VERIFY SEISMIC REQUIREMENTS FOR YOUR AREA.
 - SOIL DESIGN BEARING PRESSURE IS ASSUMED 2000 PSF. LOCAL SOIL CONDITIONS AND/OR LOCAL PRACTICE MAY NECESSITATE A MORE STRINGENT FOOTING AND FOUNDATION WALL DESIGN. CONSULT WITH LOCAL CONTRACTOR OR BUILDING INSPECTOR.
 - INSULATION:
 CEILING --- R-30
 WALL --- R-13
 FLOOR --- R-13
 - GL. MATERIAL BEAMS LAMINATED: USES LUMBER GANG LAM LVL SHALL BE BY LOUISIANA PACIFIC OF WILKINSON, NC. RESIDES BEEN OR APPROVED EQUAL SUPPLIER. DIMENSIONS SHALL REST OR EXCEED:
 10' x 2800 PSI
 E = 2000000 PSI
 GANG LAM LVL'S ARE INDICATED. GANG LAM LVL'S CAN BE USED BUT VARY FROM 5'S IS INDICATED.

DO NOT SCALE DRAWINGS.
 COPYRIGHT © 11/17/03
 ALL RIGHTS RESERVED BY DONALD A. GARDNER, INC.
 NOT TO BE COPIED OR REPRODUCED WITHOUT WRITTEN PERMISSION

ALL FEDERAL, STATE, AND LOCAL CODES, ORDINANCES, REGULATIONS AND MANUFACTURER'S INSTRUCTIONS ETC. SHALL BE CONSIDERED AS PART OF THE REQUIREMENTS FOR THIS DRAWING AND SHALL BE THE RESPONSIBILITY OF THE CONTRACTOR TO VERIFY THESE. THE CONTRACTOR SHALL BE RESPONSIBLE FOR OBTAINING ALL NECESSARY PERMITS. THESE BEAMS ARE NOT DESIGNED FOR ANY PARTICULAR LOCAL LOADS. YOU ARE RESPONSIBLE FOR OBTAINING AND ENSURING COMPLIANCE WITH ALL APPLICABLE CODES AND MANUFACTURER'S REQUIREMENTS.

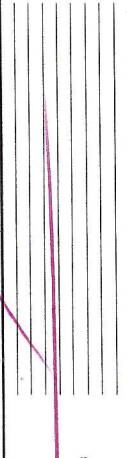

DONALD A. GARDNER, INC.
 P.O. BOX 26178 • GREENVILLE, S.C. • 29618
 864.928.7580
www.dongardner.com

DESIGN NO. 1024-B
 OF 10 BIDS
 SHEET 8 OF 10 BIDS
 SECOND FLOOR STRUCTURAL PLAN