

A1

RIM BOARD

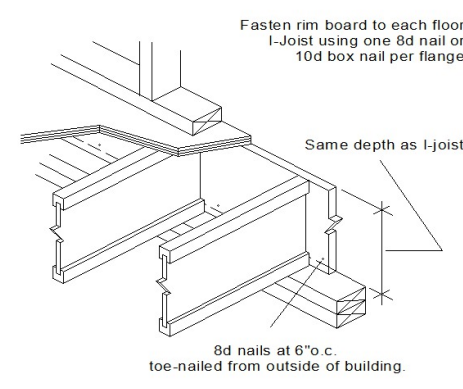

A5

JOIST SUPPORT NAILING

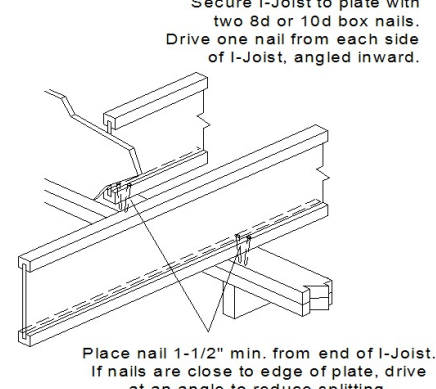

B3

BLOCKING AT INTERIOR SUPPORT

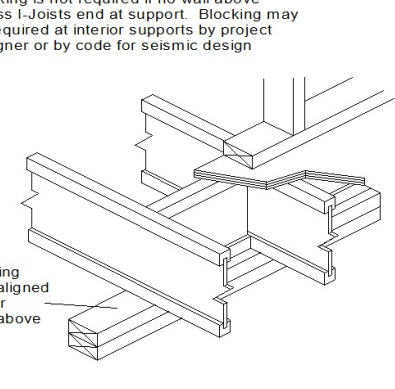

B2

SQUASH BLOCKS

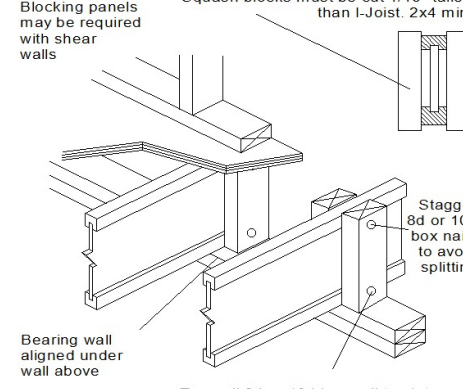

D2

POST LOADS

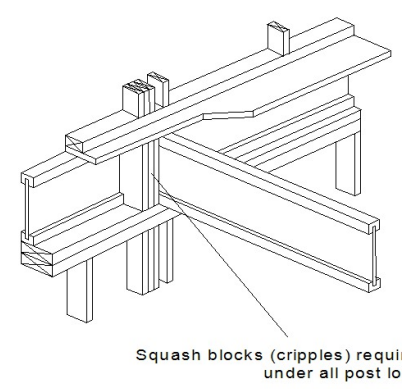

E2

Hanger Detail

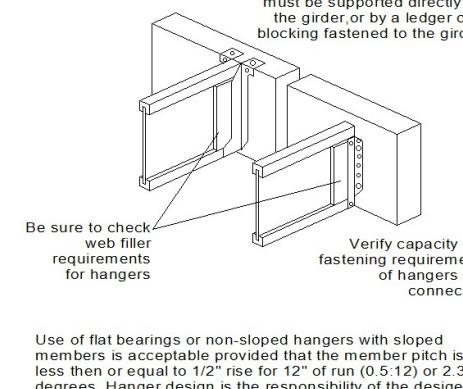

E3

I-JOIST HEADER

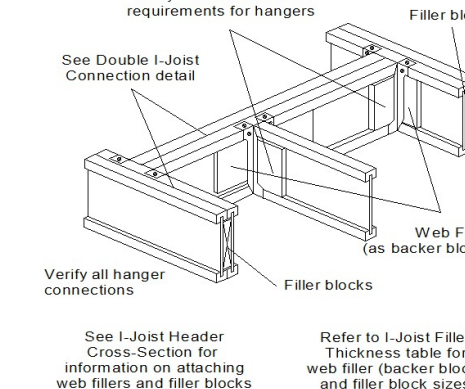

E5

DOUBLE I-JOIST CONNECTION

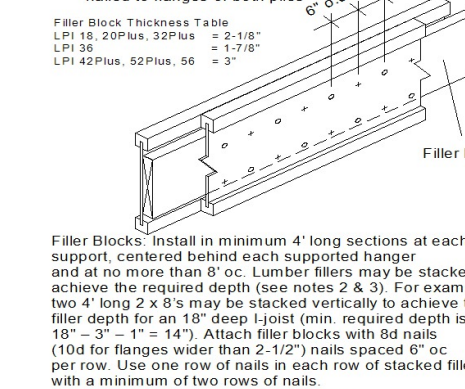

C1

CANTILEVER DETAIL

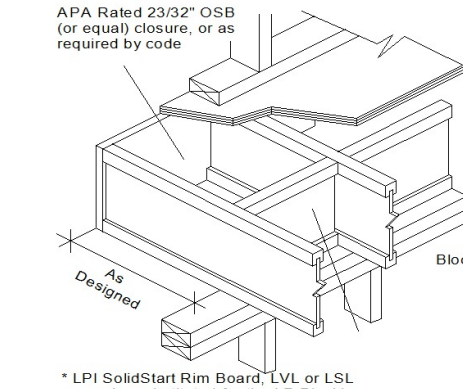
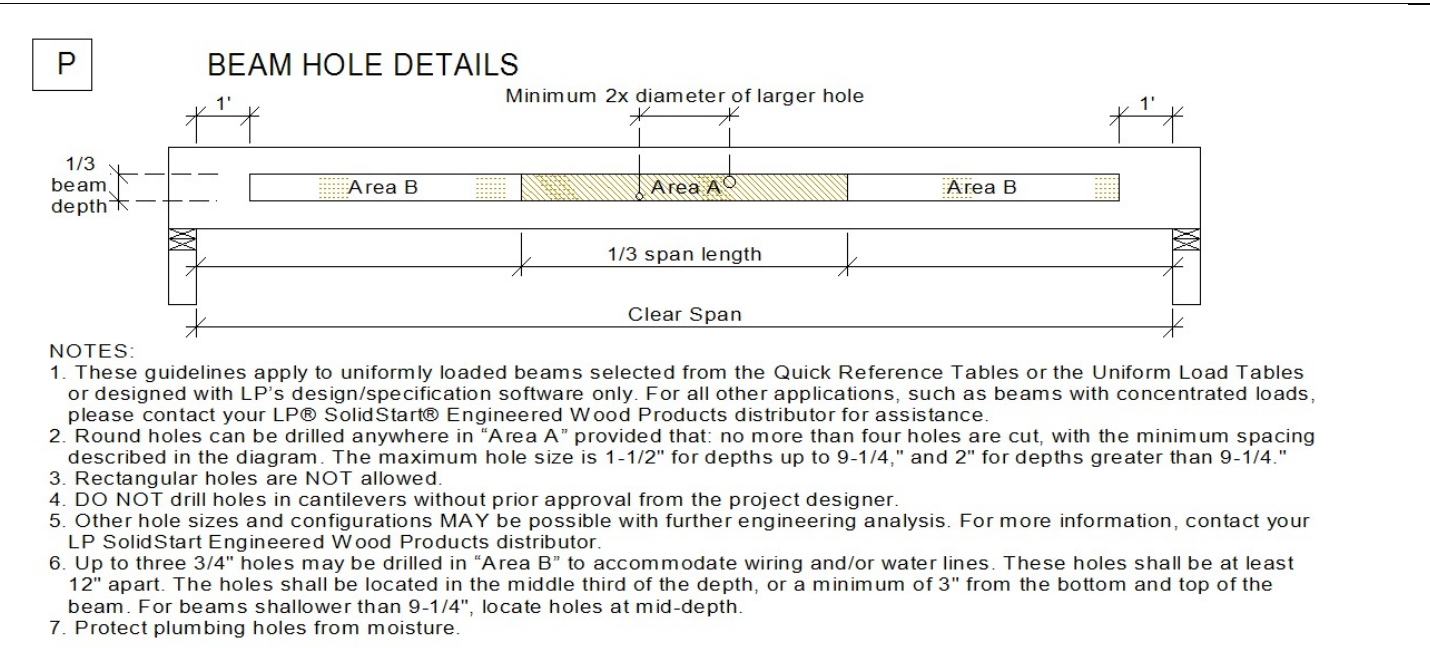
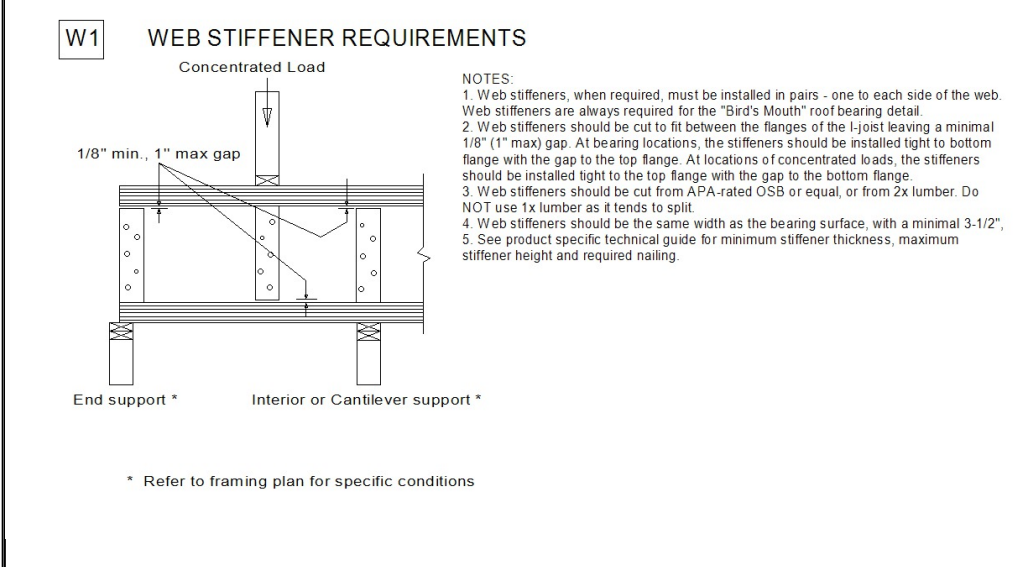
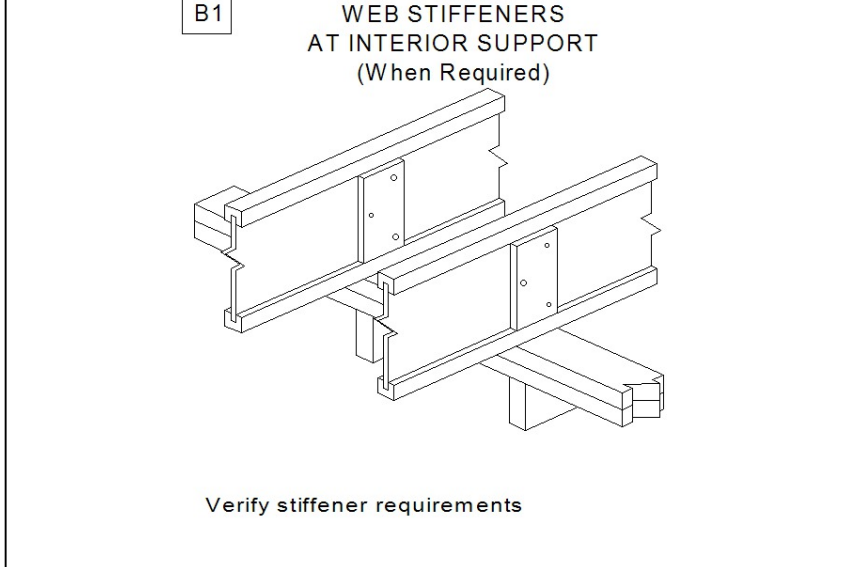
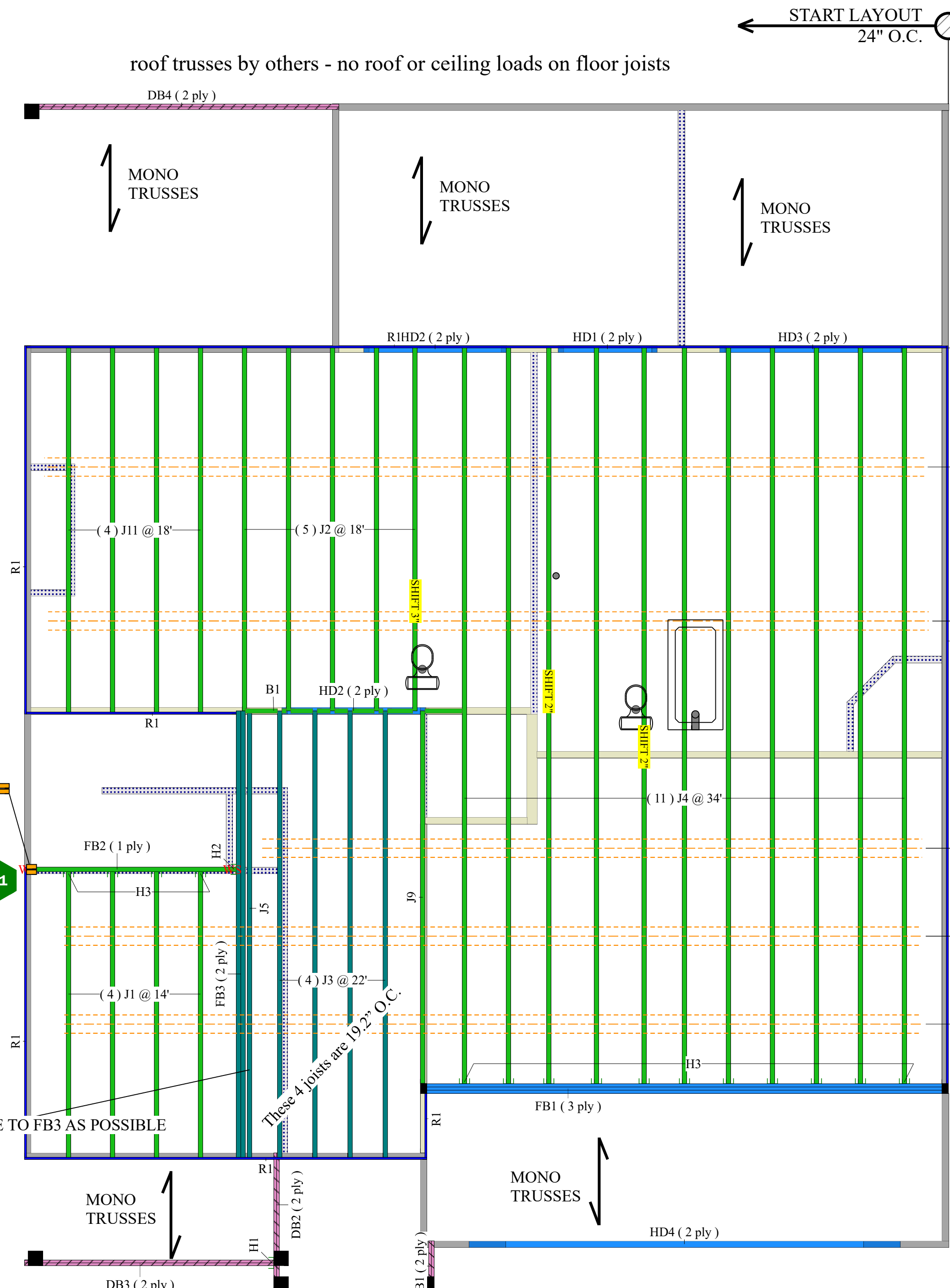

Table with columns for Series, Depth, Clear Span (ft), and Distance from End Support/Interior or Cantilever-End Support. It provides spacing requirements for various joist series and depths.

WEB STIFFENER REQUIREMENTS table with columns for Series, Depth, Minimum Thickness, Maximum Height, Nail Size, and Nail Qty.



Web stiffeners - detail B1



Material schedule tables for 2nd Flr Joist (Flush), 2nd Flr Joist (Dropped), Beam By Others (Dropped), Rim Board, Blocking, and Hanger, listing labels, descriptions, widths, depths, quantities, and lengths.

Important Notes, Handling & Storage, and a diagram showing how to handle joist bundles with fabric slings.

2ND FLOOR FRAMING

SCALE: 1/4" = 1'



2160 Satellite Blvd., Suite 450  
Duluth, GA 30097  
888-613-5078



Dealer  
84 Lumber-Fayetteville #2307  
Dealer Address  
620 Belt Road  
Fayetteville, NC 28301  
(910) 867-9185  
Project  
14511  
Created  
January 21, 2020  
Layout Name  
202001-14511  
Description  
Caviness Land  
CL2862 - Lot 38 Blackbridge Village  
Designer  
Kyle Miltzer

Table for 2nd Flr Design Method, ASD (USA) and IRC 2018, listing loads, deflection, and fastener details.

