

SOIL/SITE EVALUATION
 for ON-SITE WASTEWATER SYSTEM

Owner: *Lamco* Applicant:
 Address: *43 Rolling Pasture SFD* Date Evaluated: *5-24-22*
 Proposed Facility: Design Flow (.1949): *360 GPD* Property Size:
 Location of Site: Property Recorded:
 Water Supply: Public Individual Well Spring Other
 Evaluation Method: Auger Boring Pit Cut
 Type of Wastewater: Sewage Industrial Process Mixed

P R O F I L E #	.1940 Landscape Position/ Slope %	Horizon Depth (In.)	SOIL MORPHOLOGY		OTHER PROFILE FACTORS				Profile Class & LTAR	
			.1941		.1942 Soil Wetness/ Color	.1943 Soil Depth (IN.)	.1956 Sapro Class	.1944 Restr Horiz		
			.1941 Structure/ Texture	.1941 Consistence Mineralogy						
<i>PIT</i>										
<i>1,2</i>	<i>L</i>	<i>0-20</i>	<i>LS</i>	<i>Gv</i>	<i>Fr/W/np/ncp</i>	<i>10YR 7/1</i>	<i>> 48"</i>	<i>—</i>	<i>—</i>	<i>PS.4</i>
	<i>2-5%</i>	<i>20-48</i>	<i>sc</i>	<i>sbk</i>	<i>Fr/W/np/ncp</i>	<i>≥ 34"</i>				<i>Group III</i>

Description	Initial System	Repair System	Other Factors (.1946):
Available Space (.1945)	<i>✓</i>	<i>✓</i>	Site Classification (.1948): <i>PS</i>
System Type(s)	<i>25% red</i>	<i>25% red</i>	Evaluated By: <i>ML</i>
Site LTAR	<i>.4</i>	<i>.4</i>	Others Present: <i>REHS</i>

COMMENTS: _____

LANDSCAPE POSITIONS	GROUP	TEXTURES	.1955 LTAR	CONSISTENCE MOIST	WET
R-RIDGE	I	S-SAND	1.2 - 0.8	VFR-VERY FRIABLE	NS-NON-STICKY
S-SHOULDER SLOPE		LS-LOAMY SAND			
L-LINEAR SLOPE	II	SL-SANDY LOAM	0.8 - 0.6	FI-FIRM	SS-SLIGHTLY STICKY
FS-FOOT SLOPE		L-LOAM			
N-NOSE SLOPE	III	SI-SILT	0.6 - 0.3	VFI-VERY FIRM	S-STICKY
H-HEAD SLOPE		SIL-SILT LOAM			
CC-CONCLAVE SLOPE		CL-CLAY LOAM			
CV-CONVEX SLOPE		SCL-SANDY CLAY LOAM			
T-TERRACE	IV	SIC-SILTY CLAY	0.4 - 0.1	EFI-EXTREMELY FIRM	VS-VERY STICKY
FP-FLOOD PLAN		C-CLAY			
		SC-SANDY CLAY			NP-NON-PLASTIC
					SP-SLIGHTLY STICKY
					P-PLASTIC
					VP-VERY PLASTIC

STRUCTURE
 SG-SINGLE GRAIN
 M-MASSIVE
 CR-CRUMB
 GR-GRANULAR
 SBK-SUBANGULAR BLOCKY
 ABK-ANGULAR BLOCKY
 PL-PLATY
 PR-PRISMATIC

MINERALOGY
 SLIGHTLY EXPANSIVE
 EXPANSIVE

Show profile locations and other site features (dimensions, references or benchmark, and North)

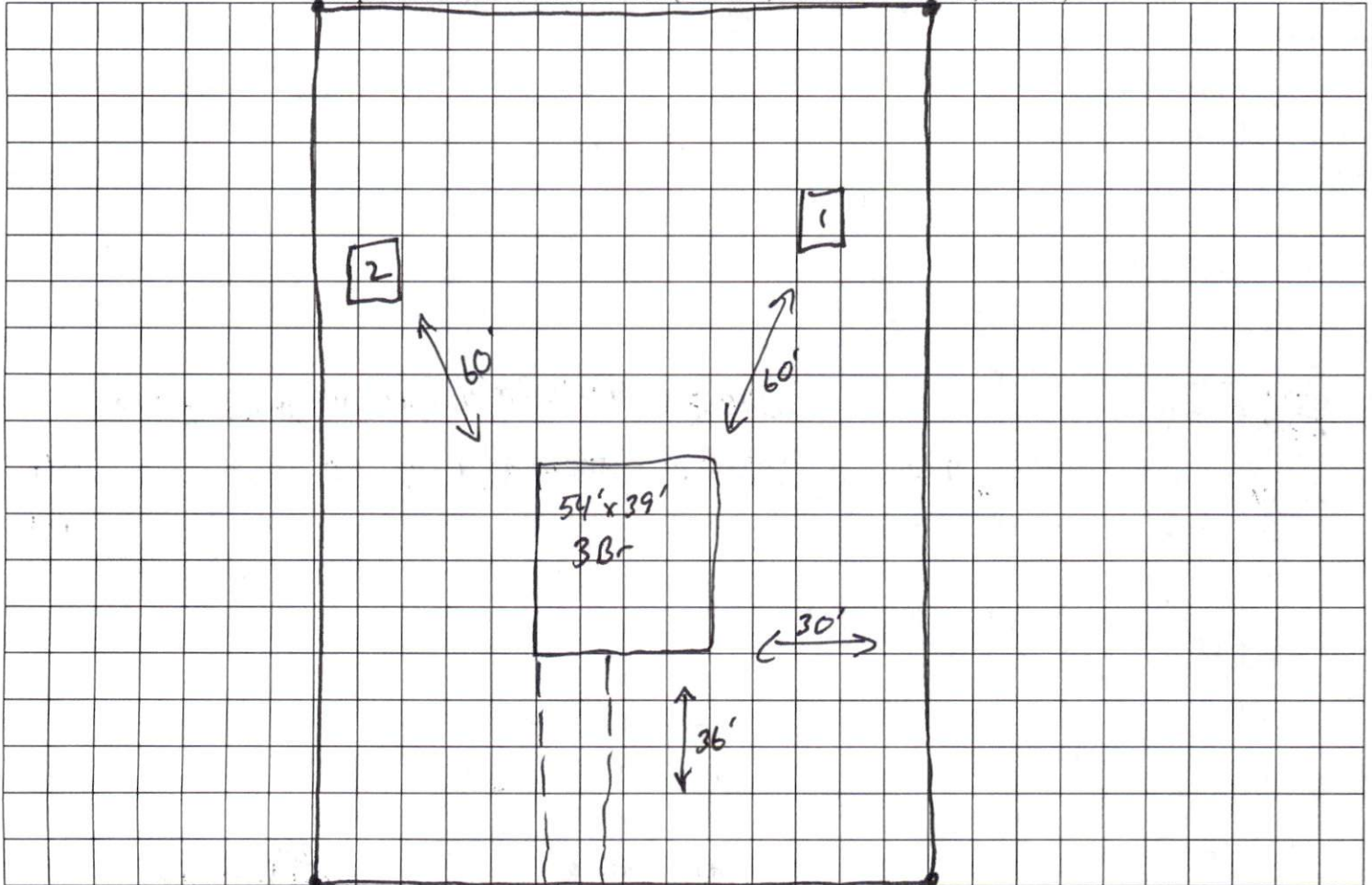

Rolling Pasture Way