







# Bateman Civil Survey Company

Engineers • Surveyors • Planners

2524 Reliance Avenue, Apex, NC 27539 Ph: 919.577.1080 Fax: 919.577.1081  
 www.batemancivilsurvey.com info@batemancivilsurvey.com  
 NCBELS Firm No. C-2378

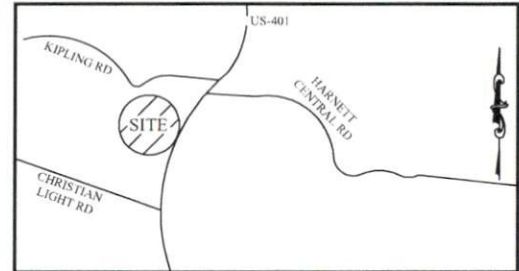

### VICINITY MAP

(Not to Scale)

#### LEGEND

- PO = PORCH
- P = PATIO
- SP = SCREENED PORCH OR PATIO
- CP = COVERED PORCH OR PATIO
- WD = WOOD DECK
- SW = SIDEWALK
- DW = CONC DRIVEWAY
- ⊙ = COMPUTED POINT
- ⊙ = IRON PIPE FOUND
- ⊙ = IRON PIPE SET (IPS)
- ⊙ = WATER METER
- CO = CLEANOUT
- AC = AIR CONDITIONER
- ⊙ = ELECTRIC BOX
- ⊙ = CABLE BOX
- ⊙ = TELEPHONE PEDESTAL
- ⊙ = LIGHT POLE
- CI = CURB INLET
- YI = YARD INLET
- FH = FIRE HYDRANT
- HP = HANDICAP PORTAJOHNS WITH SCREENING
- ⊙ = SEWER MANHOLE
- ⊙ = FIRE HYDRANT
- TR = TRASH RECEPTACLES

#### BUILDING SETBACKS:

- FRONT = 35 ft
- SIDE = 10 ft
- REAR = 25 ft
- CORNER SIDE = 20 ft

I, STEVEN P. CARSON, CERTIFY THAT THIS PLAT WAS DRAWN UNDER MY DIRECT SUPERVISION FROM A SURVEY MADE UNDER MY SUPERVISION (PLAT BOOK REFERENCED IN TITLE BLOCK); THAT THE BOUNDARIES NOT SURVEYED ARE CLEARLY INDICATED AS DRAWN FROM INFORMATION LISTED UNDER REFERENCES; THAT THE RATIO OF PRECISION AS CALCULATED IS 1:10,000+; AND THAT THIS MAP MEETS THE REQUIREMENTS OF THE STANDARD PRACTICE FOR LAND SURVEYING IN NORTH CAROLINA L-4752 DATED:

This map is of an existing parcel of land and is only intended for the parties and purposes shown. This map not for recordation. No title report provided.

BUILDER TO VERIFY HOUSE LOCATION, DIMENSIONS AND REVIEW TOTAL IMPERVIOUS NOTED ON THIS PLOT PLAN

## PRELIMINARY PLOT PLAN

FOR  
KB HOMES

**BIRCHWOOD GROVE - LOT 11**  
 JOHN STARK DRIVE, FUQUAY-VARINA, NC  
 HECTORS CREEK TOWNSHIP, HARNETT COUNTY

DATE: 2/18/22 DRAWN BY: BMM CHECKED BY: SPC

REFERENCE: BK2022, PGS. 69-72 PROJECT# 220207 SCALE: 1"=40'

#### LOT INFORMATION:

PIN : IN REVIEW  
 TOTAL LOT AREA = 0.484 AC = 21,092 SF  
 HOUSE = 2,197 SF  
 PORCH = 51 SF  
 SIDEWALK = 76 SF  
 DRIVEWAY = 646 SF  
 PATIO = 200 SF  
 AC PAD = 9 SF  
 PROPOSED IMPERVIOUS = 3,179 SF  
 PERCENT IMPERVIOUS = 15.1 %  
 MAXIMUM ALLOWED IMPERVIOUS = 4,000 SF

OPEN SPACE 7

100' PRIME VIEWS & VISTAS

BK2022, PGS. 69-72

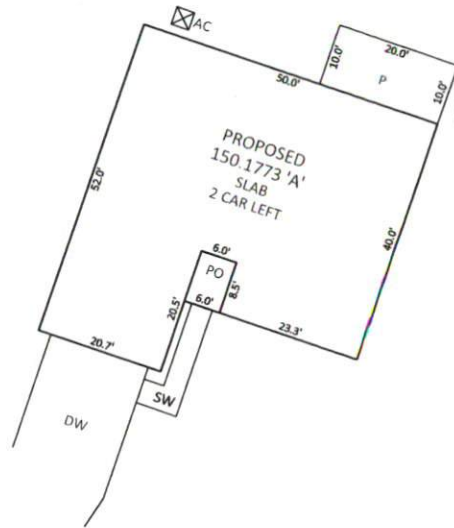

INSET SCALE: 1"=20'

#### NOTES:

1. THIS SURVEY WAS PREPARED BY BATEMAN CIVIL SURVEY CO., UNDER THE SUPERVISION OF STEVEN P. CARSON, PLS.
2. THIS PLAN HAS BEEN PREPARED FOR LAYOUT AND PERMITTING PURPOSES ONLY.
3. PROPERTY LINES SHOWN WERE TAKEN FROM EXISTING FIELD EVIDENCE, EXISTING DEEDS AND/OR PLATS OF PUBLIC RECORD, AND INFORMATION SUPPLIED TO THE SURVEYOR BY THE CLIENT.
4. ALL DISTANCES ARE HORIZONTAL GROUND DISTANCES AND ALL BEARINGS ARE NORTH CAROLINA STATE PLANE COORDINATE SYSTEM UNLESS OTHERWISE SHOWN.
5. THIS MAP IS NOT FOR RECORDATION AND SHOULD BE REVIEWED BY A LOCAL GOVERNMENT AGENCY FOR COMPLIANCE WITH ANY APPLICABLE LAND DEVELOPMENT REGULATIONS.
6. THE BASIS OF NORTH AND ALL EASEMENTS, RIGHTS-OF-WAYS, BUFFERS, SETBACKS AND ADJOINERS, ETC. REFERENCED IN TITLE BLOCK.
7. NO INVESTIGATION INTO THE EXISTENCE OF JURISDICTIONAL WETLANDS OR RIPARIAN BUFFERS PERFORMED BY THIS FIRM.
8. SURVEYOR HAS MADE NO INVESTIGATION OR INDEPENDENT SEARCH FOR EASEMENTS OF RECORD, ENCUMBRANCES, RESTRICTIVE COVENANTS, OWNERSHIP TITLE EVIDENCE OR ANY OTHER FACTS THAT AN ACCURATE AND CURRENT TITLE SEARCH MAY DISCLOSE.
9. THE PROPERTY LIES IN ZONE "X" PER NATIONAL FLOOD INSURANCE PROGRAM F.I.R.M. MAP #3720064200J, DATED OCTOBER 03 2006.
10. ZONING IS : RA-40
11. A 5' PUBLIC UTILITY EASEMENT LIES PARALLEL TO THE ROADWAY RIGHT OF WAY ALONG EACH SIDE, EXCEPT OPEN SPACE 4.
12. PROPERTY OWNER: KB HOME RALEIGH- DURHAM INC.  
 4506 S. MIAMI BLVD. #100  
 DURHAM, NC. 27703

CURVE TABLE				
CURVE	RADIUS	LENGTH	CHORD DIRECTION	CHORD
C12	50.00'	54.95'	S69°59'15"W	52.22'
C13	25.00'	21.03'	S77°22'32"W	20.41'
C14	25.00'	35.79'	S12°16'21"W	32.81'
C15	335.00'	22.11'	S26°50'42"W	22.11'



PRELIMINARY

P:\2022\Projects\220207\_Birchwood\Survey\DWG - Birchwood\Survey.dwg, 2/22/22 9:42 AM, User: swarder PLS, Printer: