

ELECTRICAL LEGEND		
PROVIDE BURGLAR/SMOKE AND FIRE DETECTORS AS PER MANUFACTURER'S SPECIFICATIONS. PROVIDE CENTRAL VACUUM SYSTEM AS PER MANUFACTURER'S SPECIFICATIONS. ALL FANS ARE TO BE CONTROLLED BY VAR/SPEED AND DIRECTIONAL SWITCHES		
⊕ SURF. MOUNTED LIGHT	⊖ TYPICAL WALL RECEPT.	⊖ TYPICAL SWITCH
○ RECESSED LIGHT	⊖ TOP 1/2 HOT W/SWITCH	⊖ 3-WAY SWITCH
⊖ EYEBALL LIGHT	⊖ CEILING RECEPTACLE	⊖ 4-WAY SWITCH
⊖ FAN/LIGHT COMB.	⊖ FLOOR RECEPTACLE	⊖ DIMMER SWITCH
— FLUORESCENT TUBE	⊖ WATERPROOF RECEPT.	⊖ ELEC. PANEL BOX
⊖ FLUOR. LIGHT FIXTURE	⊖ GROUND FAULT	⊖ T.V. CABLE RECEPT.
⊖ EXHAUST FAN	⊖ DISPOSAL UNIT	⊖ TELEPHONE JACK
⊖ CL'G. FAN	⊖ 220VOLT RECEPTACLE	⊖ COMPUTER JACK
⊖ FLOOD LIGHT		

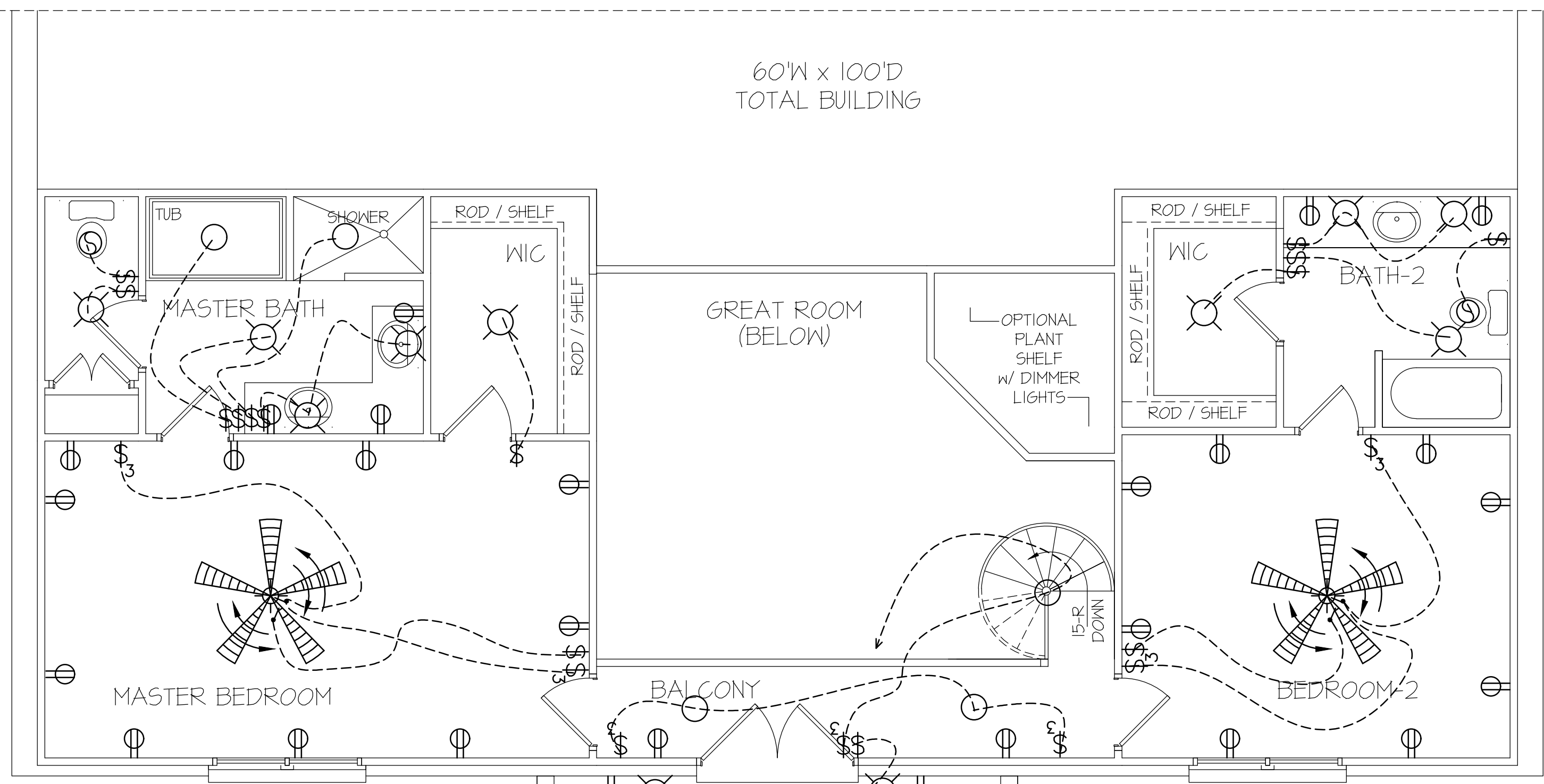

SQUARE FOOTAGE CALCULATIONS
MAIN LEVEL - FRAME-HEATED AREA = 1136 S.F.
UPPER LEVEL - FRAME-HEATED AREA = 943 S.F.
TOTAL - FRAME-HEATED AREA = 2079 S.F.
COVERED WOOD DECK AREA = 151 S.F.
UPPER WOOD DECK AREA = 151 S.F.

8' CEILINGS UNLESS OTHERWISE NOTED  
**UPPER FLOOR PLAN**  
SCALE: 1/4" = 1'-0"

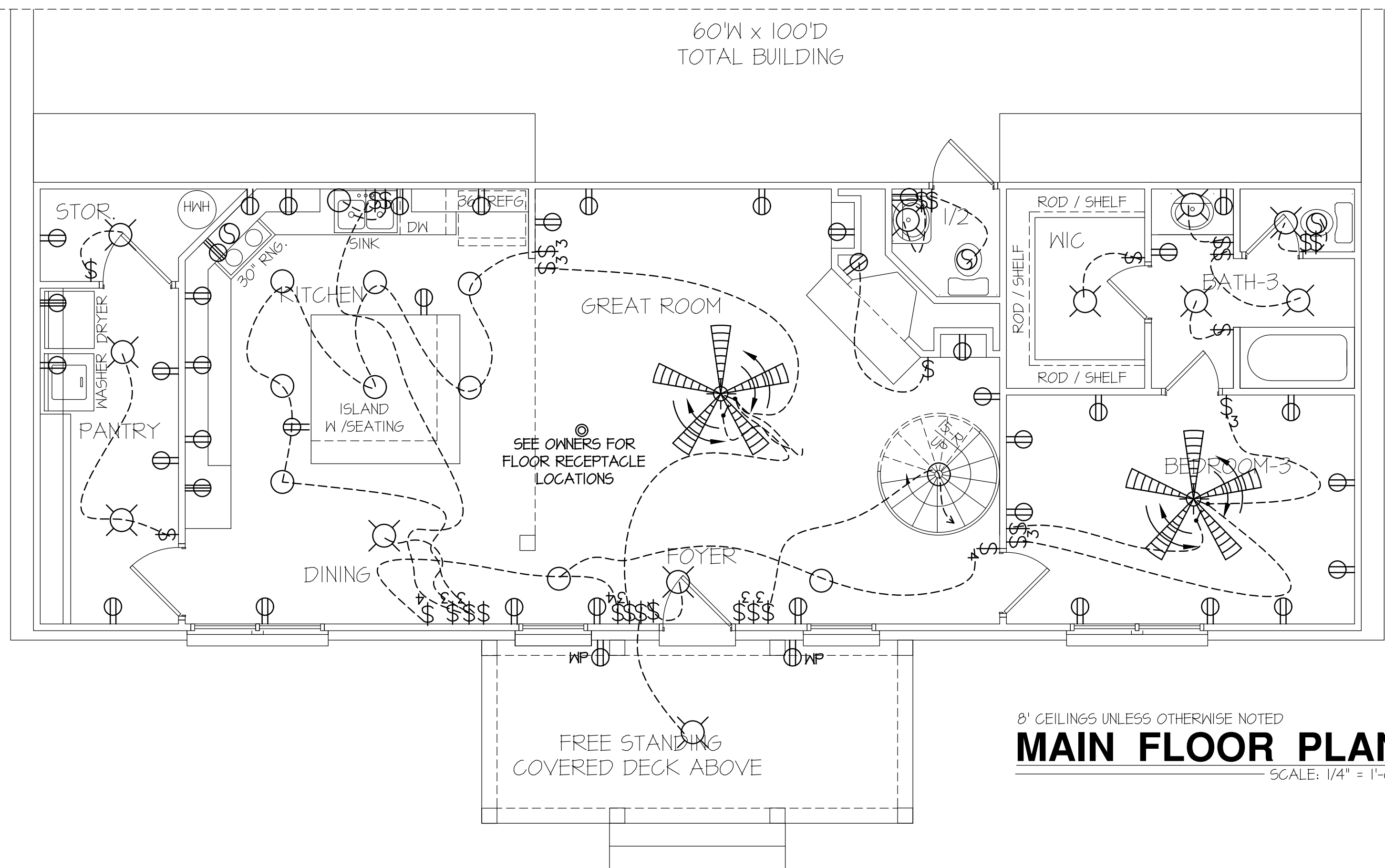

8' CEILINGS UNLESS OTHERWISE NOTED  
**MAIN FLOOR PLAN**  
SCALE: 1/4" = 1'-0"