

Harnett County Department of Public Health

PERMIT # SFD2204-0068

Operation Permit

New Installation Septic Tank Nitrification Line Repair Expansion

PROPERTY LOCATION: 203 MITCHELL MANOR DR

Name: (owner) WEAVER HOMES INC SUBDIVISION MITCHELL MANOR LOT # 6

System Installer: YELLOW DOC

Basement with plumbing: Garage Number of Bedrooms 3

Type of Water Supply: Community Public Well Distance from well _____ feet

System Type: IID Types V and VI Systems expire in 5 years.

(In accordance with Table V a)

Owner must contact Health Department 6 months prior to expiration for permit renewal.

This system has been installed in compliance with applicable North Carolina General Statutes, Rules for Sewage Treatment and Disposal, and all conditions of the Improvement Permit and Construction Authorization.

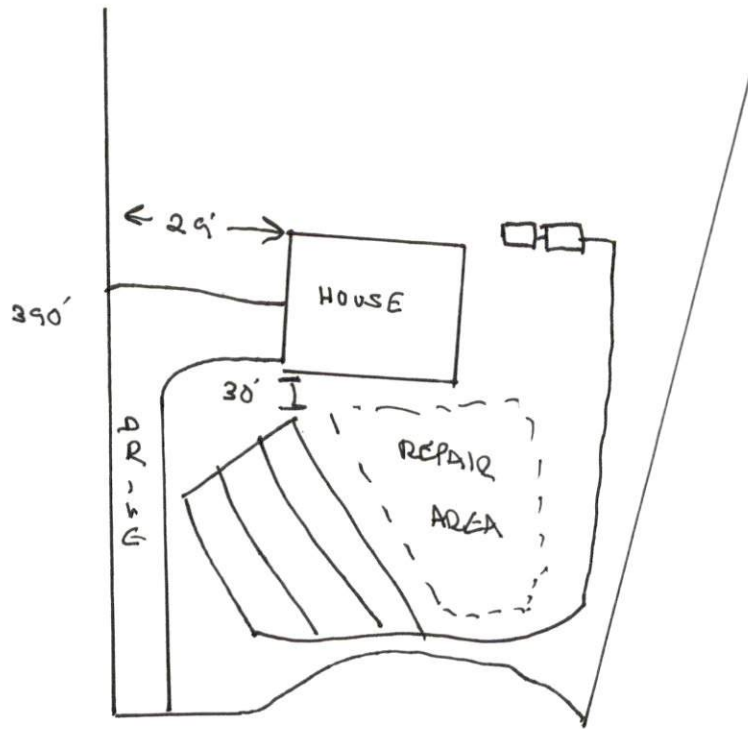

PERMIT CONDITIONS:

I. Performance: System shall perform in accordance with Rule .1961.

II. Monitoring: As required by Rule .1961.

III. Maintenance: As required by Rule .1961. Other: _____

Subsurface system operator required? Yes No

If yes, see attached sheet for additional operation conditions, maintenance and reporting.

IV. Operation: _____

V. Other: _____

D-Box Pump Alarm H2O Line PWR Line

Following are the specifications for the sewage disposal system on the above captioned property.

Type of system: Conventional Other PUMP TO CHAMBER (P4) Septic Tank: 1000 gallons Pump Tank: 1600 gallons

Subsurface Drainage Field: No. of ditches 1 exact length of each ditch 240 feet width of ditches 3 feet depth of ditches 12-14 inches

French Drain Required: _____ Linear feet

Authorized State Agent James C. Mandel PE P23045 Date 4-13-23