

VICINITY MAP
Not To Scale

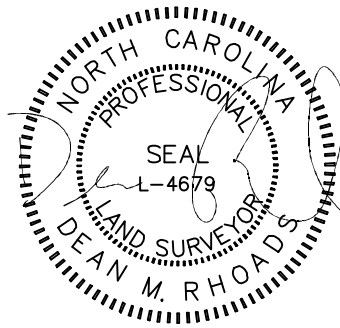

IMPERVIOUS SURFACE AREA	
DESCRIPTION	AREA
HOUSE w/ PORCH	2,432 S.F.
COV PORCH/HVAC	275 S.F.
DRIVEWAY & WALKS	978 S.F.
TOTAL (PROPOSED)=	3,685 S.F.
*TOTAL (ALLOWED)=	5,300 S.F.

*PB 2021, PG 567

SETBACKS; (PB 2021, 567)

FRONT-35'
REAR -20'
SIDE-10'
CORNER LOT SIDE - 10'

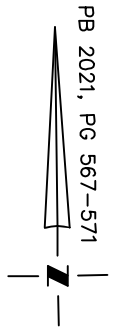
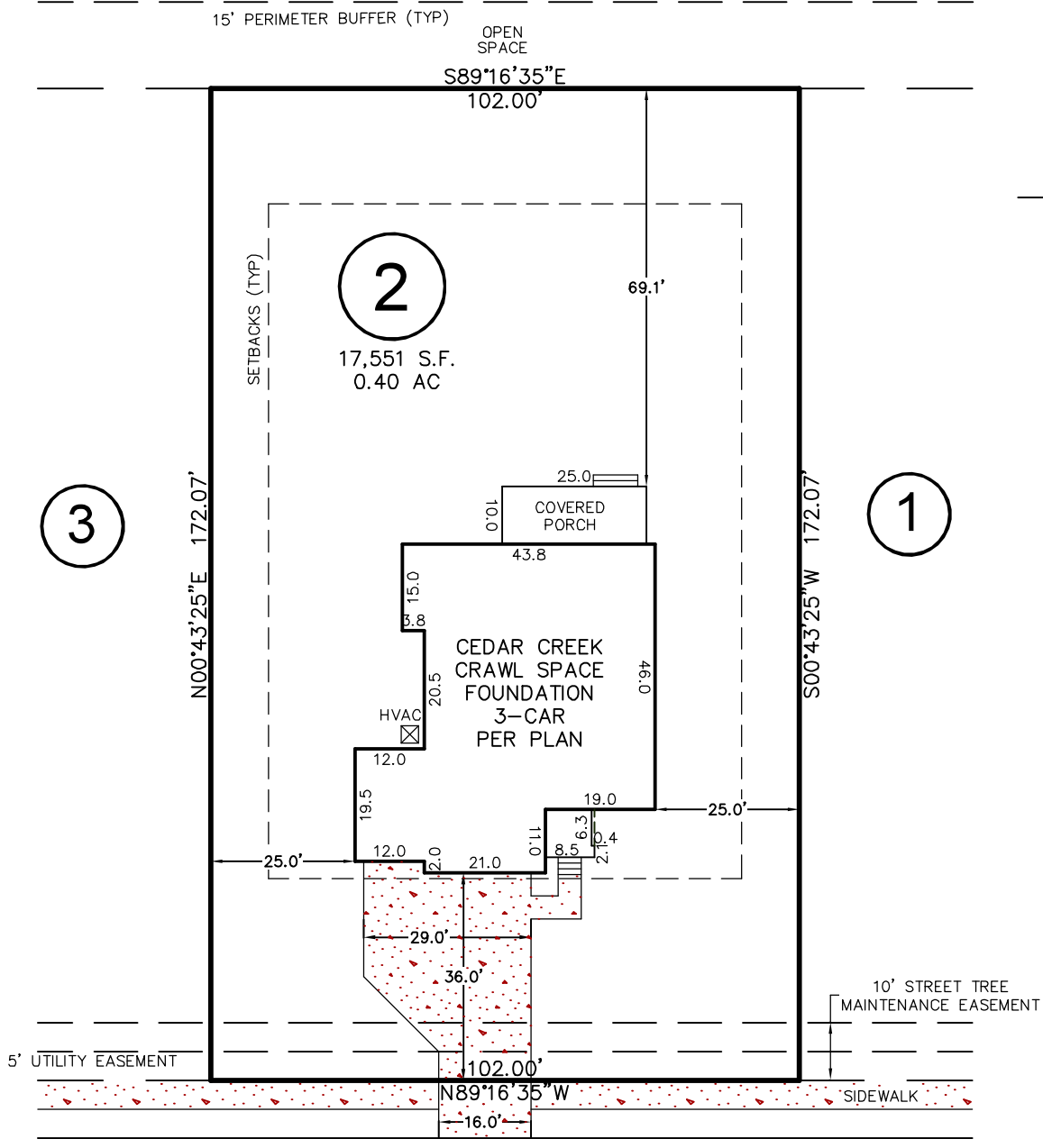

LAMBERT LANE

50' PUBLIC R/W EASEMENT

THIS DRAWING DOES NOT REFLECT AS-BUILT INFORMATION

PRELIMINARY PLAT
NOT FOR RECORDATION, CONVEYANCES, OR SALES.

THIS PROPERTY MAY BE SUBJECT TO ANY AND ALL APPLICABLE DEED RESTRICTIONS, EASEMENTS, RIGHT-OF-WAY, UTILITIES AND RESTRICTIVE COVENANTS WHICH MAY BE OF RECORD OR IMPLIED

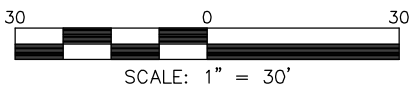

HOUSE LOCATION PLOT PLAN

FOR
50 LAMBERT LANE
LOT 2, PURFOY PLACE SUBDIVISION

Hector's Creek Township, Harnett County, North Carolina

PROPERTY OF: TRIANGLE BUILDING & PROPERTIES

MAP BOOK 2021 PAGE 567-571 DEED REFERENCE _____ PAGE _____

RESIDENTIAL LAND SERVICES, PLLC.

1917 Evans Road
Cary, North Carolina 27513
Phone (919) 378-9316
Firm License # P-0873

DRAWN BY: JLS

DATE: FEBRUARY 22, 2022