

GDH Kerto-S LVL 1.750" X 14.000" 2-Ply - PASSED

Level: Level

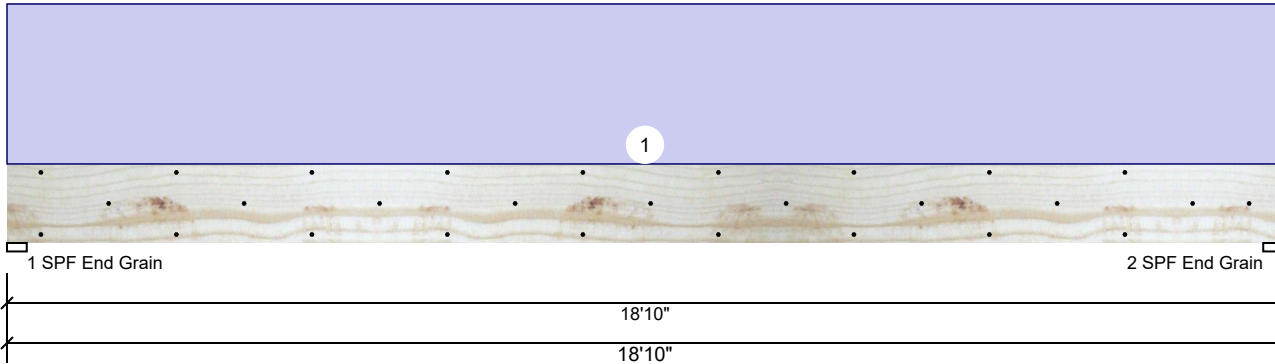

Member Information

Type:	Girder	Application:	Floor
Plies:	2	Design Method:	ASD
Moisture Condition:	Dry	Building Code:	IBC 2012
Deflection LL:	360	Load Sharing:	No
Deflection TL:	240	Deck:	Not Checked
Importance:	Normal		
Temperature:	Temp <= 100°F		

Reactions UNPATTERNED lb (Uplift)

Brg	Live	Dead	Snow	Wind	Const
1	0	2457	0	0	0
2	0	2457	0	0	0

Bearings

Bearing	Length	Cap. React	D/L lb	Total	Ld. Case	Ld. Comb.
1 - SPF End Grain	3.500"	23%	2457 / 0	2457	Uniform	D
2 - SPF End Grain	3.500"	23%	2457 / 0	2457	Uniform	D

Analysis Results

Analysis	Actual	Location	Allowed	Capacity	Comb.	Case
Moment	11011 ft-lb	9'5"	24299 ft-lb	0.453 (45%)	D	Uniform
Unbraced	11011 ft-lb	9'5"	11013 ft-lb	1.000 (100%)	D	Uniform
Shear	2093 lb	1'4 3/4"	9408 lb	0.222 (22%)	D	Uniform
LL Defl inch	0.000 (L/999)	0	999.000 (L/0)	0.000 (0%)		
TL Defl inch	0.444 (L/497)	9'5 1/16"	0.919 (L/240)	0.480 (48%)	D	Uniform

Design Notes

- 1 Fasten all plies using 3 rows of SDW22338 at 24" o.c. Maximum end distance not to exceed 12".
- 2 Refer to last page of calculations for fasteners required for specified loads.
- 3 Simpson fasteners applied from a single side of the member use tip values where published.
- 4 Girders are designed to be supported on the bottom edge only.
- 5 Top loads must be supported equally by all plies.
- 6 Top must be laterally braced at a maximum of 9'7 1/2" o.c.
- 7 Bottom braced at bearings.
- 8 Lateral slenderness ratio based on single ply width.

ID	Load Type	Location	Trib Width	Side	Dead 0.9	Live 1	Snow 1.15	Wind 1.6	Const. 1.25	Comments
1	Uniform			Top	250 PLF	0 PLF	0 PLF	0 PLF	0 PLF	
	Self Weight				11 PLF					

Notes

Calculated Structured Designs is responsible only of the structural adequacy of this component based on the design criteria and loadings shown. It is the responsibility of the customer and/or the contractor to ensure the component suitability of the intended application, and to verify the dimensions and loads.

Lumber

1. Dry service conditions, unless noted otherwise
2. LVL not to be treated with fire retardant or corrosive chemicals

chemicals

Handling & Installation

1. LVL beams must not be cut or drilled
2. Refer to manufacturer's product information regarding installation requirements, multi-ply fastening details, beam strength values, and code approvals
3. Damaged Beams must not be used
4. Design assumes top edge is laterally restrained
5. Provide lateral support at bearing points to avoid lateral displacement and rotation

6. For flat roofs provide proper drainage to prevent ponding

This design is valid until 2/26/2023

Manufacturer Info

Metsä Wood
 301 Merritt 7 Building, 2nd Floor
 Norwalk, CT 06851
 (800) 622-5850
 www.metsawood.com/us
 ICC-ES: ESR-3633

Comtech, Inc.
 1001 S. Reilly Road, Suite #639
 Fayetteville, NC
 USA
 28314
 910-864-TRUS



GDH Kerto-S LVL 1.750" X 14.000" 2-Ply - PASSED

Level: Level

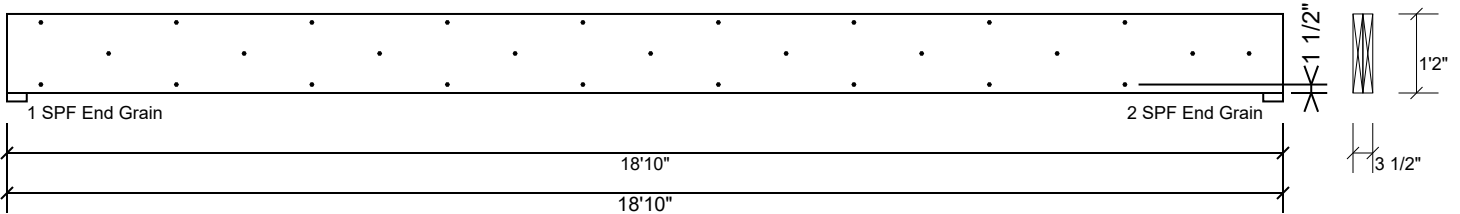

Multi-Ply Analysis

Fasten all plies using 3 rows of SDW22338 at 24" o.c.. Maximum end distance not to exceed 12"

Capacity	0.0 %
Load	0.0 PLF
Yield Limit per Foot	382.5 PLF
Yield Limit per Fastener	255.0 lb.
Yield Mode	Lookup
Edge Distance	1 1/2"
Min. End Distance	6"
Load Combination	
Duration Factor	1.00

Notes

Calculated Structured Designs is responsible only of the structural adequacy of this component based on the design criteria and loadings shown. It is the responsibility of the customer and/or the contractor to ensure the component suitability of the intended application, and to verify the dimensions and loads.

Lumber

1. Dry service conditions, unless noted otherwise
2. LVL not to be treated with fire retardant or corrosive

chemicals

Handling & Installation

1. LVL beams must not be cut or drilled
2. Refer to manufacturer's product information regarding installation requirements, multi-ply fastening details, beam strength values, and code approvals
3. Damaged Beams must not be used
4. Design assumes top edge is laterally restrained
5. Provide lateral support at bearing points to avoid lateral displacement and rotation

6. For flat roofs provide proper drainage to prevent ponding

This design is valid until 2/26/2023

Manufacturer Info

Metsä Wood
 301 Merritt 7 Building, 2nd Floor
 Norwalk, CT 06851
 (800) 622-5850
www.metsawood.com/us
 ICC-ES: ESR-3633

Comtech, Inc.
 1001 S. Reilly Road, Suite #639
 Fayetteville, NC
 USA
 28314
 910-864-TRUS



GDH (Side Load) Kerto-S LVL 1.750" X 18.000" 3-Ply - PASSED

Level: Level

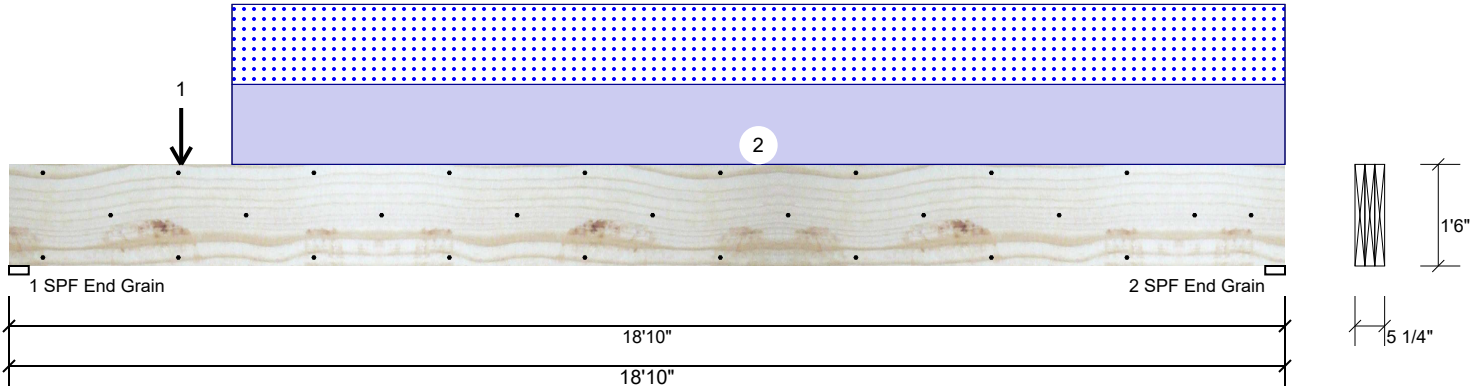

Member Information

Type:	Girder	Application:	Floor
Plies:	3	Design Method:	ASD
Moisture Condition:	Dry	Building Code:	IBC 2012
Deflection LL:	360	Load Sharing:	Yes
Deflection TL:	240	Deck:	Not Checked
Importance:	Normal		
Temperature:	Temp <= 100°F		

Reactions UNPATTERNED lb (Uplift)

Brg	Live	Dead	Snow	Wind	Const
1	0	3889	3691	0	0
2	0	3812	3614	0	0

Bearings

Bearing	Length	Cap. React	D/L lb	Total	Ld. Case	Ld. Comb.
1 - SPF End Grain	3.500"	47%	3889 / 3691	7580	L	D+S
2 - SPF End Grain	3.500"	46%	3812 / 3614	7426	L	D+S

Analysis Results

Analysis	Actual	Location	Allowed	Capacity	Comb.	Case
Moment	34254 ft-lb	9'2 1/8"	77108 ft-lb	0.444 (44%)	D+S	L
Unbraced	34254 ft-lb	9'2 1/8"	34270 ft-lb	1.000 (100%)	D+S	L
Shear	7544 lb	1'8 5/8"	23184 lb	0.325 (33%)	D+S	L
LL Defl inch	0.221 (L/998)	9'4"	0.613 (L/360)	0.360 (36%)	S	L
TL Defl inch	0.454 (L/486)	9'4"	0.920 (L/240)	0.490 (49%)	D+S	L

Design Notes

- 1 Fasten all plies using 3 rows of SDW22500 at 24" o.c. Maximum end distance not to exceed 12".
- 2 Refer to last page of calculations for fasteners required for specified loads.
- 3 Simpson fasteners applied from a single side of the member use tip values where published.
- 4 Girders are designed to be supported on the bottom edge only.
- 5 Top loads must be supported equally by all plies.
- 6 Top must be laterally braced at a maximum of 5'9 3/8" o.c.
- 7 Bottom braced at bearings.
- 8 Lateral slenderness ratio based on single ply width.

ID	Load Type	Location	Trib Width	Side	Dead 0.9	Live 1	Snow 1.15	Wind 1.6	Const. 1.25	Comments
1	Point	2-6-8		Top	1493 lb	0 lb	1493 lb	0 lb	0 lb	B3
2	Part. Uniform	3-3-8 to 18-10-0		Top	374 PLF	0 PLF	374 PLF	0 PLF	0 PLF	B2
	Self Weight				21 PLF					

Notes

Calculated Structured Designs is responsible only of the structural adequacy of this component based on the design criteria and loadings shown. It is the responsibility of the customer and/or the contractor to ensure the component suitability of the intended application, and to verify the dimensions and loads.

Lumber

1. Dry service conditions, unless noted otherwise
2. LVL not to be treated with fire retardant or corrosive chemicals

Handling & Installation

1. LVL beams must not be cut or drilled
2. Refer to manufacturer's product information regarding installation requirements, multi-ply fastening details, beam strength values, and code approvals
3. Damaged Beams must not be used
4. Design assumes top edge is laterally restrained
5. Provide lateral support at bearing points to avoid lateral displacement and rotation

6. For flat roofs provide proper drainage to prevent ponding

This design is valid until 2/26/2023

Manufacturer Info

Metsä Wood
 301 Merritt 7 Building, 2nd Floor
 Norwalk, CT 06851
 (800) 622-5850
 www.metsawood.com/us
 ICC-ES: ESR-3633

Comtech, Inc.
 1001 S. Reilly Road, Suite #639
 Fayetteville, NC
 USA
 28314
 910-864-TRUS



GDH (Side Load) Kerto-S LVL 1.750" X 18.000" 3-Ply - PASSED

Level: Level

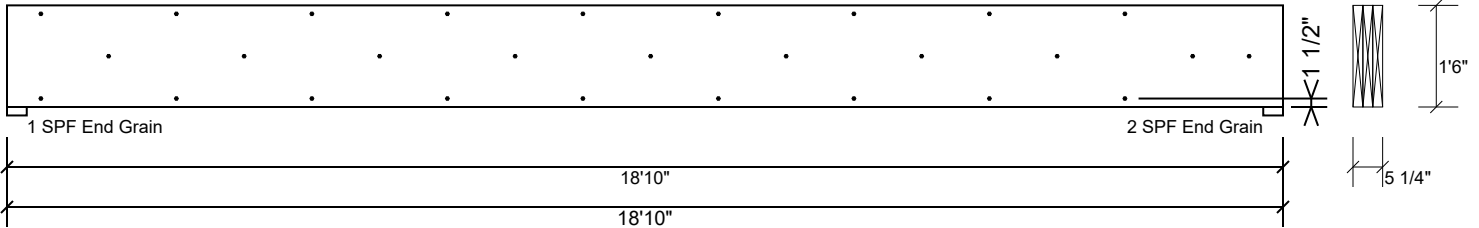

Multi-Ply Analysis

Fasten all plies using 3 rows of SDW22500 at 24" o.c.. Maximum end distance not to exceed 12"

Capacity	0.0 %
Load	0.0 PLF
Yield Limit per Foot	382.5 PLF
Yield Limit per Fastener	255.0 lb.
Yield Mode	Lookup
Edge Distance	1 1/2"
Min. End Distance	6"
Load Combination	
Duration Factor	1.00

Notes

Calculated Structured Designs is responsible only of the structural adequacy of this component based on the design criteria and loadings shown. It is the responsibility of the customer and/or the contractor to ensure the component suitability of the intended application, and to verify the dimensions and loads.

Lumber

1. Dry service conditions, unless noted otherwise
2. LVL not to be treated with fire retardant or corrosive

chemicals

Handling & Installation

1. LVL beams must not be cut or drilled
2. Refer to manufacturer's product information regarding installation requirements, multi-ply fastening details, beam strength values, and code approvals
3. Damaged Beams must not be used
4. Design assumes top edge is laterally restrained
5. Provide lateral support at bearing points to avoid lateral displacement and rotation

6. For flat roofs provide proper drainage to prevent ponding

This design is valid until 2/26/2023

Manufacturer Info

Metsä Wood
 301 Merritt 7 Building, 2nd Floor
 Norwalk, CT 06851
 (800) 622-5850
 www.metsawood.com/us
 ICC-ES: ESR-3633

Comtech, Inc.
 1001 S. Reilly Road, Suite #639
 Fayetteville, NC
 USA
 28314
 910-864-TRUS



GDH-1 Kerto-S LVL 1.750" X 11.875" 2-Ply - PASSED

Level: Level

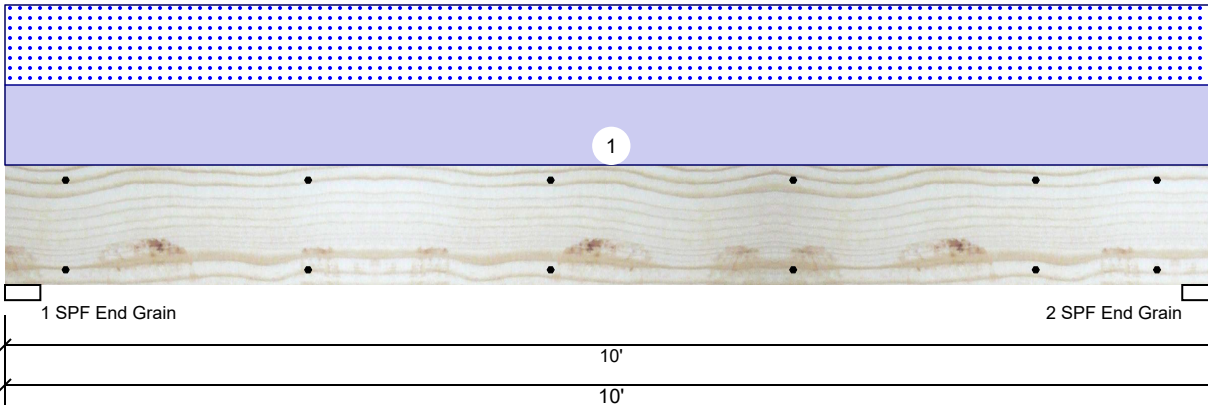

Member Information

Type:	Girder	Application:	Floor
Plies:	2	Design Method:	ASD
Moisture Condition:	Dry	Building Code:	IBC 2012
Deflection LL:	360	Load Sharing:	No
Deflection TL:	240	Deck:	Not Checked
Importance:	Normal		
Temperature:	Temp <= 100°F		

Reactions UNPATTERNED lb (Uplift)

Brg	Live	Dead	Snow	Wind	Const
1	0	1196	1150	0	0
2	0	1196	1150	0	0

Bearings

Bearing	Length	Cap. React	D/L lb	Total	Ld. Case	Ld. Comb.
1 - SPF End Grain	3.500"	22%	1196 / 1150	2346	L	D+S
2 - SPF End Grain	3.500"	22%	1196 / 1150	2346	L	D+S

Analysis Results

Analysis	Actual	Location	Allowed	Capacity	Comb.	Case
Moment	5340 ft-lb	5'	22897 ft-lb	0.233 (23%)	D+S	L
Unbraced	5340 ft-lb	5'	9721 ft-lb	0.549 (55%)	D+S	L
Shear	1774 lb	8'9 3/8"	10197 lb	0.174 (17%)	D+S	L
LL Defl inch	0.051 (L/2238)	5'	0.318 (L/360)	0.160 (16%)	S	L
TL Defl inch	0.104 (L/1097)	5'	0.477 (L/240)	0.220 (22%)	D+S	L

Design Notes

- 1 Fasten all plies using 2 rows of SDW22338 at 24" o.c. Maximum end distance not to exceed 12".
- 2 Refer to last page of calculations for fasteners required for specified loads.
- 3 Simpson fasteners applied from a single side of the member use tip values where published.
- 4 Girders are designed to be supported on the bottom edge only.
- 5 Top loads must be supported equally by all plies.
- 6 Top braced at bearings.
- 7 Bottom braced at bearings.
- 8 Lateral slenderness ratio based on single ply width.

ID	Load Type	Location	Trib Width	Side	Dead 0.9	Live 1	Snow 1.15	Wind 1.6	Const. 1.25	Comments
1	Uniform			Top	230 PLF	0 PLF	230 PLF	0 PLF	0 PLF	G1
	Self Weight				9 PLF					

Notes

Calculated Structured Designs is responsible only of the structural adequacy of this component based on the design criteria and loadings shown. It is the responsibility of the customer and/or the contractor to ensure the component suitability of the intended application, and to verify the dimensions and loads.

Lumber

1. Dry service conditions, unless noted otherwise
2. LVL not to be treated with fire retardant or corrosive

chemicals

Handling & Installation

1. LVL beams must not be cut or drilled
2. Refer to manufacturer's product information regarding installation requirements, multi-ply fastening details, beam strength values, and code approvals
3. Damaged Beams must not be used
4. Design assumes top edge is laterally restrained
5. Provide lateral support at bearing points to avoid lateral displacement and rotation

6. For flat roofs provide proper drainage to prevent ponding

This design is valid until 2/26/2023

Manufacturer Info

Metsä Wood
 301 Merritt 7 Building, 2nd Floor
 Norwalk, CT 06851
 (800) 622-5850
www.metsawood.com/us
 ICC-ES: ESR-3633

Comtech, Inc.
 1001 S. Reilly Road, Suite #639
 Fayetteville, NC
 USA
 28314
 910-864-TRUS



GDH-1 Kerto-S LVL 1.750" X 11.875" 2-Ply - PASSED

Level: Level

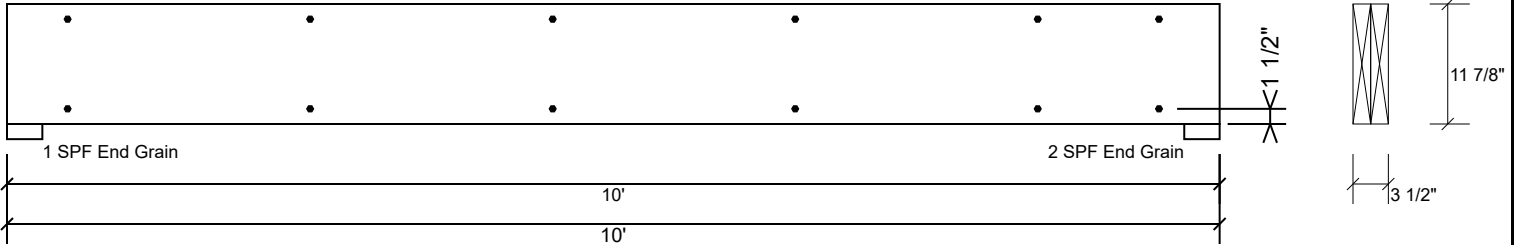

Multi-Ply Analysis

Fasten all plies using 2 rows of SDW22338 at 24" o.c.. Maximum end distance not to exceed 12"

Capacity	0.0 %
Load	0.0 PLF
Yield Limit per Foot	255.0 PLF
Yield Limit per Fastener	255.0 lb.
Yield Mode	Lookup
Edge Distance	1 1/2"
Min. End Distance	6"
Load Combination	
Duration Factor	1.00

Notes

Calculated Structured Designs is responsible only of the structural adequacy of this component based on the design criteria and loadings shown. It is the responsibility of the customer and/or the contractor to ensure the component suitability of the intended application, and to verify the dimensions and loads.

Lumber

1. Dry service conditions, unless noted otherwise
2. LVL not to be treated with fire retardant or corrosive

chemicals

Handling & Installation

1. LVL beams must not be cut or drilled
2. Refer to manufacturer's product information regarding installation requirements, multi-ply fastening details, beam strength values, and code approvals
3. Damaged Beams must not be used
4. Design assumes top edge is laterally restrained
5. Provide lateral support at bearing points to avoid lateral displacement and rotation

6. For flat roofs provide proper drainage to prevent ponding

This design is valid until 2/26/2023

Manufacturer Info

Metsä Wood
 301 Merritt 7 Building, 2nd Floor
 Norwalk, CT 06851
 (800) 622-5850
 www.metsawood.com/us
 ICC-ES: ESR-3633

Comtech, Inc.
 1001 S. Reilly Road, Suite #639
 Fayetteville, NC
 USA
 28314
 910-864-TRUS



BM1 Kerto-S LVL 1.750" X 9.250" 2-Ply - PASSED

Level: Level

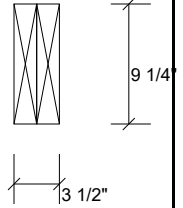
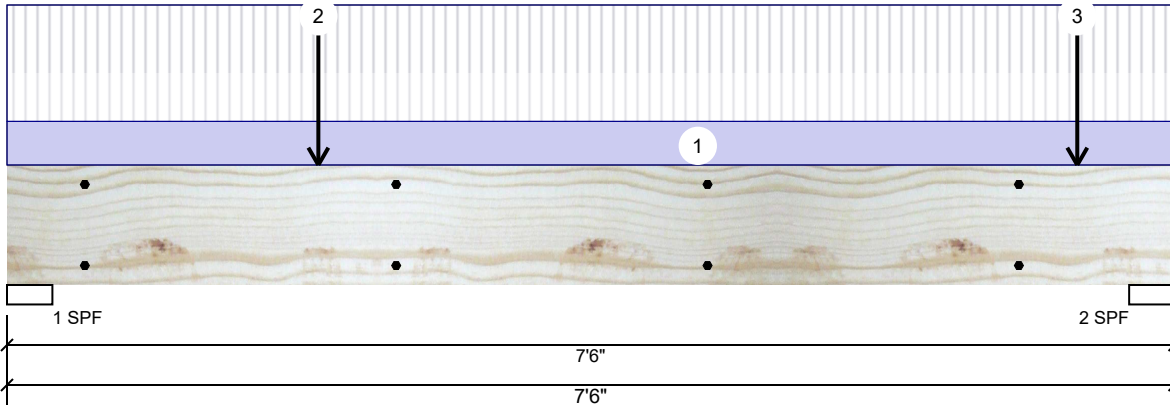

Member Information

Type:	Girder
Plies:	2
Moisture Condition:	Dry
Deflection LL:	360
Deflection TL:	240
Importance:	Normal
Temperature:	Temp <= 100°F

Application:	Floor
Design Method:	ASD
Building Code:	IBC 2012
Load Sharing:	No
Deck:	Not Checked

Reactions UNPATTERNED lb (Uplift)

Brg	Live	Dead	Snow	Wind	Const
1	150	959	876	0	0
2	150	1384	1300	0	0

Bearings

Bearing	Length	Cap. React D/L lb	Total Ld. Case	Ld. Comb.
1 - SPF	3.500"	35% 959 / 876	1834 L	D+S
2 - SPF	3.500"	52% 1384 / 1300	2684 L	D+S

Analysis Results

Analysis	Actual	Location	Allowed	Capacity	Comb.	Case
Moment	3204 ft-lb	2'	14423 ft-lb	0.222 (22%)	D+S	L
Unbraced	3204 ft-lb	2'	9592 ft-lb	0.334 (33%)	D+S	L
Shear	1812 lb	1'	7943 lb	0.228 (23%)	D+S	L
LL Defl inch	0.030 (L/2815)	3'4 1/16"	0.235 (L/360)	0.130 (13%)	S	L
TL Defl inch	0.063 (L/1338)	3'4 7/16"	0.352 (L/240)	0.180 (18%)	D+S	L

Design Notes

- Fasten all plies using 2 rows of SDW22338 at 24" o.c. Maximum end distance not to exceed 12".
- Refer to last page of calculations for fasteners required for specified loads.
- Simpson fasteners applied from a single side of the member use tip values where published.
- Girders are designed to be supported on the bottom edge only.
- Top loads must be supported equally by all plies.
- Top braced at bearings.
- Bottom braced at bearings.
- Lateral slenderness ratio based on single ply width.

ID	Load Type	Location	Trib Width	Side	Dead 0.9	Live 1	Snow 1.15	Wind 1.6	Const. 1.25	Comments
1	Uniform			Top	15 PLF	40 PLF	0 PLF	0 PLF	0 PLF	Floor
2	Point	2-0-0		Top	1088 lb	0 lb	1088 lb	0 lb	0 lb	A6
3	Point	6-10-8		Top	1088 lb	0 lb	1088 lb	0 lb	0 lb	A6
	Self Weight				7 PLF					

Notes
 Calculated Structured Designs is responsible only of the structural adequacy of this component based on the design criteria and loadings shown. It is the responsibility of the customer and/or the contractor to ensure the component suitability of the intended application, and to verify the dimensions and loads.

Lumber
 1. Dry service conditions, unless noted otherwise
 2. LVL not to be treated with fire retardant or corrosive chemicals

Handling & Installation
 1. LVL beams must not be cut or drilled
 2. Refer to manufacturer's product information regarding installation requirements, multi-ply fastening details, beam strength values, and code approvals
 3. Damaged Beams must not be used
 4. Design assumes top edge is laterally restrained
 5. Provide lateral support at bearing points to avoid lateral displacement and rotation

6. For flat roofs provide proper drainage to prevent ponding

This design is valid until 2/26/2023

Manufacturer Info
 Metsä Wood
 301 Merritt 7 Building, 2nd Floor
 Norwalk, CT 06851
 (800) 622-5850
 www.metsawood.com/us
 ICC-ES: ESR-3633

Comtech, Inc.
 1001 S. Reilly Road, Suite #639
 Fayetteville, NC
 USA
 28314
 910-864-TRUS

BM1 Kerto-S LVL 1.750" X 9.250" 2-Ply - PASSED

Level: Level

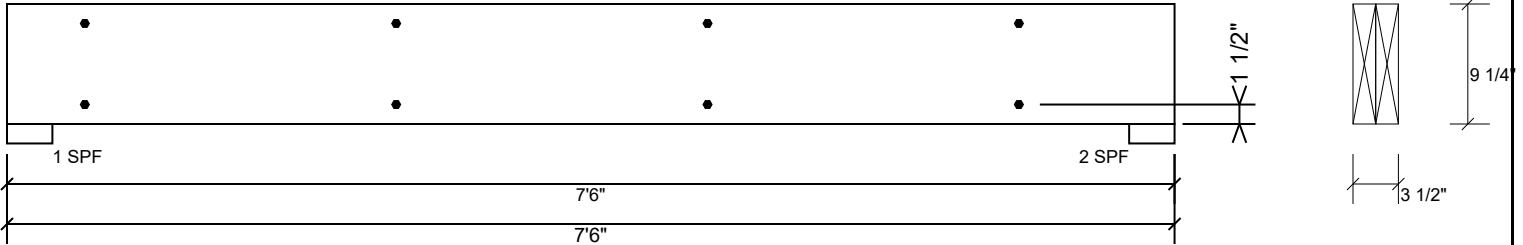

Multi-Ply Analysis

Fasten all plies using 2 rows of SDW22338 at 24" o.c.. Maximum end distance not to exceed 12"

Capacity	0.0 %
Load	0.0 PLF
Yield Limit per Foot	255.0 PLF
Yield Limit per Fastener	255.0 lb.
Yield Mode	Lookup
Edge Distance	1 1/2"
Min. End Distance	6"
Load Combination	
Duration Factor	1.00

Notes

Calculated Structured Designs is responsible only of the structural adequacy of this component based on the design criteria and loadings shown. It is the responsibility of the customer and/or the contractor to ensure the component suitability of the intended application, and to verify the dimensions and loads.

Lumber

1. Dry service conditions, unless noted otherwise
2. LVL not to be treated with fire retardant or corrosive

chemicals

Handling & Installation

1. LVL beams must not be cut or drilled
2. Refer to manufacturer's product information regarding installation requirements, multi-ply fastening details, beam strength values, and code approvals
3. Damaged Beams must not be used
4. Design assumes top edge is laterally restrained
5. Provide lateral support at bearing points to avoid lateral displacement and rotation

6. For flat roofs provide proper drainage to prevent ponding

This design is valid until 2/26/2023

Manufacturer Info

Metsä Wood
 301 Merritt 7 Building, 2nd Floor
 Norwalk, CT 06851
 (800) 622-5850
 www.metsawood.com/us
 ICC-ES: ESR-3633

Comtech, Inc.
 1001 S. Reilly Road, Suite #639
 Fayetteville, NC
 USA
 28314
 910-864-TRUS



BM2 Kerto-S LVL 1.750" X 9.250" 2-Ply - PASSED

Level: Level

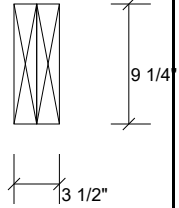
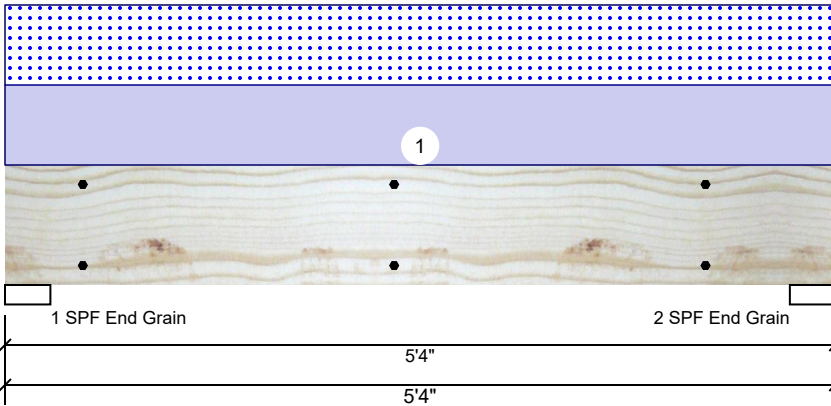

Member Information

Type:	Girder
Plies:	2
Moisture Condition:	Dry
Deflection LL:	360
Deflection TL:	240
Importance:	Normal
Temperature:	Temp <= 100°F

Application:	Floor
Design Method:	ASD
Building Code:	IBC 2012
Load Sharing:	No
Deck:	Not Checked

Reactions UNPATTERNED lb (Uplift)

Brg	Live	Dead	Snow	Wind	Const
1	0	1686	1667	0	0
2	0	1686	1667	0	0

Bearings

Bearing	Length	Cap. React	D/L lb	Total	Ld. Case	Ld. Comb.
1 - SPF End Grain	3.500"	31%	1686 / 1667	3353	L	D+S
2 - SPF End Grain	3.500"	31%	1686 / 1667	3353	L	D+S

Analysis Results

Analysis	Actual	Location	Allowed	Capacity	Comb.	Case
Moment	3735 ft-lb	2'8"	14423 ft-lb	0.259 (26%)	D+S	L
Unbraced	3735 ft-lb	2'8"	11811 ft-lb	0.316 (32%)	D+S	L
Shear	2095 lb	1'	7943 lb	0.264 (26%)	D+S	L
LL Defl inch	0.024 (L/2457)	2'8"	0.162 (L/360)	0.150 (15%)	S	L
TL Defl inch	0.048 (L/1221)	2'8"	0.244 (L/240)	0.200 (20%)	D+S	L

Design Notes

- 1 Fasten all plies using 2 rows of SDW22338 at 24" o.c. Maximum end distance not to exceed 12".
- 2 Refer to last page of calculations for fasteners required for specified loads.
- 3 Simpson fasteners applied from a single side of the member use tip values where published.
- 4 Girders are designed to be supported on the bottom edge only.
- 5 Top loads must be supported equally by all plies.
- 6 Top braced at bearings.
- 7 Bottom braced at bearings.
- 8 Lateral slenderness ratio based on single ply width.

ID	Load Type	Location	Trib Width	Side	Dead 0.9	Live 1	Snow 1.15	Wind 1.6	Const. 1.25	Comments
1	Uniform			Top	625 PLF	0 PLF	625 PLF	0 PLF	0 PLF	A2
	Self Weight				7 PLF					

Notes

Calculated Structured Designs is responsible only of the structural adequacy of this component based on the design criteria and loadings shown. It is the responsibility of the customer and/or the contractor to ensure the component suitability of the intended application, and to verify the dimensions and loads.

Lumber

1. Dry service conditions, unless noted otherwise
2. LVL not to be treated with fire retardant or corrosive

chemicals

Handling & Installation

1. LVL beams must not be cut or drilled
2. Refer to manufacturer's product information regarding installation requirements, multi-ply fastening details, beam strength values, and code approvals
3. Damaged Beams must not be used
4. Design assumes top edge is laterally restrained
5. Provide lateral support at bearing points to avoid lateral displacement and rotation

6. For flat roofs provide proper drainage to prevent ponding

This design is valid until 2/26/2023

Manufacturer Info

Metsä Wood
 301 Merritt 7 Building, 2nd Floor
 Norwalk, CT 06851
 (800) 622-5850
www.metsawood.com/us
 ICC-ES: ESR-3633

Comtech, Inc.
 1001 S. Reilly Road, Suite #639
 Fayetteville, NC
 USA
 28314
 910-864-TRUS



BM2 Kerto-S LVL 1.750" X 9.250" 2-Ply - PASSED

Level: Level

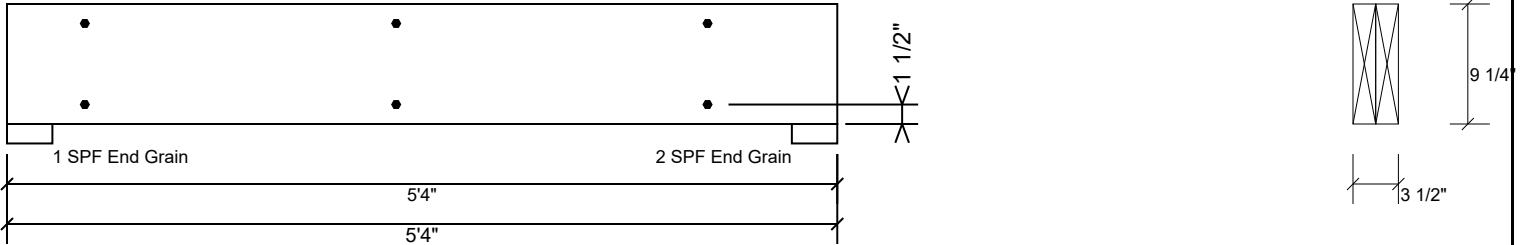

Multi-Ply Analysis

Fasten all plies using 2 rows of SDW22338 at 24" o.c.. Maximum end distance not to exceed 12"

Capacity	0.0 %
Load	0.0 PLF
Yield Limit per Foot	255.0 PLF
Yield Limit per Fastener	255.0 lb.
Yield Mode	Lookup
Edge Distance	1 1/2"
Min. End Distance	6"
Load Combination	
Duration Factor	1.00

Notes

Calculated Structured Designs is responsible only of the structural adequacy of this component based on the design criteria and loadings shown. It is the responsibility of the customer and/or the contractor to ensure the component suitability of the intended application, and to verify the dimensions and loads.

Lumber

1. Dry service conditions, unless noted otherwise
2. LVL not to be treated with fire retardant or corrosive

chemicals

Handling & Installation

1. LVL beams must not be cut or drilled
2. Refer to manufacturer's product information regarding installation requirements, multi-ply fastening details, beam strength values, and code approvals
3. Damaged Beams must not be used
4. Design assumes top edge is laterally restrained
5. Provide lateral support at bearing points to avoid lateral displacement and rotation

6. For flat roofs provide proper drainage to prevent ponding

This design is valid until 2/26/2023

Manufacturer Info

Metsä Wood
 301 Merritt 7 Building, 2nd Floor
 Norwalk, CT 06851
 (800) 622-5850
 www.metsawood.com/us
 ICC-ES: ESR-3633

Comtech, Inc.
 1001 S. Reilly Road, Suite #639
 Fayetteville, NC
 USA
 28314
 910-864-TRUS



BM3 Kerto-S LVL 1.750" X 9.250" 2-Ply - PASSED Level: Level

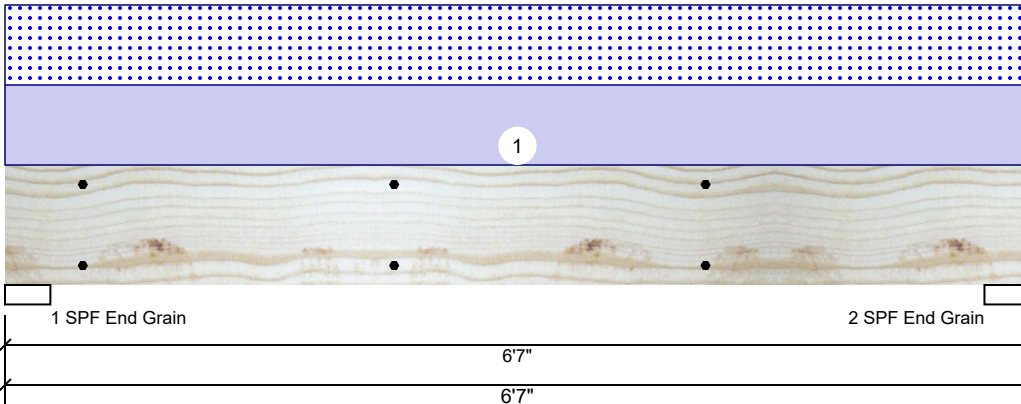

Member Information

Type:	Girder	Application:	Floor
Plies:	2	Design Method:	ASD
Moisture Condition:	Dry	Building Code:	IBC 2012
Deflection LL:	360	Load Sharing:	No
Deflection TL:	240	Deck:	Not Checked
Importance:	Normal		
Temperature:	Temp <= 100°F		

Reactions UNPATTERNED lb (Uplift)

Brg	Live	Dead	Snow	Wind	Const
1	0	2400	2377	0	0
2	0	2400	2377	0	0

Bearings

Bearing	Length	Cap. React	D/L lb	Total	Ld. Case	Ld. Comb.
1 - SPF End Grain	3.500"	45%	2400 / 2377	4777	L	D+S
2 - SPF End Grain	3.500"	45%	2400 / 2377	4777	L	D+S

Analysis Results

Analysis	Actual	Location	Allowed	Capacity	Comb.	Case
Moment	6805 ft-lb	3'3 1/2"	14423 ft-lb	0.472 (47%)	D+S	L
Unbraced	6805 ft-lb	3'3 1/2"	10451 ft-lb	0.651 (65%)	D+S	L
Shear	3326 lb	1'	7943 lb	0.419 (42%)	D+S	L
LL Defl inch	0.062 (L/1194)	3'3 1/2"	0.204 (L/360)	0.300 (30%)	S	L
TL Defl inch	0.124 (L/594)	3'3 1/2"	0.306 (L/240)	0.400 (40%)	D+S	L

Design Notes

- 1 Fasten all plies using 2 rows of SDW22338 at 24" o.c. Maximum end distance not to exceed 12".
- 2 Refer to last page of calculations for fasteners required for specified loads.
- 3 Simpson fasteners applied from a single side of the member use tip values where published.
- 4 Girders are designed to be supported on the bottom edge only.
- 5 Top loads must be supported equally by all plies.
- 6 Top braced at bearings.
- 7 Bottom braced at bearings.
- 8 Lateral slenderness ratio based on single ply width.

ID	Load Type	Location	Trib Width	Side	Dead 0.9	Live 1	Snow 1.15	Wind 1.6	Const. 1.25	Comments
1	Uniform			Top	722 PLF	0 PLF	722 PLF	0 PLF	0 PLF	A2
	Self Weight				7 PLF					

Notes

Calculated Structured Designs is responsible only of the structural adequacy of this component based on the design criteria and loadings shown. It is the responsibility of the customer and/or the contractor to ensure the component suitability of the intended application, and to verify the dimensions and loads.

Lumber

1. Dry service conditions, unless noted otherwise
2. LVL not to be treated with fire retardant or corrosive

chemicals

Handling & Installation

1. LVL beams must not be cut or drilled
2. Refer to manufacturer's product information regarding installation requirements, multi-ply fastening details, beam strength values, and code approvals
3. Damaged Beams must not be used
4. Design assumes top edge is laterally restrained
5. Provide lateral support at bearing points to avoid lateral displacement and rotation

6. For flat roofs provide proper drainage to prevent ponding

This design is valid until 2/26/2023

Manufacturer Info

Metsä Wood
 301 Merritt 7 Building, 2nd Floor
 Norwalk, CT 06851
 (800) 622-5850
www.metsawood.com/us
 ICC-ES: ESR-3633

Comtech, Inc.
 1001 S. Reilly Road, Suite #639
 Fayetteville, NC
 USA
 28314
 910-864-TRUS



BM3 Kerto-S LVL 1.750" X 9.250" 2-Ply - PASSED

Level: Level

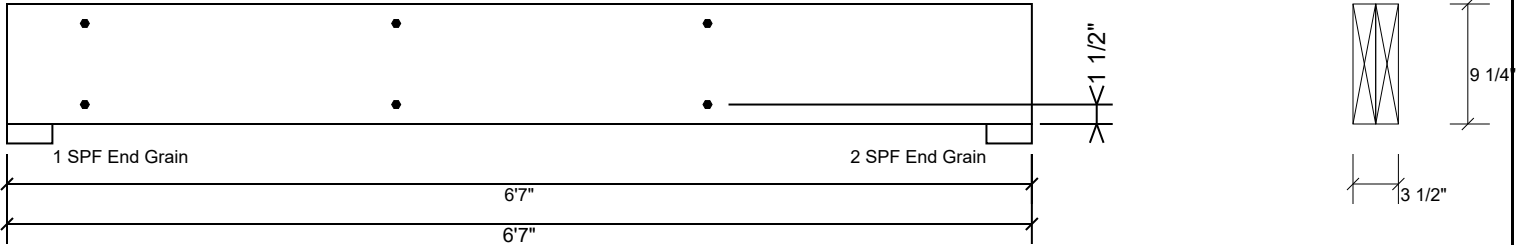

Multi-Ply Analysis

Fasten all plies using 2 rows of SDW22338 at 24" o.c.. Maximum end distance not to exceed 12"

Capacity	0.0 %
Load	0.0 PLF
Yield Limit per Foot	255.0 PLF
Yield Limit per Fastener	255.0 lb.
Yield Mode	Lookup
Edge Distance	1 1/2"
Min. End Distance	6"
Load Combination	
Duration Factor	1.00

Notes

Calculated Structured Designs is responsible only of the structural adequacy of this component based on the design criteria and loadings shown. It is the responsibility of the customer and/or the contractor to ensure the component suitability of the intended application, and to verify the dimensions and loads.

Lumber

1. Dry service conditions, unless noted otherwise
2. LVL not to be treated with fire retardant or corrosive

chemicals

Handling & Installation

1. LVL beams must not be cut or drilled
2. Refer to manufacturer's product information regarding installation requirements, multi-ply fastening details, beam strength values, and code approvals
3. Damaged Beams must not be used
4. Design assumes top edge is laterally restrained
5. Provide lateral support at bearing points to avoid lateral displacement and rotation

6. For flat roofs provide proper drainage to prevent ponding

This design is valid until 2/26/2023

Manufacturer Info

Metsä Wood
 301 Merritt 7 Building, 2nd Floor
 Norwalk, CT 06851
 (800) 622-5850
 www.metsawood.com/us
 ICC-ES: ESR-3633

Comtech, Inc.
 1001 S. Reilly Road, Suite #639
 Fayetteville, NC
 USA
 28314
 910-864-TRUS

